

M12 female receptacle A-cod. front mount incl. nut

wires 8x0.25 0,5m

Flange M12 female
8-pole
Front mounting
Mounting nut
with multi-strand wire

[Link to Product](#)**Illustration**

| | | |
|---|---|--------|
| 1 | ⌋ | white |
| 2 | ⌋ | brown |
| 3 | ⌋ | green |
| 4 | ⌋ | yellow |
| 5 | ⌋ | gray |
| 6 | ⌋ | pink |
| 7 | ⌋ | blue |
| 8 | ⌋ | red |

Female

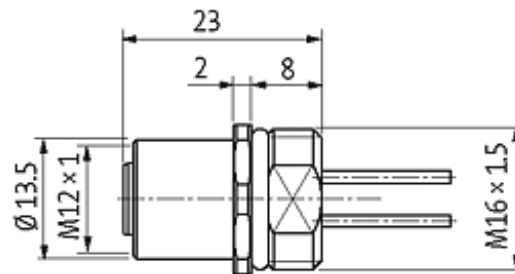
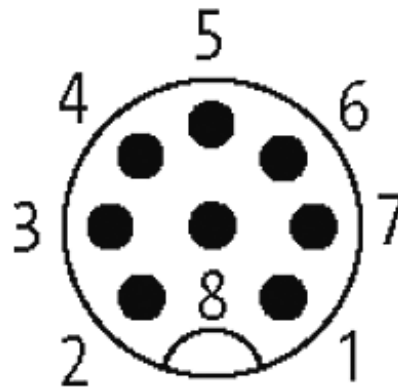

Product may differ from Image

Form

17182

Technical Data

| | |
|-------------------------------|-------------------------------------------------------------------|
| Operating voltage | max. 60 V AC/DC |
| Operating current per contact | max. 2 A |
| Locking of ports | Screw thread M12 × 1 mm (recommended torque 0.6 Nm) self-securing |
| Protection | IP67 inserted and tightened (EN 60529) |

Cables

| | |
|-----------------------------|-------------------------------------|
| Cable number | 973 |
| No./diameter of wires | 8 × 0.25 mm ² |
| Wire isolation | PP (wh, br, gn, ye, gr, pk, bl, rd) |
| C-track properties | 2 Mio. |
| Shore hardness outer jacket | 75 ± 5A |
| Outer diameter | approx. 1.25 mm |
| Bend radius (fixed) | 10 × outer Ø |
| Bend radius (moving) | 15 × outer Ø |
| Temperature range (fixed) | -40...+80 °C |
| Temperature range (mobile) | -20...+80 °C |

Commercial data

minimum order quantity

1