

# IZ5046

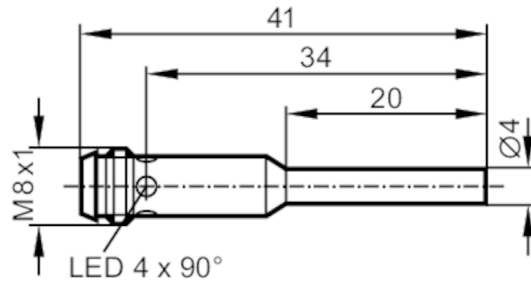

## Inductive sensor

IZB31,5-BPKG/AS-514-TPS



### Product characteristics

Electrical design		PNP
Output function		normally open
Sensing range	[mm]	1.5
Housing		cylindrical
Dimensions	[mm]	Ø 4 / L = 41

### Electrical data

Operating voltage	[V]	10...30 DC
Current consumption	[mA]	10; (24 V)
Reverse polarity protection		yes

### Outputs

Electrical design		PNP
Output function		normally open
Max. voltage drop switching output DC	[V]	3
Permanent current rating of switching output DC	[mA]	100
Switching frequency DC	[Hz]	1800
Short-circuit protection		yes
Type of short-circuit protection		pulsed
Overload protection		yes

### Detection zone

Sensing range	[mm]	1.5
Real sensing range Sr	[mm]	1.5 ± 10 %
Operating distance	[mm]	0...1.2

### Accuracy / deviations

Correction factor		steel: 1 / stainless steel: 0.7 / brass: 0.5 / aluminium: 0.4 / copper: 0.3
Hysteresis	[% of Sr]	< 15
Switch point drift	[% of Sr]	-10...10

### Operating conditions

Ambient temperature	[°C]	-25...80
Protection		IP 67

# IZ5046



## Inductive sensor

IZB31,5-BPKG/AS-514-TPS

Tests / approvals		
EMC	EN 60947-5-2	
	EN 55011	class B
MTTF	[years]	835
UL approval	Ta	0...40 °C
	voltage supply	Class 2
	File number UL	E174191

Mechanical data		
Weight	[g]	19
Housing		cylindrical
Mounting		non-flush mountable
Dimensions	[mm]	Ø 4 / L = 41
Materials		housing: stainless steel; sensing face: POM

Displays / operating elements		
Display	switching status	4 x 90° LED, red

Accessories		
Accessories (supplied)		Mounting clamps: 1

Remarks		
Pack quantity		1 pcs.

### Electrical connection - plug

Connector: 1 x M8

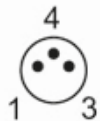

### Connection

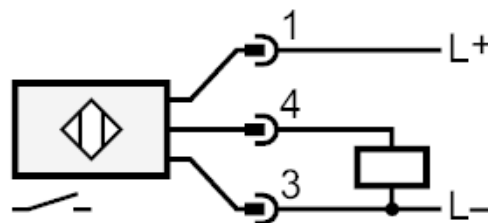

# IZ5046



## Inductive sensor

IZB31,5-BPKG/AS-514-TPS

### Diagrams and graphs

#### Installation

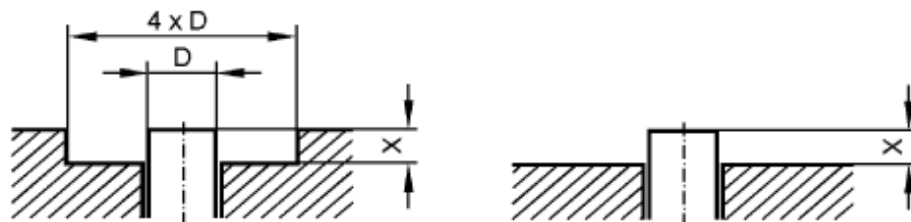

If  $S_r$  varies by  $< 10\%$  the following free space must be maintained ferromagnetic materials  $X > 1.5$  mm other metals  $X > 3.0$  mm