

REV.	DATE	DESCRIPTION
NC	05/01/04	INITIAL RELEASE
A	06/09/06	REMOVE "BULKHEAD" FROM PART DESCRIPTION

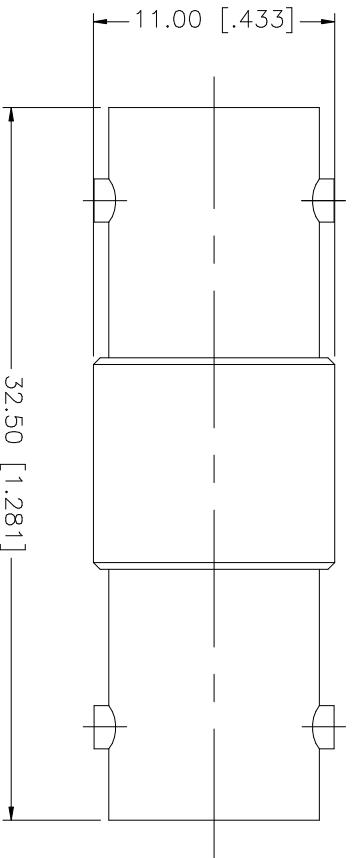

QTY	FINISH	MATERIAL	DESCRIPTION
1	GOLD	PHOS. BRONZE	CONTACT PIN
1	NATURAL	DELFIN	INSULATOR
1	NICKEL	BRASS	BODY
			DESCRIPTION

UNLESS OTHERWISE SPECIFIED DIMENSIONS ARE IN INCHES AND FOR CUSTOMER REFERENCE ONLY.		UNLESS OTHERWISE SPECIFIED DIMENSIONS ARE IN MILLIMETERS AND FOR CUSTOMER REFERENCE ONLY.	
TOLERANCES FOR MILLIMETERS ARE:		TOLERANCES FOR INCHES ARE:	
0.3 - 8mm	± 0.20mm	.315 - .315	± 0.007"
8 - 30mm	± 0.40mm	1.180 - 1.180	± 0.015"
30 - 120mm	± 0.50mm	1.180 - 4.724	± 0.020"
UNLESS OTHERWISE SPECIFIED DIMENSIONS ARE IN MILLIMETERS AND FOR CUSTOMER REFERENCE ONLY.		UNLESS OTHERWISE SPECIFIED DIMENSIONS ARE IN INCHES AND FOR CUSTOMER REFERENCE ONLY.	
TOLERANCES FOR MILLIMETERS ARE:		TOLERANCES FOR INCHES ARE:	
0.3 - 8mm	± 0.20mm	.315 - .315	± 0.007"
8 - 30mm	± 0.40mm	1.180 - 1.180	± 0.015"
30 - 120mm	± 0.50mm	1.180 - 4.724	± 0.020"

APPROVALS	DATE	PART DESCRIPTION	
DRAWN G.R.S.	06/09/06	BNC FEMALE TO FEMALE ADAPTER	
CHECKED		PART NO. 112445	
ISSUED		PART NO. 112445	
SHEET 1 OF 1		PART NO. 112445	

CAD FILE C:/112/112445.DWG	DWG. NO. 112445.DWG	REV. A	SIZE A	SCALE NA
----------------------------	---------------------	--------	--------	----------