



### Model Number

921LC2

### Features

- Basic series
- 2 mm flush

## Technical Data

### General specifications

|                            |       |               |
|----------------------------|-------|---------------|
| Switching element function |       | NAMUR, NC     |
| Rated operating distance   | $s_n$ | 2 mm          |
| Installation               |       | flush         |
| Assured operating distance | $s_a$ | 0 ... 1.62 mm |

### Nominal ratings

|                              |       |               |
|------------------------------|-------|---------------|
| Nominal voltage              | $U_o$ | 8.2 V         |
| Operating voltage            | $U_B$ | 5 ... 15 V    |
| Switching frequency          | f     | 0 ... 1000 Hz |
| Current consumption          |       |               |
| Measuring plate not detected |       | $\geq 2.7$ mA |
| Measuring plate detected     |       | $\leq 1.8$ mA |

### Ambient conditions

|                     |                               |
|---------------------|-------------------------------|
| Ambient temperature | -10 ... 65 °C (14 ... 149 °F) |
|---------------------|-------------------------------|

### Mechanical specifications

|                      |                   |
|----------------------|-------------------|
| Connection type      | Solder connection |
| Housing material     | PA                |
| Sensing face         | PA                |
| Degree of protection | IP67              |

### Compliance with standards and directives

|                     |   |
|---------------------|---|
| Standard conformity |   |
| NAMUR               | EN 60947-5-6:2000                       |
| Standards           | EN 60947-5-2:2007<br>IEC 60947-5-2:2007 |

### Approvals and certificates

|              |  |
|--------------|--|
| CCC approval | CCC approval / marking not required for products rated $\leq 36$ V |
|--------------|--|

## Dimensions

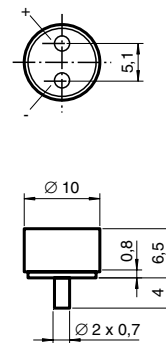

## Electrical Connection

