

To : Valued Customer
From : Littelfuse Product Management

Subject : Enhanced performance of 242 Fuse Series

With regards to the above reference, Littelfuse has enhanced the robustness of our 242 Fuse Series by adding a silver ring on the fuse body which will enhance the connection between the cap and the body.

What has change?

Below picture shows the before and after comparison.

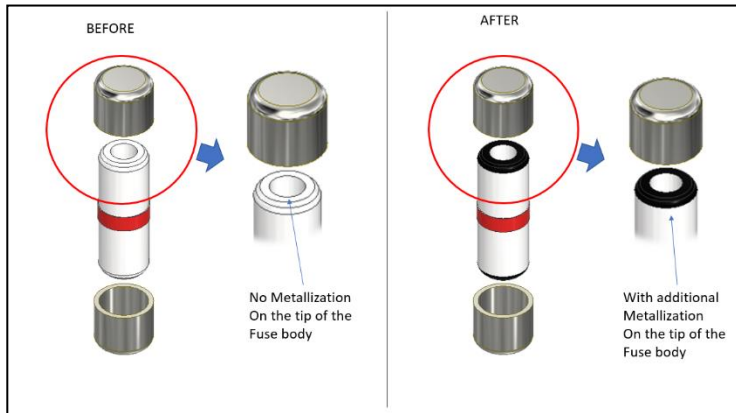

1. What is maintained?

- a. Fuse part number.
- b. Electrical Characteristics.
- c. Fuse Resistance value.
- d. Fuse Dimension.
- e. Agency Certificate Number.

2. When is the target implementation? This will be a running change and the target implementation date is on January 10, 2022.

Note: All samples request after November 1, 2021 will use the new fuse design.

Best regards,
Daniel Wang
Director Global Product Management
Littelfuse Philippines Inc,
DWang@littelfuse.com



Affected Part Number List

0242.040UR
0242.050HAT1
0242.050UAT1
0242.050UR
0242.050URF
0242.050URS
0242.080HAT1
0242.080UAT1
0242.080UR
0242.080URF
0242.100HAT1
0242.100UA851
0242.100UAT1
0242.100UR
0242.100UR850S
0242.125UAT1
0242.125UR
0242.160HAT1
0242.160UAT1
0242.160UR
0242.200HAT1
0242.200UAT1
0242.200UR
0242.250HAT1
0242.250UAT1
0242.250UR

