

# Pin Pluggable Terminal Block Clamp Terminals/ Screw ConnectionP

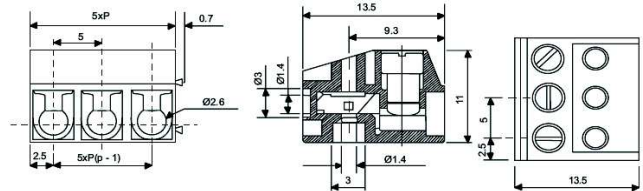

Pluggable Terminal Blocks, 5 mm Pitch, RND



## FEATURES:

- 2 & 3 pole interlocking
- Wire protector terminals
- Withstand Voltage - AC1500V/1min
- Tin plated brass terminal
- Tin plated copper wire protector
- Screw/Torque - M2.5 Steel, Nickel Plated 0.4Nm
- Guided pin alignment

## SPECIFICATION:

Gender of contacts	Male
Rated current to EN	10 A
Pitch	5 mm
Termination type	Clamp Terminals/Screw Connection
Connection direction	vertical or 90°
Rated voltage to EN	250 V
Connection cross-section	0.33-2 mm <sup>2</sup> (22-14AWG)
Colour	black
Temperature range	-33...+120 °C

## PRODUCT RANGE:

Art. Nr.	Poles
RND 205-00210	2
RND 205-00211	3
RND 205-00212	4
RND 205-00213	5
RND 205-00214	6
RND 205-00216	8
RND 205-00217	9

## Pin header

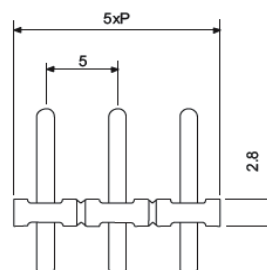

TYPE 205 series

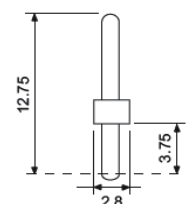

## SPECIFICATION:

RND 205-00554	Rated current to EN	10 A
	Pitch	5 mm
	Rated voltage to EN	250 V
	Connection cross-section	0.33-2 mm <sup>2</sup> (22-14AWG)
	Recommended PCB hole Size	1.6 mm
	Temperature range	-33...+120 °C
	Poles	24 , cuttable