

DI5034

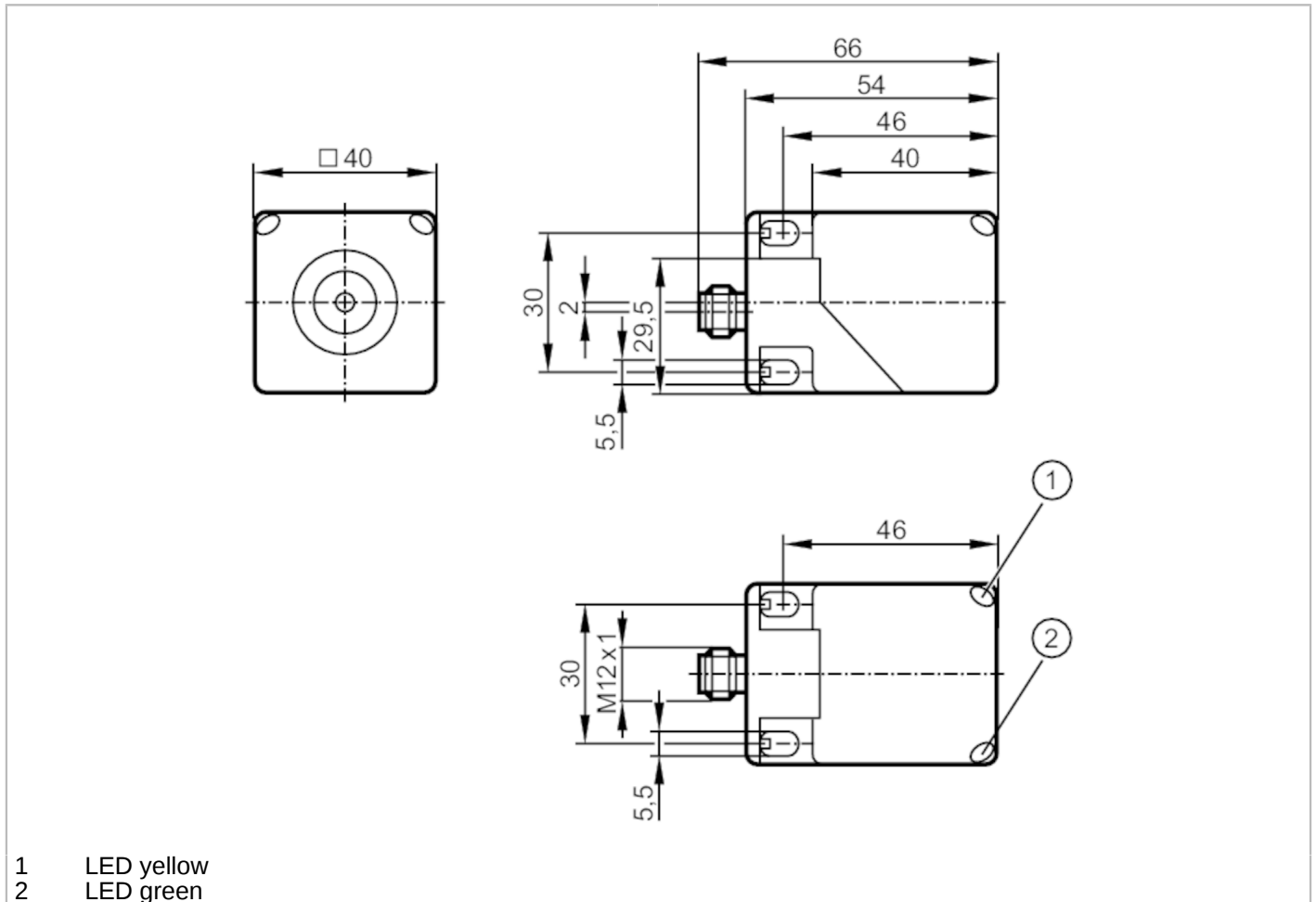

Compact evaluation unit for speed monitoring

DMC3024-WRKG/IO/US



Product characteristics	
Electrical design	PNP/NPN
Output function	normally open / normally closed; (parameterisable)
Sensing range [mm]	24
Communication interface	IO-Link
Housing	rectangular
Dimensions [mm]	40 x 40 x 54
Application	
Application	simple evaluation of rotating and linear movement with regard to underspeed; blocking
Electrical data	
Nominal voltage DC [V]	10...30
Current consumption [mA]	< 10
Protection class	III
Reverse polarity protection	yes

DI5034



Compact evaluation unit for speed monitoring

DMC3024-WRKG/IO/US

Outputs		
Electrical design	PNP/NPN	
Output function	normally open / normally closed; (parameterisable)	
Max. voltage drop switching output DC [V]	2.5	
Permanent current rating of switching output DC [mA]	100	
Short-circuit proof	yes	
Overload protection	yes	
Detection zone		
Sensing range [mm]	24	
Sensing range adjustable	no	
Operating distance [mm]	0...19.44	
Measuring/setting range		
Setting range [Imp/min]	5...9600	
Accuracy / deviations		
Correction factor	steel: 1 / stainless steel: 0.7 / brass: 0.5 / aluminium: 0.4 / copper: 0.3	
Hysteresis [% of Sr]	10	
Response times		
Start-up delay [s]	0...30; (In steps of: 100 ms; Default: 15 s)	
Max. damping frequency [Imp/min]	12000	
Interfaces		
Communication interface	IO-Link	
Operating conditions		
Ambient temperature [°C]	-40...85	
Storage temperature [°C]	-25...85	
Protection	IP 67	
Tests / approvals		
EMC	EN 61000-4-2 ESD	4 kV CD / 8 kV AD
	EN 61000-4-3 HF radiated	10 V/m
	EN 61000-4-4 Burst	2 kV
	EN 61000-4-6 HF conducted	10 V
	EN 55011	class B
MTTF [years]	EN 60947-5-2	636
UL approval	UL Approval no.	A009
Mechanical data		
Weight [g]	182	
Housing	rectangular	
Mounting	non-flush mountable	
Dimensions [mm]	40 x 40 x 54	
Materials	PA; connector thread: brass white bronze coated	

DI5034



Compact evaluation unit for speed monitoring

DMC3024-WRKG/IO/US

Displays / operating elements

Display	operation	LED, green
	SIO mode	
	output stage supplied with current	4 x LED, yellow
	IO-Link mode	
	target in measuring range	4 x LED, yellow
	target outside measuring range	4 x LED, yellow flashing

Electrical connection

Connector: 1 x M12



Connection

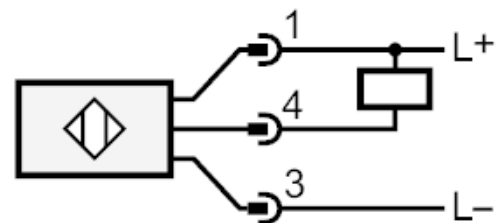
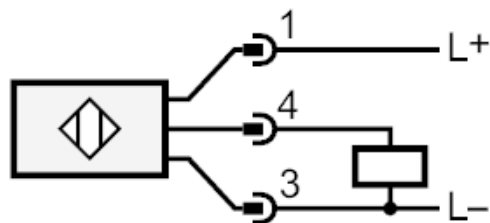

4: OUT / IO-Link