

REV.	DATE	DESCRIPTION
NC	06/06/04	INITIAL RELEASE

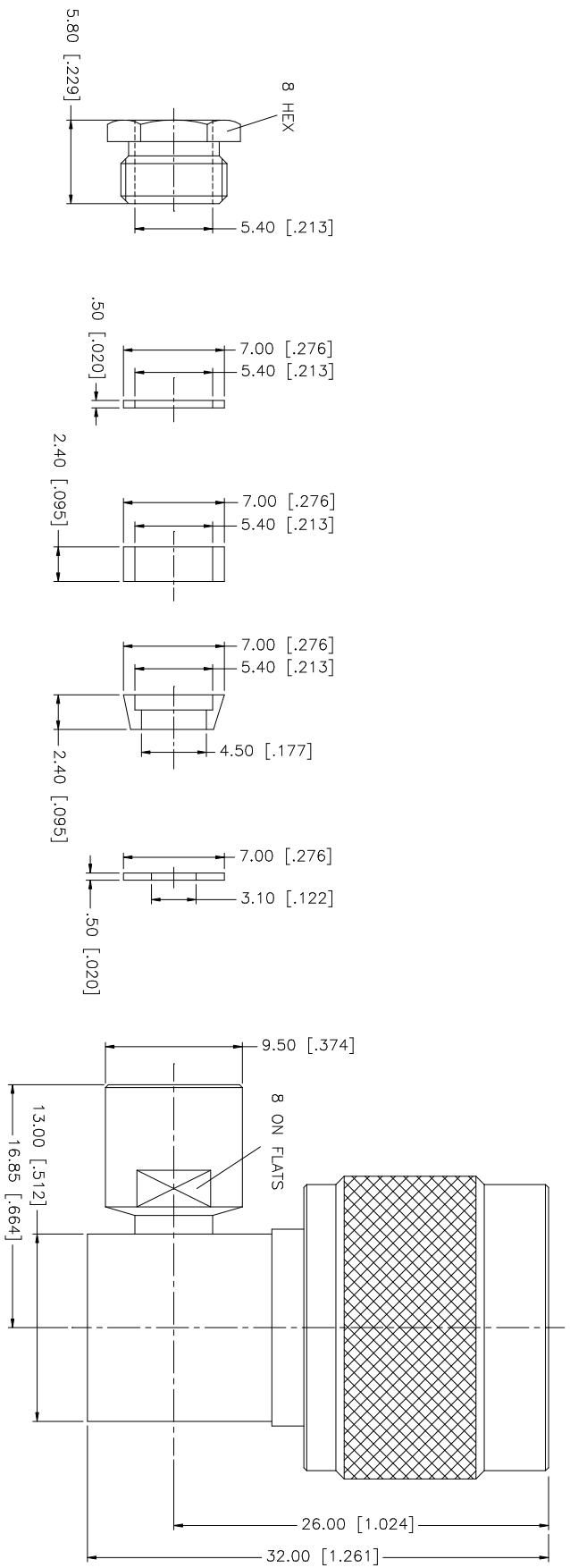

NOTE:
1. CONTACT PIN TO SOLDER

8	NUT	BRASS	NEXCOTE	1	<small>UNLESS OTHERWISE SPECIFIED DIMENSIONS ARE IN MILLIMETERS. DIMENSIONS IN [] ARE IN INCHES AND FOR CUSTOMER REFERENCE ONLY.</small> <small>UNLESS OTHERWISE SPECIFIED TOLERANCES FOR MILLIMETERS ARE:</small> 0.5 - 8mm ± 0.20mm 8 - 30mm ± 0.40mm 30 - 120mm ± 0.50mm <small>UNLESS OTHERWISE SPECIFIED TOLERANCES FOR INCHES ARE:</small> .020 - .315 = ± 0.007" .315 - 1.180 = ± 0.015" 1.180 - 4.724 = ± 0.020"	<small>DO NOT SCALE DRAWING</small>	APPROVALS DRAWN G.R.S. CHECKED ISSUED SHEET 1 OF 1	DATE 06/06/04	PART DESCRIPTION N R/A CLAMP PLUG (FOR RG58C/U, 58/U, 142A/U, 223/U) PART NO. 172316
7	END CAP/ HEX NUT	BRASS	NEXCOTE	1					
6	WASHER	BRASS	NEXCOTE	1					
5	GASKET	SILICONE	RED	1					
4	WASHER	BRASS	NEXCOTE	1					
3	CONTACT PIN	BRASS	GOLD	1					
2	INSULATOR	TEFLON	NATURAL	1					
1	SHELL/BODY	BRASS	NEXCOTE	1					
DESCRIPTION		MATERIAL	FINISH	QTY	CAD FILE	DWG. NO.	REV.	SIZE	SCALE
					C:/172/172316.DWG	172316.DWG	NC	A	NA

Amphenol Connex