

BES M18MI-NSC80B-BV03

Inductive Sensors

NPN
NO
flush mountable

BALLUFF

sensors worldwide

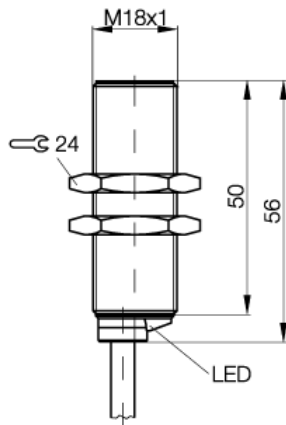

PX0268

Electrical data:

Connection	cable
Rated operational voltage (Ue)	24 DC V
Load current capacity (Ie)	200 mA
Time delay before availability	30 ms
Electrical type	DC
Utilization category	DC 13
Hysteresis max (H)	15 %
No-load supply current damped	15 mA
Off-state current max (Ir)	20 µA
Ripple max. of Ue	15 %
Switching output	NPN
Switching element function	NO
Operating frequency (f)	150 Hz
Voltage drop max. static	2,5 V
Supply voltage max. (Ub)	30 V
Supply voltage min. (Ub)	12 V

Mechanical data:

Number of wires	3-wire
Tightening torque	25 Nm
Rated operating distance (sn)	8 mm
Diameter	M18x1 mm
Assured operating distance	0...6,4 mm
Cable code designation	LiYY-O
Mounting	flush mountable
Ambient temperature max	+70 °C
Ambient temperature min	-25 °C
Degree of pollution	3
Sensing face material	PA 12
Housing material	CuZn, nickel plated
Repeat accuracy max. (R)	= 5 %

General data:

Output indication	yes
Short circuit protected	yes
Insulation class	2
Protected against polarity reversal	yes
Approval	CE,c_ul_us

wiring

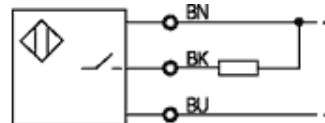

www.balluff.com

Balluff Europe: +49 7158 173 -0
Balluff USA: 1-800-54 3-83 90
Balluff Asia: +86 21-50 64 41 31

Online Productinformation
2008-02-15