

THIS DRAWING IS UNPUBLISHED. RELEASED FOR PUBLICATION ,19 .
 © COPYRIGHT 19 BY AMP INCORPORATED. ALL RIGHTS RESERVED.

LOC	DIST	REVISIONS				
P	LTR	DESCRIPTION	DATE	DWN	APVD	
BD	35	0	RLSE -1 & -2 PER NPR 5375, WAS 95-7970-16	07/12/95	-	-

#5-20 SELF TAPPING SCREW
QTY=2

△3 CABLE CLAMP INSERT

CABLE CLAMP BODY

15.75⁰_{-1.27}
 [.620^{+0.000}_{-.050}]

- △1 CABLE CLAMP BODY AND INSERTS: NYLON, BLACK. SCREWS: CARBON STEEL.
- △2 SCREWS: ZINC.
- △3 CABLE CLAMPING AREA ADJUSTABLE FROM 2.54 [.100] TO 10.41 [.410] SQ AREA BY REVERSING OR CHANGING CLAMPING INSERTS.
- △4 17.86 [.703] MAXIMUM CABLE OUTSIDE DIAMETER.

42.04±0.76
[1.655±.030]

CABLE SUPPLIED BY CUSTOMER △4

28.73±0.64 DIA
[1.131±.025]

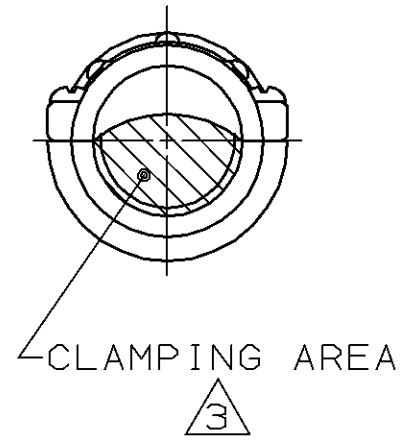

ASSEMBLED VIEW

BULK	213902-2
INDIVIDUAL	213902-1
PACKAGING	PART NUMBER

THIS DRAWING IS A CONTROLLED DOCUMENT FOR AMP INCORPORATED. IT IS SUBJECT TO CHANGE AND THE CONTROLLING ENGINEERING ORGANIZATION SHOULD BE CONTACTED FOR THE LATEST REVISION.		DWN D. HARDY 07/12/95	AMP AMP Incorporated Harrisburg, PA 17105-3608
DIMENSIONS: mm [INCHES]		CHK R. STONE 07/13/95	
TOLERANCES UNLESS OTHERWISE SPECIFIED:		APVD A. FRANTUM 07/13/95	NAME CABLE CLAMP KIT, LARGE, UNASSEMBLED, SIZE 17, CPC
0 PLC ±-		PRODUCT SPEC 108-1579	SIZE A3
1 PLC ±-		APPLICATION SPEC	CAGE CODE 00779
2 PLC ±-		WEIGHT -	DRAWING NO C-213902
3 PLC ±-		CUSTOMER DRAWING	SCALE 1:1
4 PLC ±-			SHEET 1 OF 1
ANGLES ±-			REV 0
MATERIAL △1	FINISH △2		