

REV.	DATE	DESCRIPTION
A	06/05/03	UPDATE DRAWING FORMAT

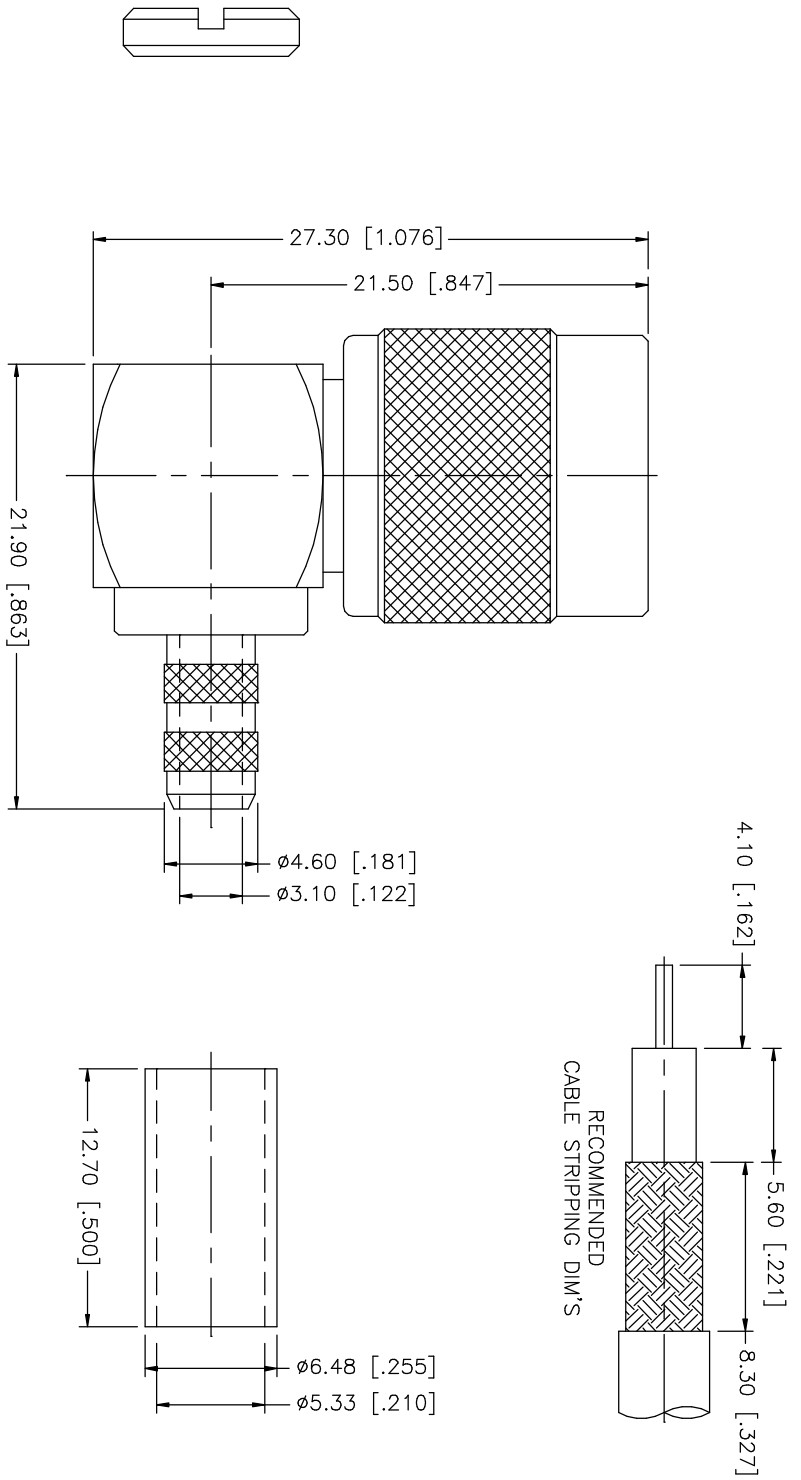

NO.	DESCRIPTION	MATERIAL	FINISH	QTY	UNLESS OTHERWISE SPECIFIED DIMENSIONS ARE IN INCHES AND FOR CUSTOMER REFERENCE ONLY. TOLERANCES FOR MILLIMETERS ARE: UNLESS OTHERWISE SPECIFIED 0.5 - 8mm ± 0.20mm 8 - 30mm ± 0.40mm 30 - 120mm ± 0.50mm	UNLESS OTHERWISE SPECIFIED DIMENSIONS ARE IN INCHES AND FOR CUSTOMER REFERENCE ONLY. TOLERANCES FOR MILLIMETERS ARE: UNLESS OTHERWISE SPECIFIED .020 - .315 = ± 0.007" .315 - 1.180 = ± 0.015" 1.180 - 4.724 = ± 0.020"	DO NOT SCALE DRAWING	CAD FILE	APPROVALS	DATE	PART DESCRIPTION	
8									DRAWN	G.R.S.	06/05/03	<b>Amphenol Connex</b> TNC R/A CRIMP PLUG (FOR RG-58/u, 58C/u, 141/u CABLE)
7									CHECKED			
6									ISSUED			
5	NUT	BRASS	NICKEL	1					SHEET	1 OF 1		
4	FERRULE	COPPER	NICKEL	1								
3	CONTACT PIN	BRASS	GOLD	1								
2	INSULATOR	DELRI	NATURAL	1								
1	BODY	BRASS	NICKEL	1								
	DESCRIPTION	MATERIAL	FINISH	QTY				DWG. NO.	REV.	SIZE	SCALE	
								C:/122/122140.DWG	A	A	NA	