

# Switch Probes

www.feinmetall.com

Centers 2,54 mm/100 mil

Type	Switch Travel	Temperature
F875	1,5 mm	-20°...+80°C

## Switch Probe (NO) for Presence Testing

### F875



The F875 is screwed into the corresponding receptacle to prevent ejection and to adjust variable projection heights. For solder free replacement use receptacle H875KB or H875KB/5.

#### Mechanical Specifications

Switch Travel: 1,5 ± 0,2 mm  
 Working Travel: 4,0 mm  
 Full Travel: 5,0 mm

Preload (cN):	20	30	60
Spring Force (cN) at Working Travel: (±20%)	80	135	200
Preload (cN):	60	80	
Spring Force (cN) at Working Travel: (±20%)	300	350	

Pointing Accuracy: ±0,08 mm

#### Electrical Specifications

Maximum switching current: 1,0 A  
 Maximum continuous current: 5,0 A  
 Typical switch resistance: 65 mOhm

#### Materials and Finishes

Plunger: Beryllium copper (BeCu), Gold plated / Synthetic unplated  
 Barrel: Brass, Gold plated  
 Spring: Music wire, Silver plated  
 Receptacle: Brass, Gold plated

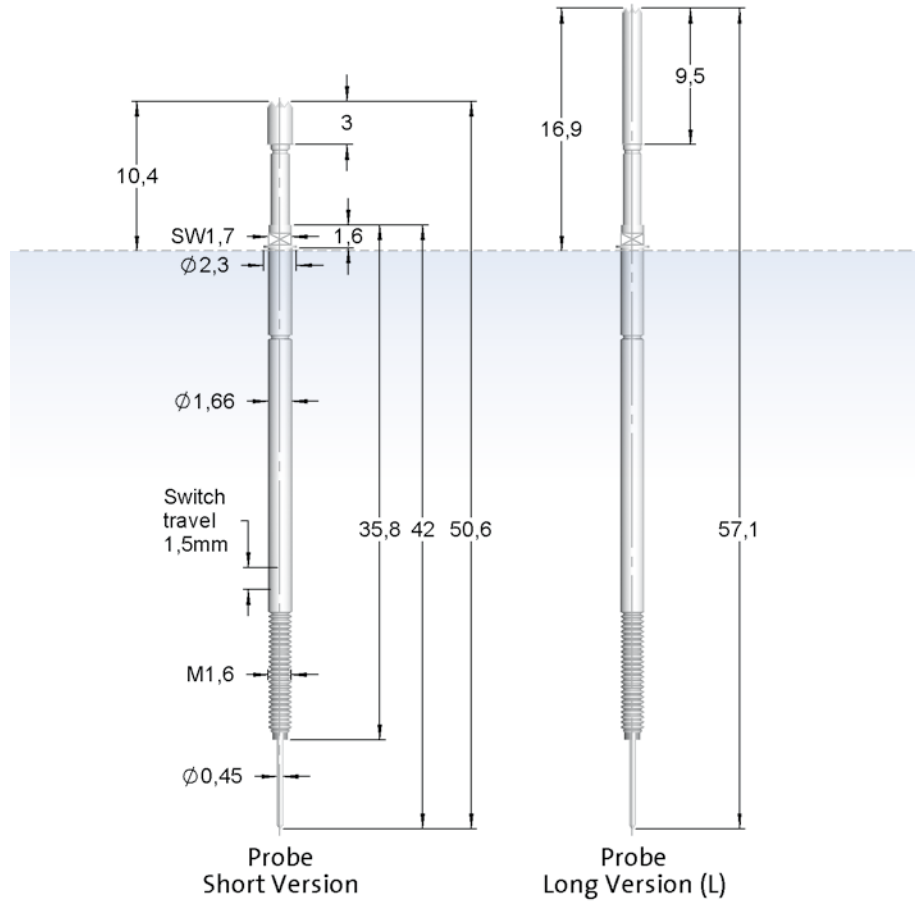

Projection Height	H875/H875KB	H875IS*	H875/5	H875KB/5
Standard Version	10,4 - 15,4 mm	10,6 - 15,6 mm	15,2 - 20,2 mm	15,2 - 20,2 mm
Long Version	16,9 - 21,9 mm	17,1 - 22,1 mm	21,7 - 26,7 mm	21,7 - 26,7 mm

\*in combination with H875 / H875KB All available receptacles on page 47

**Switch Insulator:**  
 Synthetic Material  
 (maximum 300°C)

#### Plunger Tip Style, Material, Finish and Tip Diameter (mm)



<b>05 BeCu; G</b> ø 1,8	<b>06 BeCu; G</b> ø 1,3 / 1,5 / 1,8 / 2,0 / 2,3	<b>06 BeCu; G</b> L-Version ø 1,0 / 1,4 / 1,8	<b>11 BeCu; G</b> ø 0,64 / 1,0	<b>11 BeCu; G</b> L-Version ø 1,0
----------------------------	----------------------------------------------------	-----------------------------------------------------	-----------------------------------	-----------------------------------------



<b>16 BeCu; G</b> ø 0,64 / 0,7 / 0,8 / 1,0	<b>16 BeCu; G</b> L-Version ø 1,0	<b>17 BeCu; G</b> ø 1,8	<b>17 Synthetic; U</b> ø 1,8 / 2,3	
-----------------------------------------------	-----------------------------------------	----------------------------	---------------------------------------	--

Type	Tip Diameter	Spring Force	
F875	06B 180	G 135 L	
Tip Style	Material	Finish	
		Length	
<b>Material:</b>	B = BeCu, K = Synthetic		
<b>Tip Diameter:</b>	1,80 mm = 180 (e.g.)		
<b>Finish:</b>	G = Gold plated, U = Unplated		
<b>Length:</b>	L = Long Version		
<b>Receptacle:</b>	Order Number see list Projection Height		
<b>ORDER EXAMPLE</b>			

## Receptacles for Switch Probes Series F875 and F873 H875

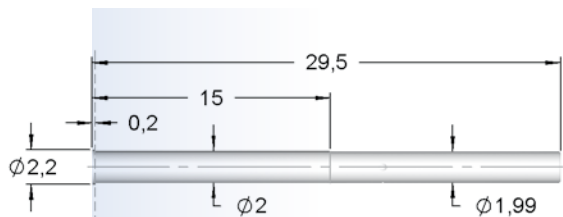

Receptacle  
H875

### Standard Receptacle H875

This receptacle in combination with F875 or F873 allows adjustable range of projection height.

#### Projection Height:

Standard Version: 10,4 - 15,4 mm  
Long Version (L): 16,9 - 21,9 mm

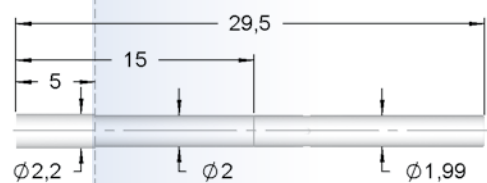

Receptacle  
H875/5

### Standard Receptacle H875/5

The receptacle H875/5 can be used, if a greater projection height is needed than it is viable with the H875.

#### Projection Height:

Standard Version: 15,2 - 20,2 mm  
Long Version (L): 21,7 - 26,7 mm

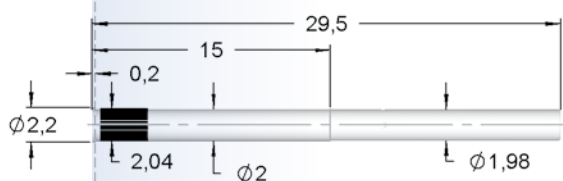

Receptacle  
H875RD

### Knurled Receptacle H875RD

H875RD is compatible to H875 but knurled for a secure fitting.

#### Projection Height:

Standard Version: 10,4 - 15,4 mm  
Long Version (L): 16,9 - 21,9 mm

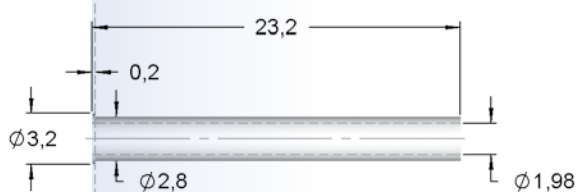

Receptacle  
H875IS

### Insulating Receptacle H875IS

The insulating receptacle H875IS allows applications (in combination with receptacles H875 or H875KB optional also H875/5 or H875KB/5) in conductive materials, e.g. steel.

#### Projection Height:

Standard Version: 10,6 - 15,6 mm  
Long Version (L): 17,1 - 22,1 mm

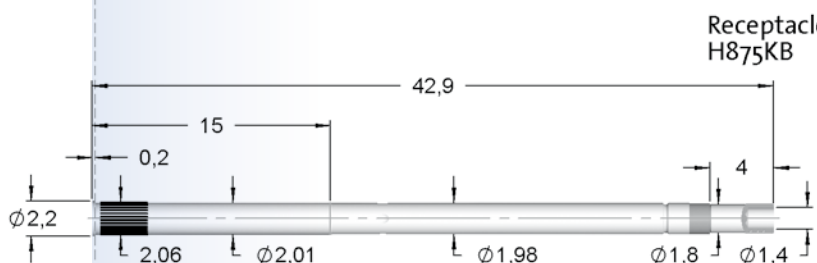

Receptacle  
H875KB

### Solder free replacement H875KB

This receptacle is developed for solder free replacement of switch probes. The probes are height adjustable in combination with KB-Receptacles. Max. temp. 300°C.

#### Projection Height:

Standard Version: 10,4 - 15,4 mm  
Long Version (L): 16,9 - 21,9 mm

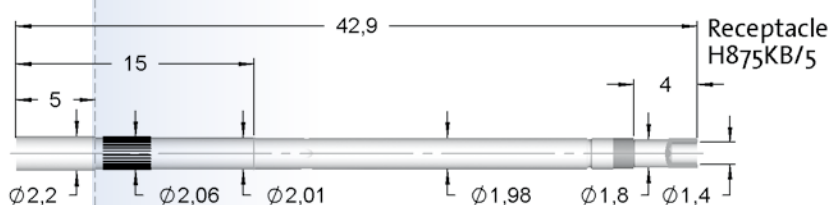

Receptacle  
H875KB/5

### Solder free replacement H875KB/5

H875KB/5 is compatible to H875KB but with collar height 5 mm. Max. temp. 300°C.

#### Projection Height:

Standard Version: 15,2 - 20,2 mm  
Long Version (L): 21,7 - 26,7 mm