

## Copy and face milling cutter heads with thread

For milling cutter indexable inserts RD..0501., RD..0702., RD..12T3..

**ATORN**<sup>®</sup>

### Application

For face milling and copy milling, light and medium chipping

### Version

- Wear-resistant, nickel-plated version
- With internal cooling
- Clamping screw tightening torque (indexable insert) M1.8 = 0.7 Nm, M2.5 = 1.2 Nm, M3.5 = 3.5 Nm

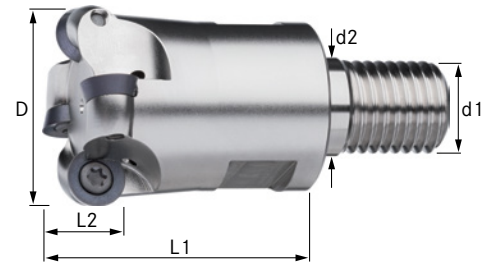

<b>Art. No.</b>	<b>16035 226</b>
<b>Max. cutting edge diameter</b>	25 mm
<b>Clearance length</b>	35 mm
<b>Thread dimension</b>	M12
<b>max. ap</b>	2.5 mm
<b>Number of cutting edges</b>	3 PCS
<b>Suitable indexable insert no.</b>	32

### EAN-Code

4050293320220