

Series 11 Actuators

SEE PAGE 55 FOR SWITCHES



KEY FEATURES:

- Roller Lever
- Overtravel

MECHANICAL CHARACTERISTICS*:

Part Number	Oper. Force	Release Force	Pretravel	Overtravel	Movement Diff.	Operating Point
71-1040 Roller Lever	3.5 oz max	2 oz min	.093 max	.062 min	.030 ± .015	.671 ± .031
71-2010 Overtravel Plunger	8 ± .3 oz	4 oz min	.050 max	.215 min	.020 ± .005	.828 ± .015

*Mechanical characteristics when used with Basic Switch 11-104.

STANDARDS / AGENCY / RATINGS:



71-1040

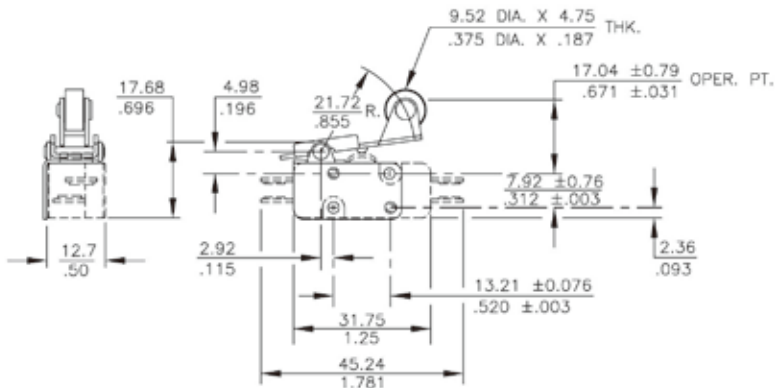

71-2010

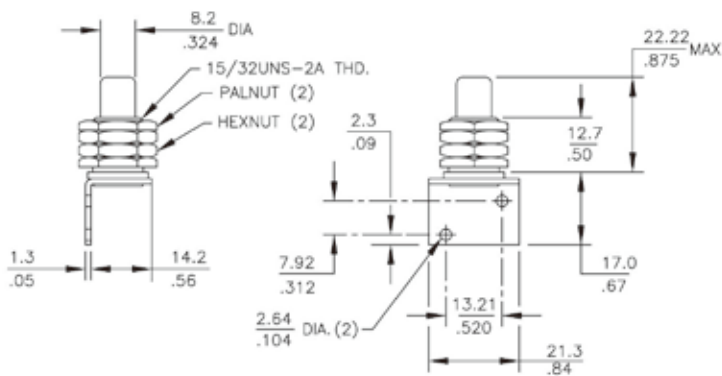

ELECTRICAL CHARACTERISTICS:

Circuit:
SPDT-DB (Form Z)

Electrical Ratings (Typical):

Circuitry	125/250 VAC	28 VDC
SPST-DB NC (Form Y) or NO (Form X)	10 amp (75-80% PF)	10 amp Ind
SPDT-DB (Form Z)	1/2 HP 125 VAC	15 amp Res
SPDT-SB (Form C)	3/4 HP 250 VAC	7 amp Ind 10 amp Res
		4 amp Ind 6 amp Res