

CIRCUIT BOARD HARDWARE

A

R900 Series Nylon Spacer (900 Series)

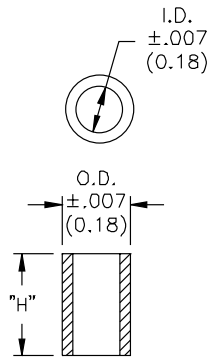

Material: Modified Type 6 Nylon, RMS-60 Color: White		
Part No.	Standard Pack: 1000 per bag	
	ID $\pm .007$ (0.18)	OD $\pm .007$ (0.18)
R901-X	.028 (0.7)	.085 (2.2)
R938-X	.032 (0.8)	
R902-X	.032 (0.8)	
R939-X	.047 (1.2)	.125 (3.2)
R937-X	.090 (2.3)	
R906-X	.085 (2.2)	.148 (3.6)
R903-X	.047 (1.2)	
R940-X	.063 (1.6)	.156 (4.0)
R907-X	.105 (2.7)	
R904-X	.063 (1.6)	.187 (4.8)
R913-X	.091 (2.3)	
R908-X	.125 (3.2)	.230 (5.8)
R941-X	.135 (3.4)	
R910-X	.091 (2.3)	.250 (6.4)
R911-X	.120 (3.0)	
R905-X	.147 (3.7)	
R912-X	.171 (4.3)	

X	Length "H" Dimension	Dimension "H" Tolerance
-1	1/16 (1.6)	$\pm .007$ (0.18)
-2	1/8 (3.2)	
-3	3/16 (4.8)	
-4	1/4 (6.4)	
-5	5/16 (7.9)	
-6	3/8 (9.5)	
-7	7/16 (11.1)	$\pm .010$ (0.25)
-8	1/2 (12.7)	
-9	9/16 (14.3)	
-10	5/8 (15.9)	
-11	11/16 (17.5)	$\pm .015$ (0.38)
-12	3/4 (19.1)	
-13	13/16 (20.6)	
-14	7/8 (22.2)	
-15	15/16 (23.8)	
-16	1 (25.4)	



- Up-to-the-minute product updates can be seen on our corporate web page at www.richco-inc.com
- Raw Material Specifications can be found at the end of the catalog - pages 211-221
- Want to try a sample? Please call 1-800-621-1892