



## STRUT NUT WITHOUT SPRING, STEEL, HD, 0.315"

### CATALOG NUMBER

**NUTM12HD**



### FEATURES

Used to create metal frames with nVent CADDY Eristrut channels

### PRODUCT ATTRIBUTES

Article Number: 315030

Material: Steel

Finish: Hot-Dip Galvanized

Static Load Safety Factor: 3:1

Rod Size: M12

Thickness: 8 mm

Torque: 55 N-m

### DIAGRAMS

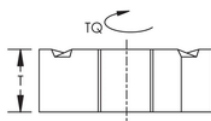
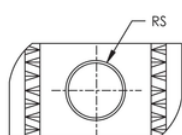

Pull-Out Strength				
Part Number	Channel Type	Channel Thickness		
		2,5 mm	2 mm	1,5 mm
NUTM6xx	A, C	2000 N	2000 N	2000 N
	D, E	2000 N	-	-
NUTM8xx	A, C	3330 N	3330 N	3330 N
	D, E	3330 N	-	-
NUTM10xx	A, C	4890 N	4440 N	4440 N
	D, E	4890 N	-	-
NUTM12xx	A, C	4890 N	4660 N	4440 N
	D, E	3670 N	-	-
NUTM12Txx	A	5670 N	5050 N	4440 N
	D, E	4250 N	-	-
NUTM16xx	A	5670 N	4660 N	4440 N
	D, E	4250 N	-	-

## WARNING

nVent products shall be installed and used only as indicated in nVent's product instruction sheets and training materials. Instruction sheets are available at [www.nvent.com](http://www.nvent.com) and from your nVent customer service representative. Improper installation, misuse, misapplication or other failure to completely follow nVent's instructions and warnings may cause product malfunction, property damage, serious bodily injury and death and/or void your warranty.

### Noord-Amerika

+1.800.753.9221  
 Optie 1 - de Zorg van de Klant  
 Optie 2 - Technische Steun

### Europa

Nederland:  
 +31 800-0200135  
 Frankrijk:  
 +33 800 901 793

### Europa

Duitsland:  
 800 1890272  
 Andere Landen:  
 +31 13 5835404

### APAC

Shanghai:  
 + 86 21 2412 1618/19  
 Sydney:  
 +61 2 9751 8500



Onze krachtige portefeuille van merken:  
**nVent.com CADDY ERICO HOFFMAN RAYCHEM SCHROFF TRACER**