

M3 Male to Female Stainless Steel PCB Spacers



DESCRIPTION

5.5mm AF hexagonal male to female stainless steel spacers with an M3 tapped hole and M3 stud.

DISTINCTIVE FEATURES

- All sizes have undercut as standard
- No need for washers in assembly
- Flush fit

APPLICATIONS

Mounting printed circuit boards or other panels on to a chassis. Ideal for applications where corrosion of normal steel is a factor.

Stainless Steel

M-F

M3

Undercut



GENERAL SPECIFICATION

Series	Stainless PCB Spacers
Type	Male to Female M-F M3 thread
Across Flats (AF)	5.5mm
Stud Length	6mm



MATERIALS

Material	Material acc. to EN DIN 10088: X8CrNiS18-9
Material Number	1.4305
Finish	Natural
Tensile Strength	Min 750 N/mm ²



CERTIFICATION AND STANDARDS

Material Specification	DIN 10088
Undercut Specification	DIN 76-B



ENVIRONMENTAL/OPERATING SPECIFICATION

Preload	0.6Nm*
Tightening torque	1 Nm*
Min. breaking torque	1.1Nm*
*At a coefficient of friction of 0.2	



OPTIONS

Length	Custom lengths are available
Undercut	Available without undercut
Material	E.g. steel, brass, nylon



DIMENSIONS/DRAWINGS

Dimensions	mm
------------	----

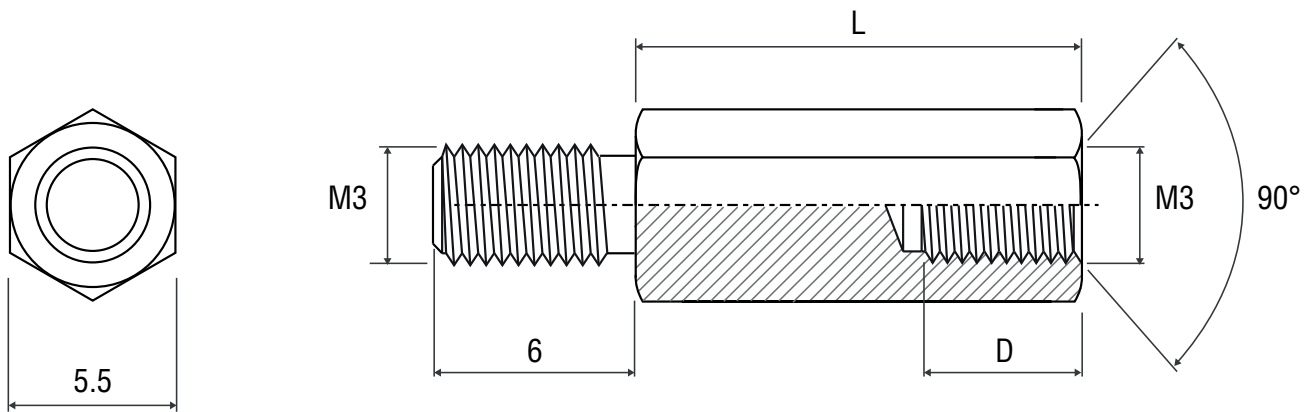

PART NUMBER TABLE

Part Number Units	Body Length (L) mm	Pack quantity (pieces)	Thread Depth (D) mm	Weight (per piece) g	EAN	UNSPSC	Country of origin
52-4393	5	25	3	1.2	5053556004645	31161816	Germany
52-4394	8	25	5	1.54	5053556004652	31161816	Germany
52-4396	10	25	6	1.88	5053556004669	31161816	Germany

R-TECH

Tried & trusted technology

Important Notice: This data sheet and its contents (the "Information") belong to Rapid Electronics Limited or are licensed to it. No licence is granted for the use of it other than for information purposes in connection with the products to which it relates. No licence of any intellectual property rights is granted. The Information is subject to change without notice and replaces all data sheets previously supplied. The Information supplied is believed to be accurate but Rapid Electronics Limited assumes no responsibility for its accuracy or completeness, any error in or omission from it or for any use made of it. Users of this data sheet should check for themselves the Information and the suitability of the products for their purpose and not make any assumptions based on information included or omitted. Liability for loss or damage resulting from any reliance on the Information or use of it (including liability resulting from negligence or where Rapid Electronics Limited were aware of the possibility of such loss or damage arising) is excluded. This will not operate to limit or restrict Rapid Electronics Limited's liability for death or personal injury resulting from its negligence.