

Mini Ball Transfer Units 305 with Plain Bearing

Material: Housing: Stainless steel.
Ball cup: Plastic.
Balls: Stainless steel, hardened.



Mini ball transfer unit, for example for material feeders for processing machines or packing machines. Orientation: anyway. The cup must be inserted into a mounting hole with tolerance H7. The knurled housing is self-holding.

Conveying speed max. 1.5m/sec.
pv-value max. 0.34 Nm/mm² x m/sec.
Temperature range -20°C to +90°C.

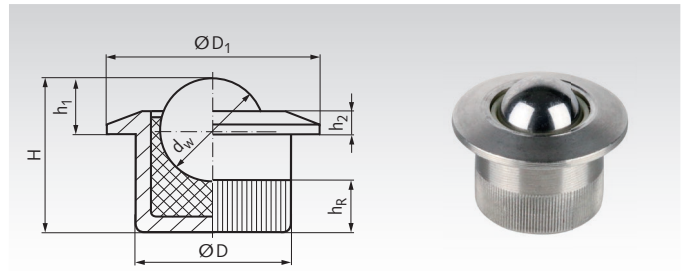

Ordering Details: e.g.: Product No. 654 305 06, Ball Transfer Unit 305 Size 6.5

Product No. Type 305	Size dw mm	Load Rating* at 0,5m/s N	Load Rating* at 1,5m/s N	D mm	D ₁ mm	H mm	h ₁ mm	h ₂ mm	h _R mm	Weight g
654 305 06	6,5	22,60	7,53	10,0	13	11,2	3,2	1,2	4,2	4
654 305 08	8,5	38,64	12,88	12,6	17	12,4	4,5	1,8	4,2	8

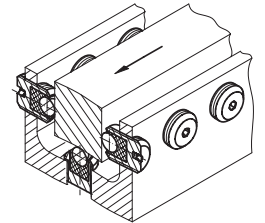

* Up to 20°C. At higher temperatures, the load rating decreases linearly. At 90°C, it is reduced to 60%.

Assembly Plugs for Mini Ball Transfer Units 305

Material: Aluminium.

For ball transfer unit type 305.

The use of this tool avoids damage to the upper, conical part of the housing.

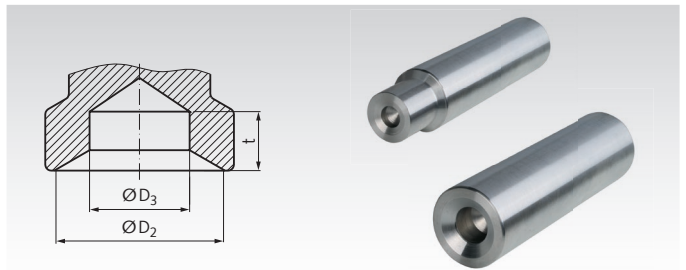

Ordering Details: e.g.: Product No. 654 305 01, Assembly Plug for Mini Ball Transfer Unit 6.5 mm

Product No.	Ball Size d _w mm	D ₂ mm	D ₃ mm	t _{min} mm	outer Ø mm	Length mm	Weight g
654 305 01	6,5	13,5	8	4,0	24	100	116
654 305 02	8,5	17,5	10	5,5	24	100	118

Mini Ball Transfer Units 306 / 307 with Plain Bearing, Screw-In-Version

Material Type 306: Housing: Steel, black oxide finish.
Ball cup: Plastic.

Ball: Steel 100Cr6, hardened.

Material Type 307: Housing: Stainless Steel 1.4305 (AISI 303).

Ball cup: Plastic.

Ball: Stainless steel, hardened.



Mini ball transfer unit, for example for material feeders for processing machines or packing machines. Orientation: anyway. Conveying speed max. 1.5m/sec. pv-value max. 0.34 Nm/mm² x m/sec. Temperature range -20°C to +90°C.



Ordering Details: e.g.: Product No. 654 306 01, Mini Ball Transfer Unit 306 Size 2.5

Product No. Type 306 Black oxidized	Product No. Type 307 Stainless	Size dw mm	Load Rating* at 0,5m/s N	Load Rating* at 1,5m/s N	D mm	H mm	s ≈ mm	sw mm	Fastening torque Nm	Weight g
654 306 01	654 307 01	2,5	3,34	1,11	M6	8	0,5	1,5	0,11	1
654 306 04	654 307 04	2,5	3,34	1,11	M6	16	0,5	1,5	0,11	3
654 306 11	654 307 11	3,5	6,55	2,18	M8	10	0,7	1,5	0,28	3
654 306 14	654 307 14	3,5	6,55	2,18	M8	20	0,7	1,5	0,28	7
654 306 21	654 307 21	4,5	10,83	3,61	M10	12	1,1	2,0	0,58	5
654 306 24	654 307 24	4,5	10,83	3,61	M10	25	1,1	2,0	0,58	13
654 306 31	654 307 31	6,5	22,60	7,53	M12	16	2,0	2,5	1,44	10
654 306 34	654 307 34	6,5	22,60	7,53	M12	35	2,0	2,5	1,44	27
654 306 41	654 307 41	8,5	38,64	12,88	M16	20	2,7	3,0	3,21	24
654 306 46	654 307 46	8,5	38,64	12,88	M16	50	2,7	3,0	3,21	71

* Up to 20°C. At higher temperatures, the load rating decreases linearly. At 90°C, it is reduced to 60%.