

GN 360 | Levelling bushing

Steel or stainless steel



- 1
- 2
- 3
- 4
- 5
- 6
- 7
- 8
- 9
- 10
- 11
- 12
- 13
- 14
- 15
- 16
- 17
- 18

STANDARD EXECUTIONS

Zinc-plated steel:

- **GN 360-A-ST**: without locking nut.
- **GN 360-B-ST**: with locking nut.

AISI 304 stainless steel:

- **GN 360-A-NI**: without locking nut.
- **GN 360-B-NI**: with locking nut.

FEATURES AND APPLICATIONS

GN 360 bushings are used for levelling and to compensate for any slopes when setting up machines.

D2 pass-through threading can also be used to fix the lower part of the bushing.

The fine pitch d3 threading allows for precision adjustment of the bushing and its eventual adjustment using a wrench.

An elastic ring limits the maximum adjustment stroke.

Dimensions GN 360-40/52/65: d1=d4

Dimensions GN 360-79/99/119: d4<d1

ACCESSORIES ON REQUEST

DIN 1810 spanner wrench



Application examples

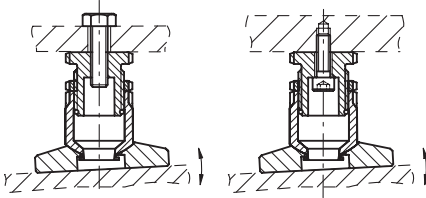

GN 360-A-ST

GN 360-B-ST

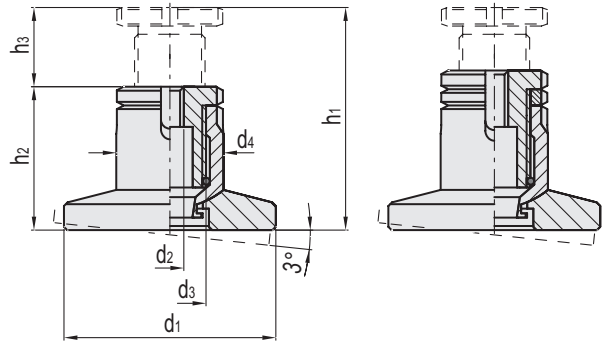

GN 360-A-ST

Code	Description	d1	d2	d3	d4	h1	h2	h3	Static load [N]	⚖️
GN.18503	GN 360-40-M10-69-A-ST	40	M10	M28 x 1.5	40	69	53	16	100	389
GN.18511	GN 360-40-M10-86-A-ST	40	M10	M28 x 1.5	40	86	62	24	100	454
GN.18527	GN 360-52-M12-80-A-ST	52	M12	M36 x 1.5	52	80	61	19	125	808
GN.18519	GN 360-52-M12-103-A-ST	52	M12	M36 x 1.5	52	103	73	30	125	965
GN.18535	GN 360-65-M16-112-A-ST	65	M16	M45 x 1.5	65	112	82	30	225	1600
GN.18543	GN 360-65-M16-148-A-ST	65	M16	M45 x 1.5	65	148	100	48	225	2024
GN.18551	GN 360-79-M10-69-A-ST	79	M10	M28 x 1.5	40	69	53	16	100	725
GN.18559	GN 360-79-M10-86-A-ST	79	M10	M28 x 1.5	40	86	62	24	100	789
GN.18575	GN 360-99-M12-80-A-ST	99	M12	M36 x 1.5	52	80	61	19	125	1414
GN.18567	GN 360-99-M12-103-A-ST	99	M12	M36 x 1.5	52	103	73	30	125	1575
GN.18583	GN 360-119-M16-112-A-ST	119	M16	M45 x 1.5	65	112	82	30	225	2805
GN.18591	GN 360-119-M16-148-A-ST	119	M16	M45 x 1.5	65	148	100	48	225	3205

GN 360-B-ST

Code	Description	d1	d2	d3	d4	h1	h2	h3	Static load [N]	⚖️
GN.18507	GN 360-40-M10-69-B-ST	40	M10	M28 x 1.5	40	69	59	10	100	415
GN.18515	GN 360-40-M10-86-B-ST	40	M10	M28 x 1.5	40	86	68	18	100	479
GN.18531	GN 360-52-M12-80-B-ST	52	M12	M36 x 1.5	52	80	69	11	125	860
GN.18523	GN 360-52-M12-103-B-ST	52	M12	M36 x 1.5	52	103	80	23	125	1017
GN.18539	GN 360-65-M16-112-B-ST	65	M16	M45 x 1.5	65	112	90	22	225	1500
GN.18547	GN 360-65-M16-148-B-ST	65	M16	M45 x 1.5	65	148	108	40	225	2121
GN.18555	GN 360-79-M10-69-B-ST	79	M10	M28 x 1.5	40	69	59	10	100	750
GN.18563	GN 360-79-M10-86-B-ST	79	M10	M28 x 1.5	40	86	68	18	100	814
GN.18579	GN 360-99-M12-80-B-ST	99	M12	M36 x 1.5	52	80	69	11	125	1465
GN.18571	GN 360-99-M12-103-B-ST	99	M12	M36 x 1.5	52	103	80	23	125	1620
GN.18587	GN 360-119-M16-112-B-ST	119	M16	M45 x 1.5	65	112	90	22	225	2900
GN.18595	GN 360-119-M16-148-B-ST	119	M16	M45 x 1.5	65	148	100	40	225	3295

Standard machine parts

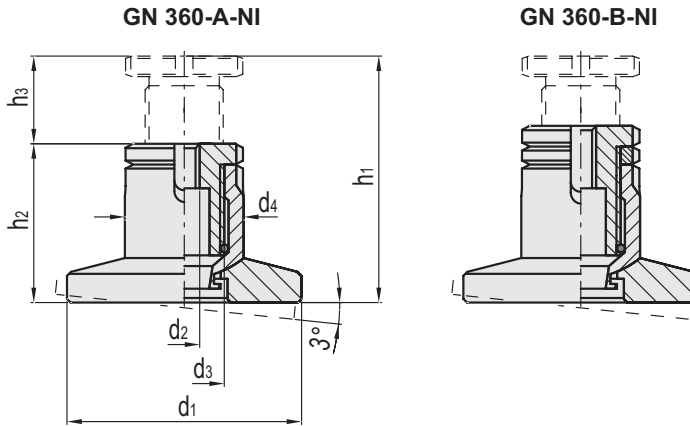

GN 360-A-NI

INOX STAINLESS STEEL

Code	Description	d1	d2	d3	d4	h1	h2	h3	Static load [N]	⚖️
GN.18501	GN 360-40-M10-69-A-NI	40	M10	M28 x 1.5	40	69	53	16	70	390
GN.18509	GN 360-40-M10-86-A-NI	40	M10	M28 x 1.5	40	86	62	24	70	460
GN.18525	GN 360-52-M12-80-A-NI	52	M12	M36 x 1.5	52	80	61	19	85	815
GN.18517	GN 360-52-M12-103-A-NI	52	M12	M36 x 1.5	52	103	73	30	85	975
GN.18533	GN 360-65-M16-112-A-NI	65	M16	M45 x 1.5	65	112	82	30	155	1665
GN.18541	GN 360-65-M16-148-A-NI	65	M16	M45 x 1.5	65	148	100	40	155	2048
GN.18549	GN 360-79-M10-69-A-NI	79	M10	M28 x 1.5	40	69	53	16	70	730
GN.18557	GN 360-79-M10-86-A-NI	79	M10	M28 x 1.5	40	86	62	24	70	825
GN.18573	GN 360-99-M12-80-A-NI	99	M12	M36 x 1.5	52	80	61	19	85	1425
GN.18565	GN 360-99-M12-103-A-NI	99	M12	M36 x 1.5	52	103	73	30	85	1595
GN.18581	GN 360-119-M16-112-A-NI	119	M16	M45 x 1.5	65	112	82	30	155	2880
GN.18589	GN 360-119-M16-148-A-NI	119	M16	M45 x 1.5	65	148	100	40	155	3260

GN 360-B-NI

INOX STAINLESS STEEL

Code	Description	d1	d2	d3	d4	h1	h2	h3	Static load [N]	⚖️
GN.18505	GN 360-40-M10-69-B-NI	40	M10	M28 x 1.5	40	69	59	10	70	418
GN.18513	GN 360-40-M10-86-B-NI	40	M10	M28 x 1.5	40	86	68	18	70	480
GN.18529	GN 360-52-M12-80-B-NI	52	M12	M36 x 1.5	52	80	69	11	85	897
GN.18521	GN 360-52-M12-103-B-NI	52	M12	M36 x 1.5	52	103	80	23	85	1498
GN.18537	GN 360-65-M16-112-B-NI	65	M16	M45 x 1.5	65	112	90	22	155	1758
GN.18545	GN 360-65-M16-148-B-NI	65	M16	M45 x 1.5	65	148	108	40	155	2145
GN.18553	GN 360-79-M10-69-B-NI	79	M10	M28 x 1.5	40	69	59	10	70	755
GN.18561	GN 360-79-M10-86-B-NI	79	M10	M28 x 1.5	40	86	68	18	70	800
GN.18577	GN 360-99-M12-80-B-NI	99	M12	M36 x 1.5	52	80	69	11	85	1031
GN.18569	GN 360-99-M12-103-B-NI	99	M12	M36 x 1.5	52	103	80	23	85	1645
GN.18585	GN 360-119-M16-112-B-NI	119	M16	M45 x 1.5	65	112	90	22	155	2980
GN.18593	GN 360-119-M16-148-B-NI	119	M16	M45 x 1.5	65	148	108	40	155	3360