

4

3

2

HDM12 M		REV. PA6
SHEET 1 OF 7		
REVISIONS		
LTR	DESCRIPTION	DATE
PA6	UPDATE DRAWING	2014-1-22

CUSTOMER DRAWING

GENERAL TOLERANCE					
DIM. RANGE	0.5 - 3	> 3 - 6	> 6 - 30	> 30 - 120	> 120 - 400
TOLERANCE	±0.1	±0.1	±0.2	±0.3	±0.5

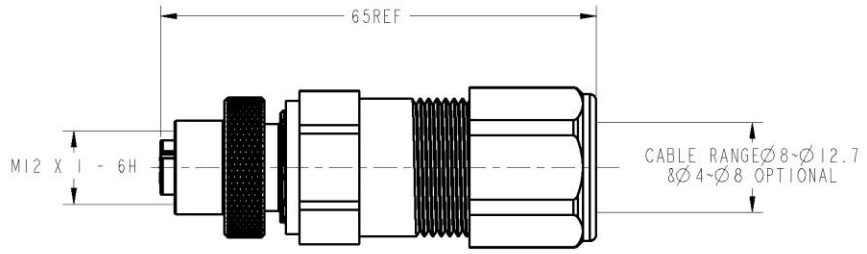
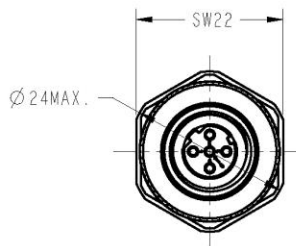

HDM12PF05D1STM

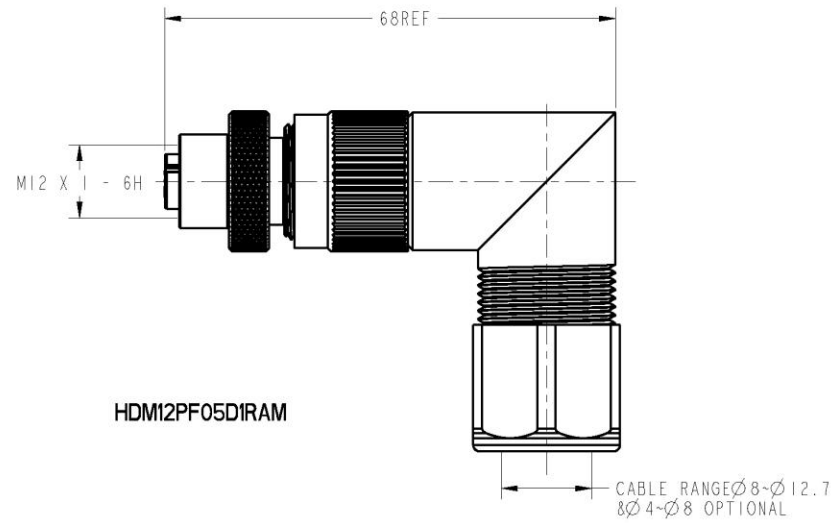
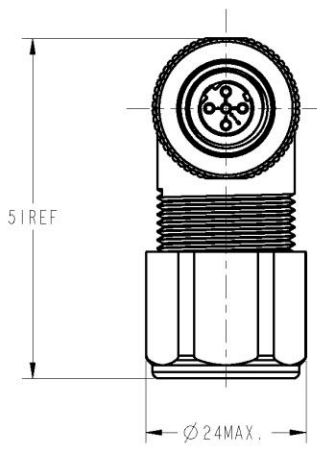

HDM12PF05DIRAM

NOTES:
 THIS DOCUMENT CONTAINS PROPRIETARY INFORMATION AND SUCH INFORMATION MAY NOT BE DISCLOSED TO OTHERS FOR ANY PURPOSE OR USED FOR MANUFACTURING PURPOSES WITHOUT WRITTEN PERMISSION FROM THE AMPHENOL CORP.

N/A	PRO/ENGINEER INFORMATION
NEXT ASSEMBLY	Pro/e Model Used:
METRIC DOCUMENT	Drawing Name:
	HDM12-METAL-BACKSHELL

UNLESS OTHERWISE SPECIFIED		SPECIFICATIONS		POS	QTY	PART NUMBER	DESCRIPTION	NOTE	
LINEAR DIMENSIONS ARE IN: MILLIMETERS		MATERIAL SPEC.		APPROVALS		PARTS LIST			
TOLERANCES: ANGLES= ±2° DEFAULT LINEAR TOLERANCES SEE TABLE		N/A		PREPARED BY: Show Chen	DATE: 22-Jun-14	AMPHENOL INDUSTRIAL OPERATIONS			
DIM. & TOL. PER ASME Y14.5M-1994; DRM PER MIL-DTL-31000; OTHER AMPHENOL STANDARDS: 9-9318		PROCESS SPEC.		DESIGNED BY: Sam Xu		Amphenol Technology(Zhuhai)Co.Ltd			
LEGENDS: =FLAG NOTE CALL OUT REFERENCE ONLY		N/A		DESIGN MANAGER: Ran Xiao		No.63, Xinghen Road, Sanzao Town, Jinwan, Zhuhai, PRC			
				DESIGN ACTIVITY GROUP: C 3		MAX M12 WITH METAL BACKSHELL NICKEL PLATING			
				THIRD ANGLE PROJECTION		SIZE: C	CAGE CODE: 77820	DOCUMENT NO.: HDM12 M	REV. PA6
						SCALE: 1:0	REF.	SHEET 1 OF 7	

HDM12 M SHEET 1 OF 7 PA6

C

B

A

D

C

REV. PA6 SHEET 1 OF 7

HDM12 M

A

4

3

2

1

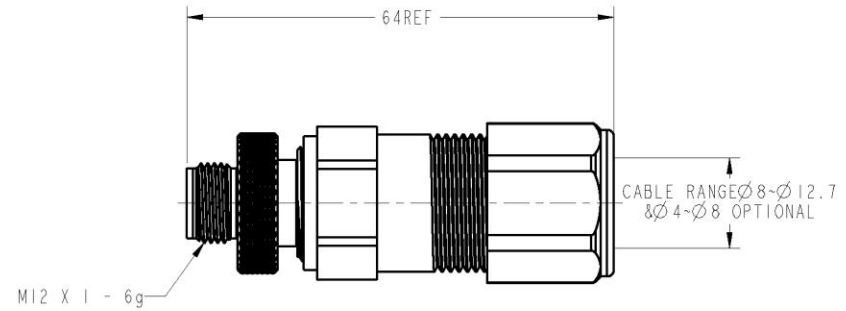
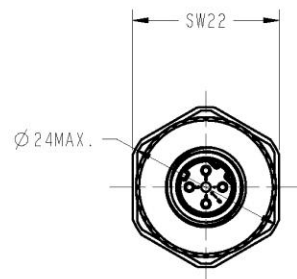

HDM12PM05D1STM

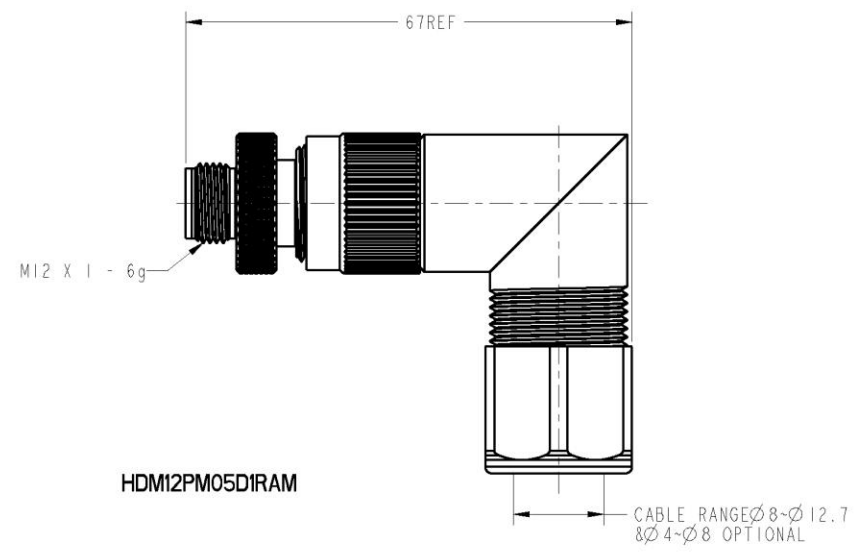
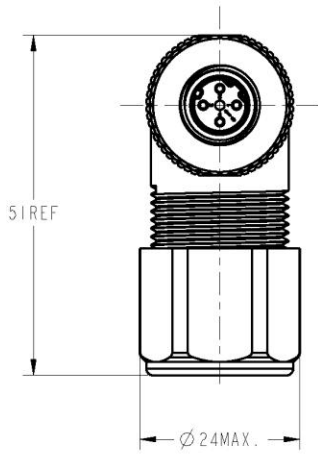

HDM12PM05D1RAM

NOTES:

THIS DOCUMENT CONTAINS PROPRIETARY INFORMATION AND SUCH INFORMATION MAY NOT BE DISCLOSED TO OTHERS FOR ANY PURPOSE OR USED FOR MANUFACTURING PURPOSES WITHOUT WRITTEN PERMISSION FROM THE AMPHENOL CORP.

DOCUMENT NO.	SHEET 2 OF 7	REV.
HDM12.M	PA6	

SIZE	CASE CODE	DOCUMENT NO.	REV.
C	77820	HDM12.M	PA6
SCALE: 2.0	REF:	SHEET 2 OF 7	

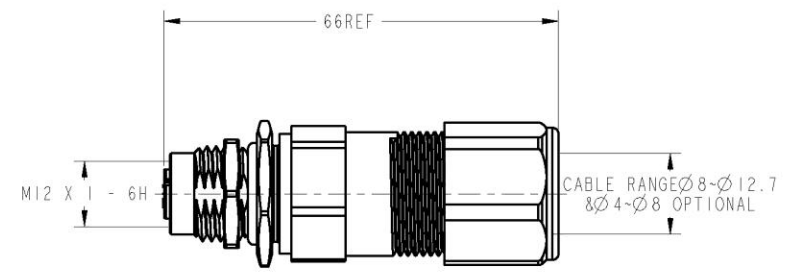
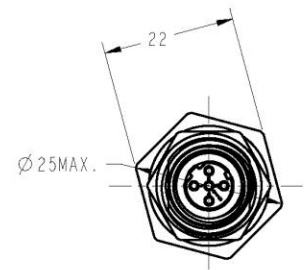

HDM12RF05D1STM

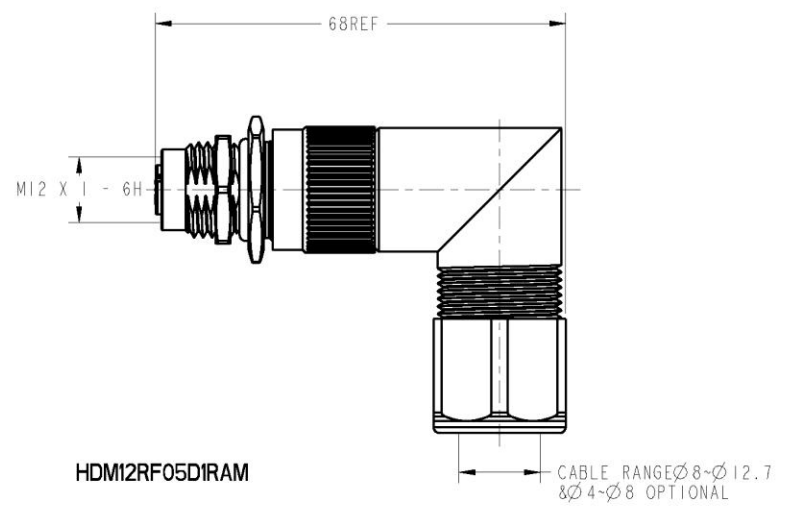
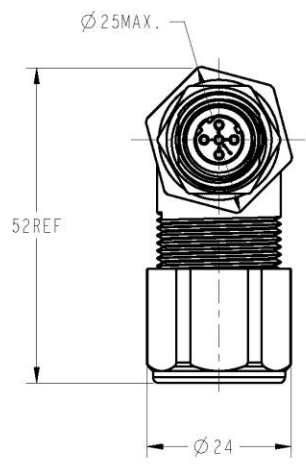

HDM12RF05D1RAM

NOTES:
 THIS DOCUMENT CONTAINS PROPRIETARY INFORMATION AND SUCH INFORMATION MAY NOT BE DISCLOSED TO OTHERS FOR ANY PURPOSE OR USED FOR MANUFACTURING PURPOSES WITHOUT WRITTEN PERMISSION FROM THE AMPHENOL CORP.

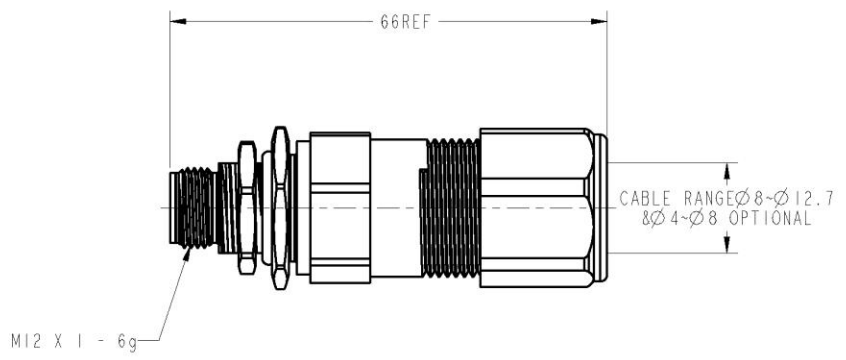
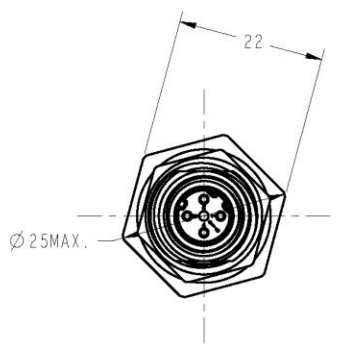

HDM12RM05D1STM

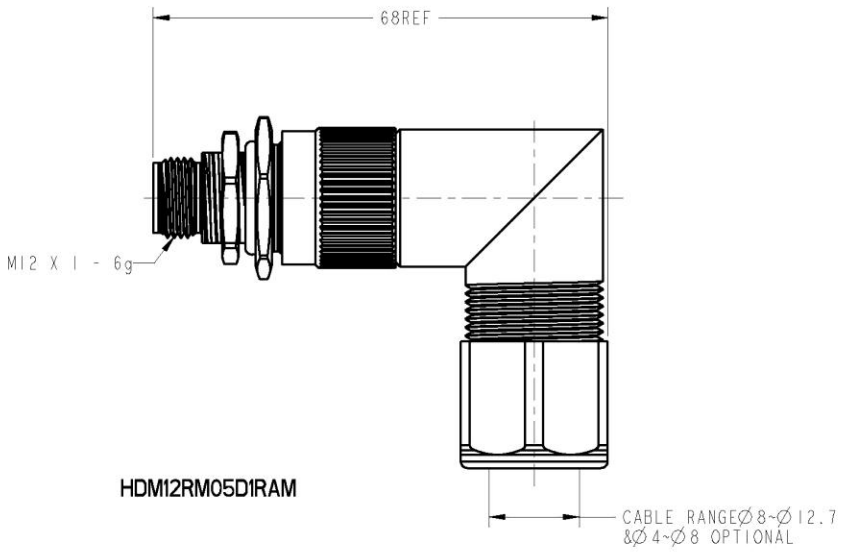
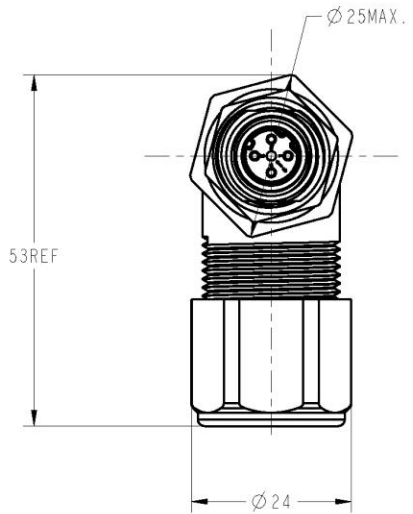

HDM12RM05D1RAM

NOTES:
THIS DOCUMENT CONTAINS PROPRIETARY INFORMATION AND SUCH INFORMATION MAY NOT BE DISCLOSED TO OTHERS FOR ANY PURPOSE OR USED FOR MANUFACTURING PURPOSES WITHOUT WRITTEN PERMISSION FROM THE AMPHENOL CORP.

INSERT ARRANGEMENT AND CODING

CODING

Male

Female

INSERT ARRANGEMENT

**A - CODING
(5 POLE)**

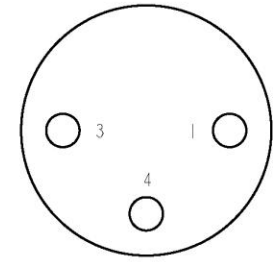
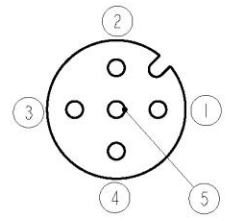
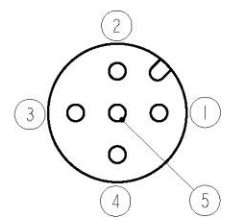

**B - coding
(5 POLE)**

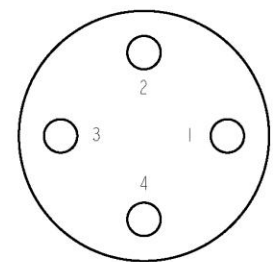
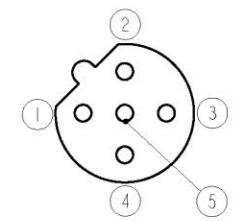
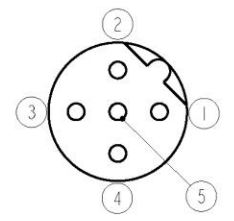

**D - coding
(5 POLE)**

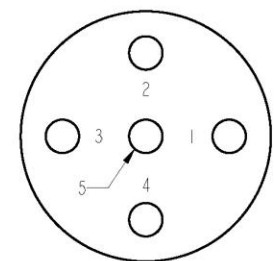
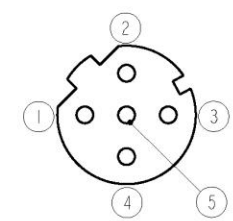
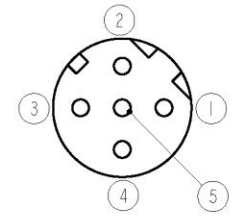

**P - coding
(4 + PE POLE)**

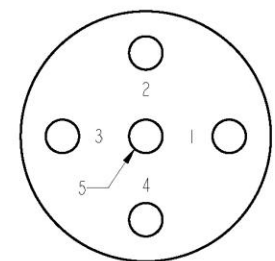
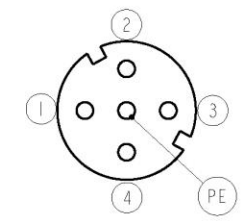
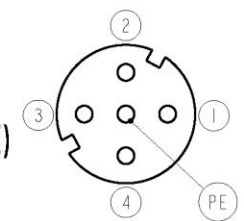

NOTES:
THIS DOCUMENT CONTAINS PROPRIETARY INFORMATION AND SUCH INFORMATION MAY NOT BE DISCLOSED TO OTHERS FOR ANY PURPOSE OR USED FOR MANUFACTURING PURPOSES WITHOUT WRITTEN PERMISSION FROM THE AMPHENOL CORP.

HDM12.M SHEET 5 OF 7 PA6

DOCUMENT NO. HDM12.M SHEET 5 OF 7 PA6

SPECIFICATION

OPERATING VOLTAGE	5 PIN -60V AC/DC 3&4 PIN-250V AC/DC	IEC 60664
CURRENT RATING	4A MAX.	IEC 60512 TEST 5B
TEMPERATURE RATING	-55°C - +125°C -55°C - +150°C(WITH VITON SEALS)	SAE J2839,4.2.3.13
DIELECTRIC WITHSTANDING VOLTAGE	1000V	IEC 60512, TEST 4A
INSULATION RESISTANCE	>20 Megohms	SAE J2839, 4.2.3.3
RATED IMPULSE VOLTAGE	1500V	IEC 60664-1
CONTACT RESISTANCE	<10 mΩ	IEC 60512 TEST 2A
CONTACT RESISTANCE	EMI PROTECTION	
VIBRATION, SINE	10 - 2000 Hz, 20g, <1 us	SAE J2839, 4.2.3.15
SHOCK, HALF SINE	10 CYCLES, 50g, 11ms, <1 us	SAE J2839, 4.2.3.16
TEMPERATURE LIFE	1000H AT 125°C ± 3°C	SAE J2839, 4.2.3.7
DURABILITY	100 CYCLES MIN.	SAE J2839, 4.2.3.11
SALT FOG	240H	SAE J2839, 4.2.3.12
PROTECTION CLASS	IP67 OR ABOVE	IEC 60529
WIRE GAUGE	0.5 mm ² (20AWG) OR 0.8 mm ² (18AWG) / 0.75 mm ²	SAE J1128 / ISO 6722
CABLE OD.	∅12.7 MAX.	
RECOMMENDED TORQUE	M12 THREAD, 0.8 - 1.0 Nm	
CONNECTOR RETENTION	444N MIN	SAE J2839,4.2.3.20
CONTACT RETENTION	110 N MIN	SAE J2839,4.2.3.18
PANEL THICKNESS	1-6 mm FOR HDM12RF	
	1-6 mm FOR HDM12RF	
SHELL PLATING	NICKEL PLATED	

NOTES:

THIS DOCUMENT CONTAINS PROPRIETARY INFORMATION AND SUCH INFORMATION MAY NOT BE DISCLOSED TO OTHERS FOR ANY PURPOSE OR USED FOR MANUFACTURING PURPOSES WITHOUT WRITTEN PERMISSION FROM THE AMPHENOL CORP.

SIZE C	CASE CODE 77820	DOCUMENT NO. HDM12.M	REV. PA6
SCALE: 1.0	REF:	SHEET 6 OF 7	

HDM12 P M 05 D 1 ST M (V)

LETTER DENOTING THE TYPE OF CONNECTOR

PLUG P
RECEPTACLE R

MALE M
FEMALE F

INSERT ARRANGEMENT
03: 3 POLE
04: 4 POLE
05: 5 POLE

VITON RUBBER SEALS
OMIT FOR STANDARD
RUBBER SEALS

METAL BACK SHELL M

STRAIGHT ST
RIGHT ANGLE RA
NO BACKSHELL XX

CONTACT FINISH:
GOLD 1
SILVER 2
NICKEL 4

CODING:
A-CODING A
B-CODING B
D-CODING D
P-CODING P

NOTES:
THIS DOCUMENT CONTAINS PROPRIETARY INFORMATION AND SUCH INFORMATION MAY NOT BE DISCLOSED TO OTHERS FOR ANY PURPOSE OR USED FOR MANUFACTURING PURPOSES WITHOUT WRITTEN PERMISSION FROM THE AMPHENOL CORP.