

CIRCUIT BREAKER 3VA1 IEC FRAME 160 BREAKING CAPACITY CLASS M ICU=55KA @ 415 V 2-POLE, LINE PROTECTION TM210, FTFM, IN=20A OVERLOAD PROTECTION IR=20A FIXED SHORT CIRCUIT PROTECTION II=16 X IN CABLE CONNECTION



| Model | |
|--|-----------------------------|
| Product brand name | SENTRON |
| Product designation | Molded case circuit breaker |
| Design of the product | Line protection |
| Design of the overcurrent release | TM210 |
| Protective function of the overcurrent release | LI |
| Number of poles | 2 |

| General technical data | |
|--|--------|
| Tension assignée d'isolement U_i | 500 V |
| Max. rated operational voltage U_e with AC 50/60Hz | 415 V |
| Max. rated operational voltage U_e with DC | 250 V |
| Active power loss / for rated value of the current / at AC / in hot operating state / per device | 8 W |
| Active power loss / for rated value of the current / at AC / in hot operating state / per pole | 4 W |
| Mechanical service life (switching cycles) / typical | 15 000 |
| Electrical endurance (switching cycles) / at AC-1 / at 380/415 V 50/60 Hz | 8 000 |
| Neutral conductors / upgradeable/retrofitable | No |

| | |
|---------------------------------|---------|
| Ground fault monitoring version | Without |
| Product function | |
| • communication function | No |
| • other measurement function | No |

Electricity

| | |
|---|-------|
| Max. rated operational voltage of the size of the circuit-breaker | 160 A |
| Courant permanent assigné Iu | 20 A |
| Operating current | |
| • at 40 °C | 20 A |
| • at 45 °C | 20 A |
| • at 50 °C | 20 A |
| • at 55 °C | 20 A |
| • at 60 °C | 19 A |
| • at 65 °C | 19 A |
| • at 70 °C | 19 A |

Switching capacity according to IEC 60947

| | |
|---|--------|
| Switching capacity class of the circuit breaker | M |
| Maximum short-circuit current breaking capacity (Icu) | |
| • at 240 V | 85 kA |
| • at 415 V | 55 kA |
| Operational short-circuit current breaking capacity (Ics) | |
| • at 240 V | 85 kA |
| • at 415 V | 55 kA |
| Short-circuit current making capacity (Icm) | |
| • at 240 V | 187 kA |
| • at 415 V | 121 kA |

Adjustable parameters

| | |
|---|-------|
| Adjustable response value current / I _g min. | 20 A |
| Adjustable response value current / I _g min. | 20 A |
| Adjustable response value current / I _i min. | 320 A |
| Adjustable response value current / I _i max. | 320 A |
| Ground fault protection / tripping switchable / I _{2t} =ON/OFF | No |

Mechanical Design

| | |
|-------------|---------|
| Height [in] | 5.1 in |
| Height | 130 mm |
| Width [in] | 2 in |
| Width | 50.8 mm |
| Depth [in] | 2.8 in |

| | |
|-------|-------|
| Depth | 70 mm |
|-------|-------|

Connections

| | |
|---|---------------------------------|
| Arrangement of electrical connectors / for main current circuit | Front terminal |
| Type of electrical connection / for main current circuit | box terminal |
| Type of connectable conductor cross-section, round conductor terminal, stranded | 1 x (1.5 - 70 mm ²) |

Auxiliary circuit

| | |
|--|---|
| Number of CO contacts / for auxiliary contacts | 0 |
|--|---|

Accessories





| | |
|--|----|
| Product extension / optional / motor drive | No |
|--|----|

Environmental conditions

| | |
|--|--|
| Protection class IP / on the front | IP40 |
| Ambient temperature | |
| <ul style="list-style-type: none"> during operation / minimum during operation / maximum during storage / minimum during storage / maximum | <ul style="list-style-type: none"> -25 °C 70 °C -40 °C 80 °C |

Certificates

| | |
|--|---|
| Equipment marking / acc. to DIN EN 81346-2 | Q |
|--|---|

| General Product Approval | | EMC | Declaration of Conformity | Test Certificates |
|--|--|--|--|---|
|  CCC |  VDE |  EAC |  RCM |  EG-Konf. |
| | | | | Miscellaneous |

| Test Certificates | other |
|--|--|
| Type Test Certificates/Test Report | Special Test Certificate |
| | Miscellaneous |

Further information

- Information- and Downloadcenter (Catalogs, Brochures,...)**
<http://www.siemens.com/lowvoltage/catalogs>
- Industry Mall (Online ordering system)**
<https://mall.industry.siemens.com/mall/en/en/Catalog/product?mlfb=3VA1120-5ED26-0AA0>
- Service&Support (Manuals, Certificates, Characteristics, FAQs,...)**
<https://support.industry.siemens.com/cs/ww/en/ps/3VA1120-5ED26-0AA0>
- Image database (product images, 2D dimension drawings, 3D models, device circuit diagrams, ...)**
http://www.automation.siemens.com/bilddb/cax_en.aspx?mlfb=3VA1120-5ED26-0AA0

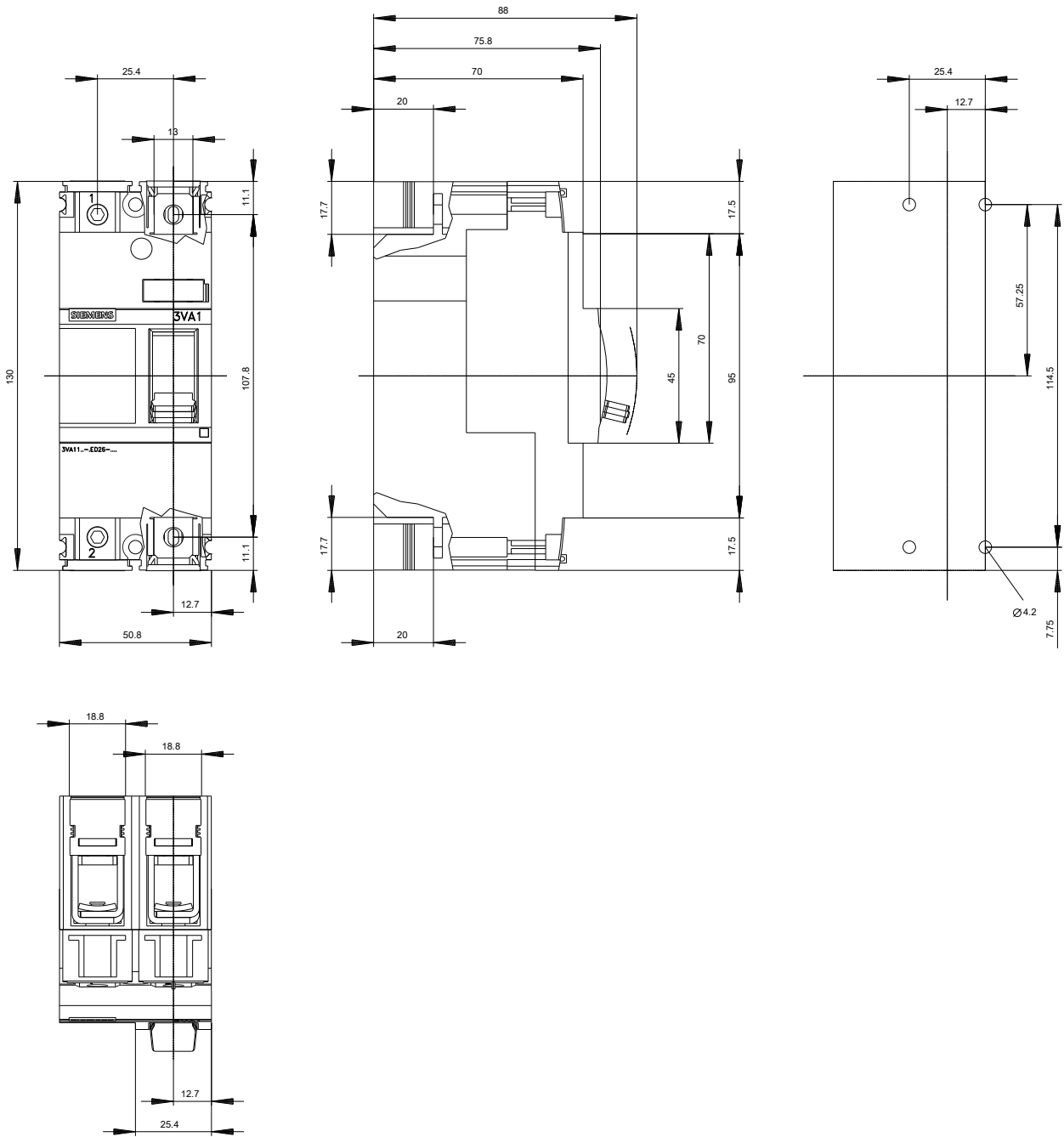

-Q

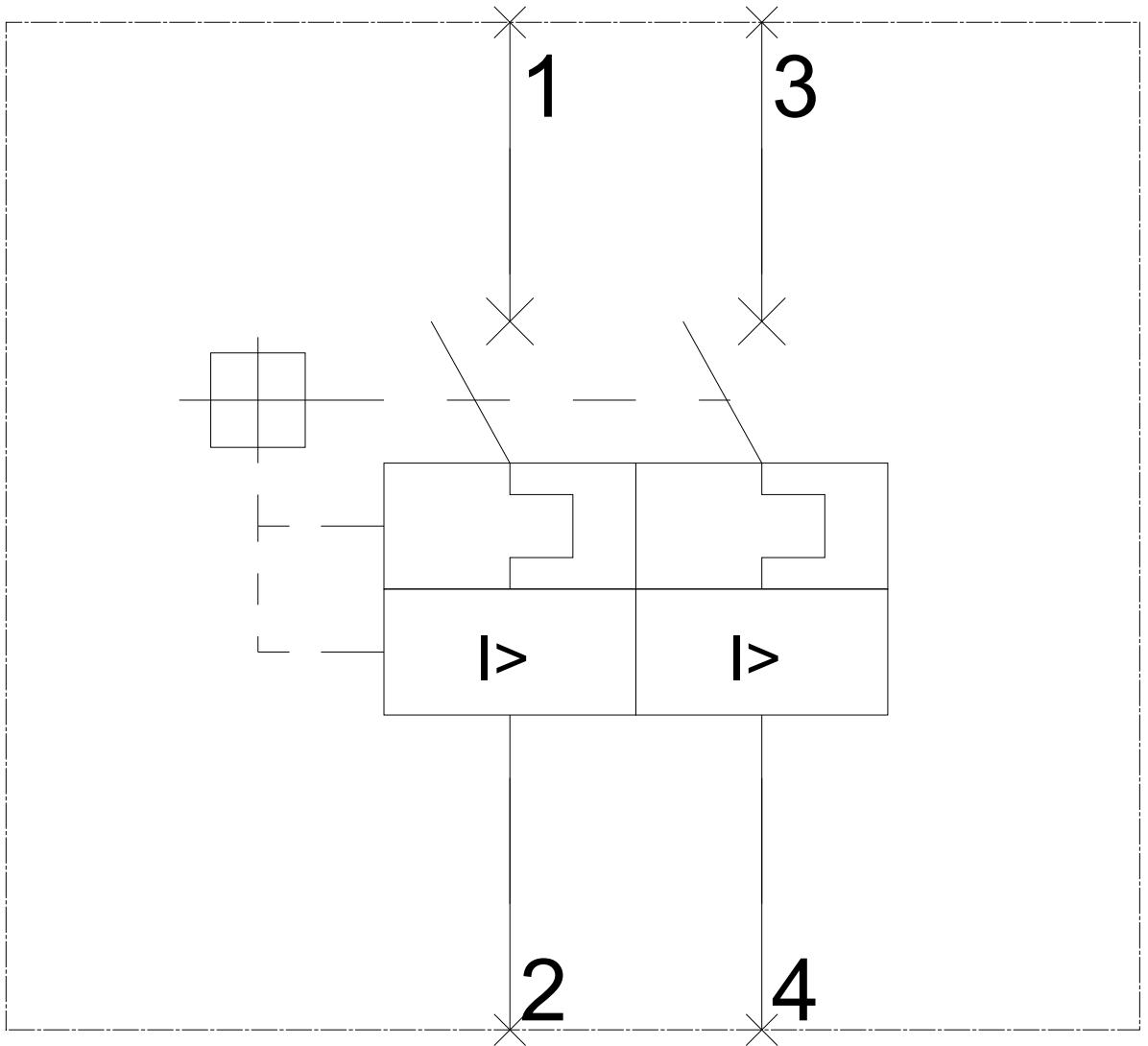

last modified:

08/20/2017