

DETAIL "A"
SCALE: 8:1

**UNCONTROLLED
DOCUMENT**

IMPEDANCE (Z)			
Frequency	25 MHz	100 MHz	300 MHz
Nominal (REF)	45 Ω	127 Ω	300 Ω
Minimum	- Ω	102 Ω	- Ω

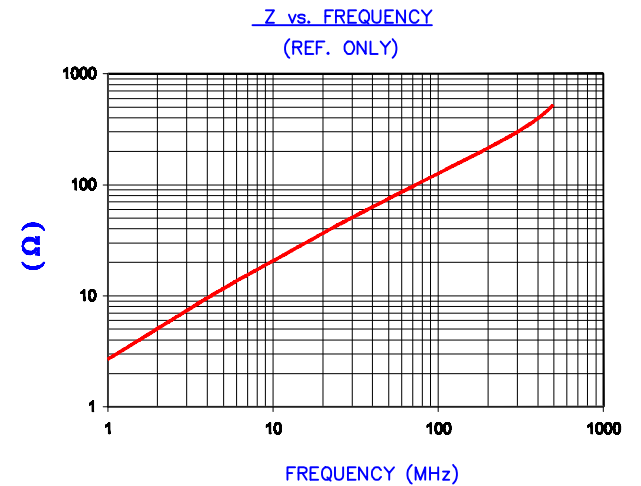

AGILENT E4991A Impedance/Material Analyzer
HP 16082A Test Fixture, REF #2960

FERRITE CORE DIMENSIONS (SPEC):mm[Inches]

A	49.61 [1.953]	+	1.02 [.040]
B	44.00 [1.732]	+	0.89 [.035]
C	12.00 [.472]	+	0.38 [.015]
D	7.62 [.300]		+ 0.76 [.030] - 0.30 [.012]
E	1.45 [.057]		+ 0.40 [.016] - 0.25 [.010]

WEIGHT/1000 17.52 kgs [38.63 Lbs]

SCALE DRAWING 1:1

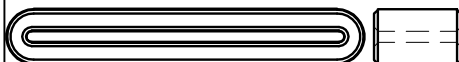

28R1953-000

DIMENSIONS ARE IN mm [INCHES].				THIS DOCUMENT CONTAINS INFORMATION WHICH IS PROPRIETARY AND CONFIDENTIAL TO STEWARD. NO PRODUCTION OR PUBLICATION OF THIS DOCUMENT IN WHOLE OR IN PART SHALL BE MADE WITHOUT WRITTEN AUTHORIZATION FROM STEWARD.			
M	UPDATE MIN Z SPECS & COMPANY LOGO	07/27/07	TMB				
L	UPDATE MIN Z SPEC @100 Mhz ADD REF #	02/16/04	JRK				
K	UPDATE FORMAT, CURVE AND Z SPECS	05/08/03	JRK	PROJECT/PART NUMBER:	REV	PART TYPE:	DRAWN BY:
J	UPDATE TO CNZ FORMAT, ADD Z CURVE	08/06/02	JRK	28R1953-000	M	FERRITE RIBBON CORE	DJB
H	UPDATED Z SPECS	1031/91	DJB	DATE:	SCALE:	MATERIAL:	
REV	DESCRIPTION	DATE	INT	10/31/91	2.5:1	NiZn FERRITE	
				CAD #	TOOL #		
				28R1953-000-M	R1953		