

| REVISIONS | | | |
|-----------|---------------------------|----------|-------|
| REV | DESCRIPTION, ECN, EAR NO. | DATE | APP'D |
| A | PROPOSAL | MAR31/16 | LCHAN |

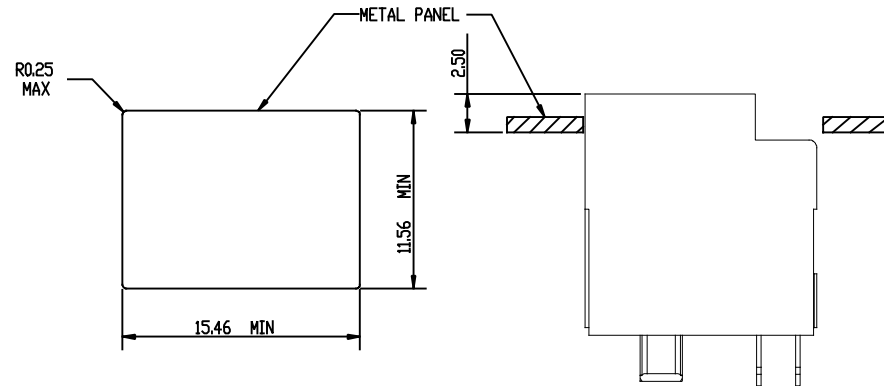

RECOMMENDED PANEL CUTOUT

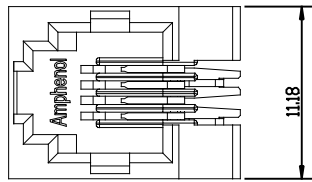
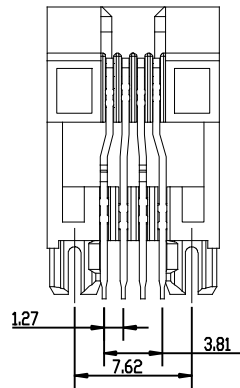
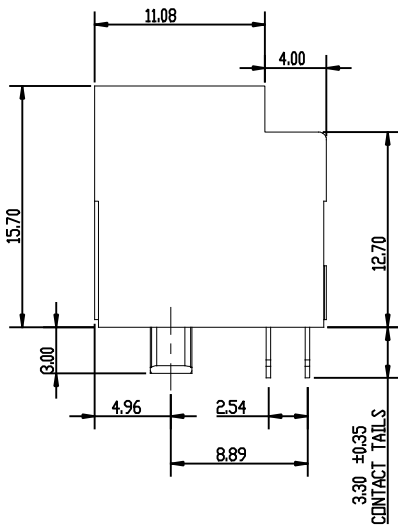

MATERIALS:

PLASTIC HOUSING: HIGH TEMPERATURE THERMOPLASTIC
UL FLAMMABILITY 94V-0.

CONTACT: PHOSPHOR BRONZE, GOLD PLATED ON MATING AREA,
OVER NICKEL, AND MATTE TIN ON TAILS.

CONTACT PLATING: REFER PART NUMBER FOR GOLD THICKNESS
ON MATING SURFACE.
40u" [1.00 MICRONS] MIN. PALLADIUM NICKEL
ON MATING SURFACE.
50u" [1.27 MICRONS] MIN. NICKEL UNDERPLATE.
100u" [2.54 MICRONS] MIN. MATTE-TIN ON CONTACT TAILS.

AMPHENOL PART NUMBER: RJE1J-144-0X10.

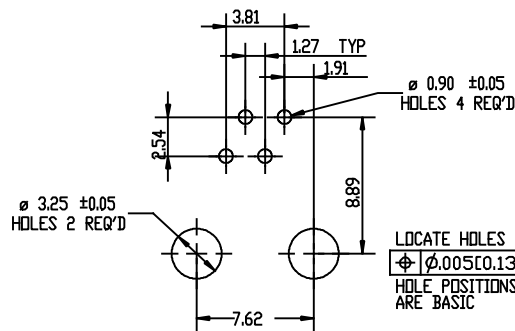

LOCATE HOLES
⊕ ⌀.005C0.13J
HOLE POSITIONS
ARE BASIC

RECOMMENDED P.C.B. LAYOUT
(COMPONENT SIDE OF BOARD)
PCB THICKNESS: 1.57MM
TOLERANCE: +/-0.05MM



| | | | | | |
|----------------------------|--------------------------|------------------------|--------|----------|--|
| UNLESS SPECIFIED OTHERWISE | | DRAWN | FRANKW | MAR31/16 | Amphenol Canada Corp. |
| PRIMARY UNITS | MILLIMETERS | CHECKED | LCHAN | MAR31/16 | |
| SECONDARY | | M.E. APP'D | | | MODULAR JACK, SINGLE PORT, VERTICAL MOUNT, 4P4C, WITHOUT SHIELD. TRAY PACKAGING - RoHS COMPLIANT |
| | REFERENCE IN PARENTHESES | Q.A. APP'D | | | |
| GENERAL TOLERANCES | | DWG APPR. | | | |
| 1 DECIMAL PLACE | ± 0.38 | ENG. REL. NO. | | | DWG. NO. |
| 2 DECIMAL PLACES | ± 0.20 | REF. | | | P-RJE1J-144-0X10 |
| 3 DECIMAL PLACES | | | | | REV A |
| ANGULAR DEGREES | ± 10 ° | THIRD ANGLE PROJECTION | | | CODE ID NO. |
| | | | | | 03554 |
| | | | | | DWG SIZE: X |
| | | | | | SCALE: 4:1 |
| | | | | | SHEET 1 OF 2 |

| REVISIONS | | | | |
|-----------|------|--------------|----------|--------|
| SYM | ZONE | ECN, ERN NO. | DATE | APPRD. |
| A | | PROPOSAL | MAR31/16 | L.CHAN |

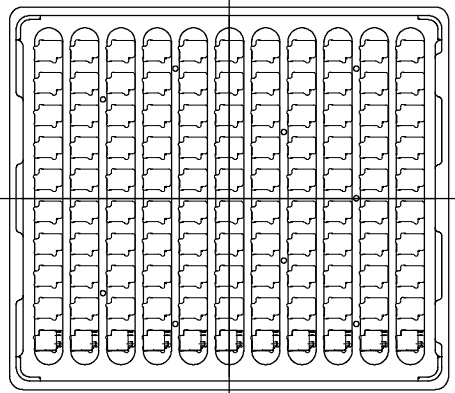
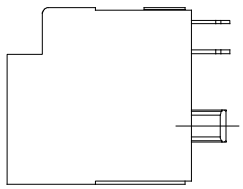

12 TRAY PER CARTON

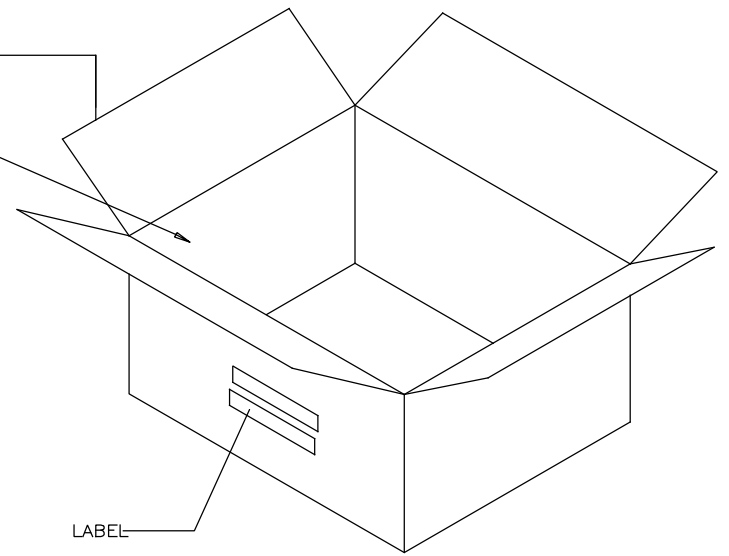

LABEL

SEAL THE CARTON

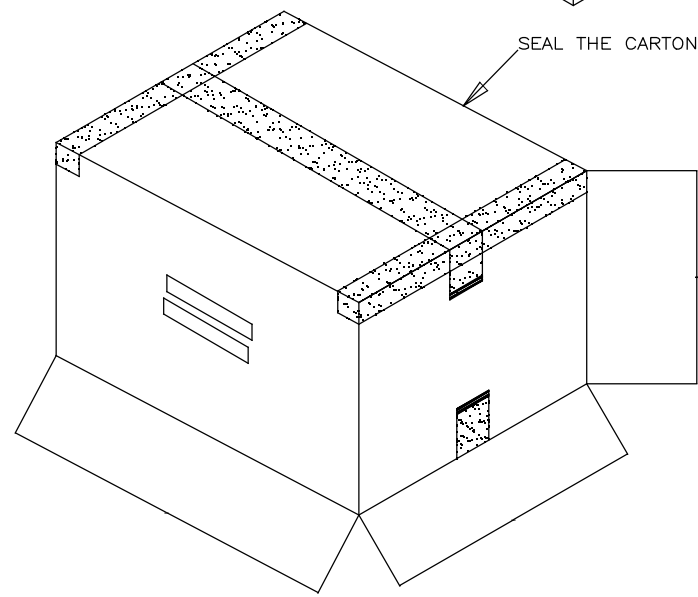

PACKAGING NOTES:

1. 110PCS CONNECTORS PER TRAY
2. 12 TRAY PER CARTON (1320 PCS CONNECTORS PER CARTON)



| | | | |
|-------------------|--------------|----------|----------|
| DRAWN | FRANK.W | DATE | MAR31/16 |
| DESIGNED | | | |
| CHECKED | L.CHAN | MAR31/16 | |
| I. E. APPRD. | | | |
| Q. A. APPRD. | | | |
| DWG. APPRD. | | | |
| ENG. REL. NO. | | | |
| REF. | | | |
| DIMENSIONS ARE IN | CODE ID. NO. | | |
| INCHES [mm] | 03554 | | |

| | | | |
|---|------------------|-------------|--------------|
| Amphenol Canada Corp. | | | |
| TITLE MODULAR JACK, SINGLE PORT, VERTICAL MOUNT, 4P4C, WITHOUT SHIELD. TRAY PACKAGING - RoHS COMPLIANT | | | |
| DWG | DRAWING NO. | REV. | |
| | P-RJE1J-144-0X10 | A | |
| SCALE | WT. ----- | SURF. ----- | SHEET 2 OF 2 |

THIS DOCUMENT CONTAINS PROPRIETARY INFORMATION AND SUCH INFORMATION MAY NOT BE DISCLOSED TO OTHERS FOR ANY PURPOSE OR USED FOR MANUFACTURING PURPOSES WITHOUT WRITTEN PERMISSION FROM AMPHENOL CANADA CORP.