

Feed-through terminal blocks for high-current applications - CLIPLINE

High-current panel feed-through terminal blocks - CLIPLINE

PW...4 high-current feed-through terminal blocks with push-in connection

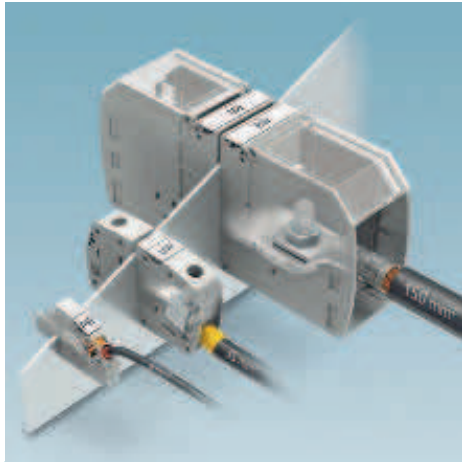

- User-friendly push-in connection
- Tool-free wiring of conductors with ferrules or solid conductors from 0.34 mm²
- The integrated latch allows you to release connected conductors with any type of tool
- Molded versions ensure maximum tightness of seal
- Easy grouping with engagement pin versions

N



4/6 mm² molded feed-through terminal block, inside section with slip-on connection

Accessories

For all types	Type	
	Screwdriver SZF 1-0,6 x 3,5 Order No. 1204517	
For PW 4.../S	Flange plate PW 4-F Order No. 3000403	

Dimensional drawing

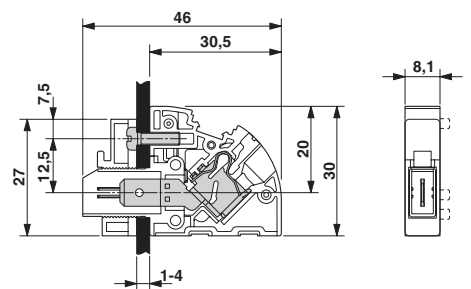

Drilling diagram

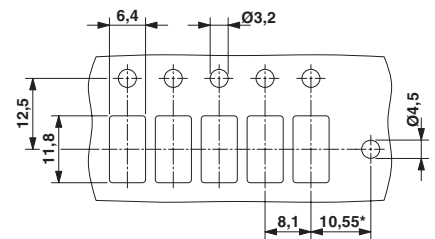

Technical data

Technical data according to IEC/DIN VDE				
Current / conductor cross section	[A] / [mm ²]	20 / 4 // 18 / 4		
Rated voltage	[V]	800		
Connection capacity				
Solid / stranded	[mm ²] / [mm ²] / AWG	0.2 - 4 / 0.2 - 4 / 24 - 12		
Stranded with ferrules without plastic sleeve	[mm ²]	0.25 - 4		
Stranded with ferrules with plastic sleeve	[mm ²]	0.25 - 4		
Multi-conductor connection capacity (two conductors with the same cross section)				
Insulation coordination				
Surge voltage category / pollution degree		III / 3	III / 2	II / 2
Rated insulation voltage	[V]	800	1000	1000
Rated surge voltage	[kV]	8	8	8
Approval data (UL/CUL)	Use Group	B	C	D
Nominal voltage	[V]	-	-	-
Nominal current	[A]	-	-	-
Connection capacity AWG	AWG	-	-	-
Approval data (CSA)	Use Group	B	C	D
Nominal voltage	[V]	-	-	-
Nominal current	[A]	-	-	-
Connection capacity AWG	AWG	-	-	-
General data				
Stripping length	[mm]	10		
Insulation material		PA		
Inflammability class according to UL 94		V0		
Panel thickness	[mm]	1 - 4		

Ordering data

Description	Type	Order No.	Pcs. / Pkt.
Feed-through terminal block	PW 4-POT-SCM	3056938	50
Feed-through terminal block, with engagement pin	PW 4-POT-SCM/S	3056941	50

ZB 8.../ZBF 8... marking material (see CLIPLINE catalog)

TMT (EX9,5)R marking material (see online catalog)



N

4/6 mm² molded feed-through terminal block, inside section with solder connection

Dimensional drawing

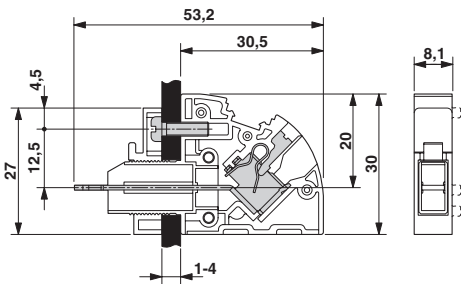

Drilling diagram

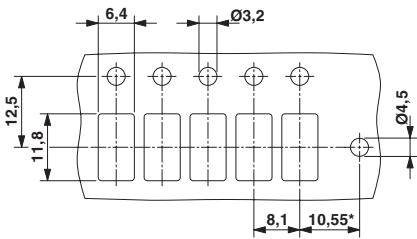

Ordering data

Type	Order No.	Pcs. / Pkt.
Feed-through terminal block		
PW 4-POT-SL	3059731	50
Feed-through terminal block, with engagement pin		
PW 4-POT-SL/S	3059744	50

ZB 8.../ZBF 8... marking material (see CLIPLINE catalog)
 TMT (EX9,5)R marking material (see online catalog)