



TEMPERATURE MONITORING RELAY PT100/1000, KTY83/84, NTC 2 THRESHOLD VALUES, DIGITAL -58 DEGR.F TO 932 DEGR.F 24-240V AC/DC

Figure similar



General technical data:		
<b>Type of voltage</b>		AC/DC
<b>Supply voltage frequency</b>		
<ul style="list-style-type: none"> <li>• 1 for auxiliary and control current circuit</li> <li>— Initial rated value</li> <li>— Final rated value</li> </ul>	Hz	50
	Hz	60
<b>Control supply voltage</b>		
<ul style="list-style-type: none"> <li>• 1</li> <li>— with AC</li> <li>— at 50 Hz Initial rated value</li> <li>— at 50 Hz Final rated value</li> <li>— at 60 Hz Initial rated value</li> <li>— at 60 Hz Final rated value</li> <li>— for DC</li> <li>— Initial rated value</li> <li>— Final rated value</li> </ul>	V	24
	V	240
	V	24
	V	240
	V	24
	V	240
<b>Number of measuring circuits</b>		1
<b>Number of NC contacts for auxiliary contacts</b>		0
<b>Number of NO contacts for auxiliary contacts</b>		1
<b>Number of CO contacts for auxiliary contacts</b>		2
<b>Product function</b>		
<ul style="list-style-type: none"> <li>• Fault storage</li> <li>• External reset</li> </ul>		Yes
		Yes
<b>Measurable Fahrenheit-temperature</b>		
<ul style="list-style-type: none"> <li>• initial value</li> </ul>	°F	-58

• Full-scale value	°F	932
Equipment marking acc. to DIN EN 61346-2		K
Equipment marking acc. to DIN 40719 extended according to IEC 204-2 acc. to IEC 750		K
Ambient temperature during operation	°C	-25 ... +60

#### Mechanical data:

<b>Type of electrical connection</b>		
<ul style="list-style-type: none"> <li>• for auxiliary and control current circuit</li> <li>• Plug-in socket</li> </ul>		spring-loaded terminals Yes
<b>Design of the sensor connectable</b>		PT100/1000, KTY83/84, NTC (resistance sensors)
<b>Width</b>	mm	45
<b>Height</b>	mm	108
<b>Depth</b>	mm	91

#### Certificates/ approvals:

General Product Approval	Test Certificates	other		
		<a href="#">Special Test Certificate</a>	<a href="#">Declaration of Conformity</a>	<a href="#">Environmental Confirmations</a>

#### Further information

##### Information- and Downloadcenter (Catalogs, Brochures,...)

<http://www.siemens.com/industrial-controls/catalogs>

##### Industry Mall (Online ordering system)

<http://www.siemens.com/industrymall>

##### Cax online generator

<http://support.automation.siemens.com/WW/CAXorder/default.aspx?lang=en&mlfb=3RS20402GW50>

##### Service&Support (Manuals, Certificates, Characteristics, FAQs,...)

<http://support.automation.siemens.com/WW/view/en/3RS20402GW50/all>

##### Image database (product images, 2D dimension drawings, 3D models, device circuit diagrams, EPLAN macros, ...)

<http://www.automation.siemens.com/bilddb/index.aspx?attID9=3RS20402GW50&lang=en>

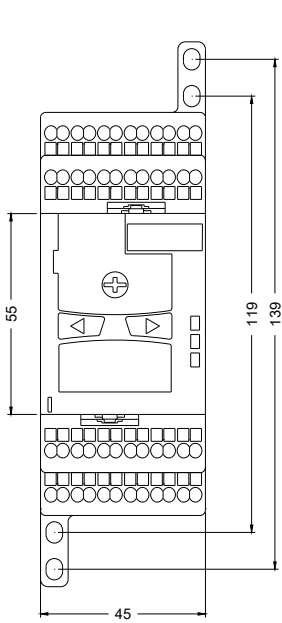

last modified:

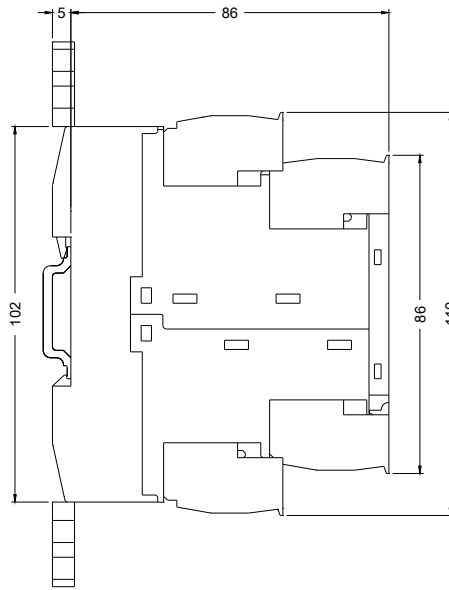

09.03.2015