

# KGM

## Locknuts



Type KGM: Standard nut, plastic



Type KGM: SUB-D9, PB, SUB-D25



Type GMT: Split locknut

### Product description

Hexagonal nut with metric threads for attaching components together.

For routing SUB-D, DVI or PROFIBUS connectors in combination with the split cable glands KVT, special locknuts with cut-outs are required.

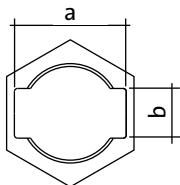

### Specification

Material	Polyamid (PA) / Polycarbonate (PC) / Brass (BR), nickel-plated
Colour	<input type="checkbox"/> grey (similar RAL 7035) <input type="checkbox"/> black <input type="checkbox"/> Brass
Flame class	UL94-Vo, self-extinguishing
Temperature	- 30°C to + 120°C
Properties	Halogen-free, silicone-free

### Accessories

KVT, KVT-SNAP, KVT-W90	
Split cable glands	Page 22 - 26
QVT Split cable glands	Page 42
KEL-DPZ Cable entry plates	Page 56 - 57
KEL-DPF Cable entry inserts	Page 61

Thread	Type	Order No.	Material	Height [mm]	Wrench size	Diagonal [mm]	Cut-out a×b[mm]	PU
--------	------	-----------	----------	-------------	-------------	---------------	-----------------	----

#### Type KGM: Standard nut, plastic

M20 × 1.5	KGM 20	<input type="checkbox"/> 52273	PA	7.0	SW 26	28.2	-	10
		<input type="checkbox"/> 52283						
M25 × 1.5	KGM 25	<input type="checkbox"/> 52274	PA	7.0	SW 32	36	-	10
		<input type="checkbox"/> 52284						
M32 × 1.5	KGM 32	<input type="checkbox"/> 52275	PA	7.0	SW 41	46	-	10
		<input type="checkbox"/> 52285						
M40 × 1.5	KGM 40	<input type="checkbox"/> 52276	PA	7.0	SW 50	56	-	10
		<input type="checkbox"/> 52286						
M50 × 1.5	KGM 50	<input type="checkbox"/> 52277	PA	8.6	SW 60	66	-	10
		<input type="checkbox"/> 52287						
M63 × 1.5	KGM 63	<input type="checkbox"/> 52278	PA	8.6	SW 75	83	-	5
		<input type="checkbox"/> 52288						
M63 × 1.5	GM 63	<input type="checkbox"/> 56152	BR	5.5	SW 70	78	-	5

#### Type KGM: PB, SUB-D9, SUB-D25

M32 × 1.5	KGM-SUB-D9	<input type="checkbox"/> 45105	PC	7.0	SW 41	46	35 × 16	10
		<input type="checkbox"/> 45106						
M40 × 1.5	KGM-PB	<input type="checkbox"/> 45107	PC	8.0	SW 50	55	43 × 17	10
		<input type="checkbox"/> 45109						
M50 × 1.5	KGM-SUB-D25	<input type="checkbox"/> 45108	PC	8.0	SW 60	66	55 × 16	10
		<input type="checkbox"/> 45110						

#### Type GMT: Split locknut

M20 × 1.5	GMT 20	<input type="checkbox"/> 31110	PA	9.0	SW 27	29	-	10
M25 × 1.5	GMT 25	<input type="checkbox"/> 31100	PA	9.0	SW 32	35	-	10
M32 × 1.5	GMT 32	<input type="checkbox"/> 31120	PA	12.0	SW 40	44	-	10
M50 × 1.5	GMT 50	<input type="checkbox"/> 31140	PA	15.0	SW 63	69	-	10