

E11115

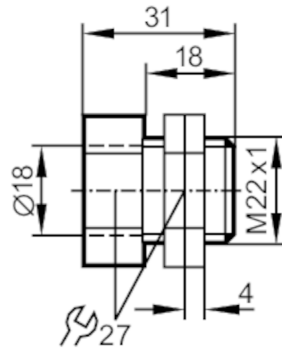

Mounting sleeve with end stop

FIXING/M18/MODUL/MS/END STOP



Application

Design	with end stop
--------	---------------

Mechanical data

Weight	[g]	66.8
Dimensions	[mm]	M22 x 1
Thread designation		M22 x 1
Inside diameter	[mm]	18
Materials		brass white bronze coated
Installation instruction		align the sensing face of the sensor to the right (see scale drawing)
Tightening torque	[Nm]	7; (lock nuts: 20)

Remarks

Pack quantity	1 pcs.
---------------	--------