

Specification:

Rated current	45A
Rated voltage	600V
Insulation Resistance	1000MΩ
Contact Resistance	<500μΩ
Voltage Proof	2200VDC
Life: Without Load(Contact/Disconnect Cycles)	To 10000
Life: With Load(Hot Plug 250 Cycles & 120V)	20A
Flammability	UL94 V-0
Insertion Force	≥0.5kgf
Pullout Force	≥1kgf
Contact Barrel Wire Size	6AWG~12AWG
Connector Holding Force	250N Min
Environment Temperatures	-20°C...125°C

Material and Surface Performance:**Housing**

Housing Material	PC
Process of Production	Plastic Injection

Shrapnel

Shrapnel Material	Stainless Steel
Process of Production	Precision Punching

Terminal

Terminal Material	Red Copper
Process of Production	Precision Punching
Plating	Tin

Housing

Part Number	Housing Colour	Part Number	Housing Colour
RND 205SD45H-BL	Black	RND 205SD45H-GR	Green
RND 205SD45H-BR	Brown	RND 205SD45H-RE	Red
RND 205SD45H-BU	Blue	RND 205SD45H-WH	White

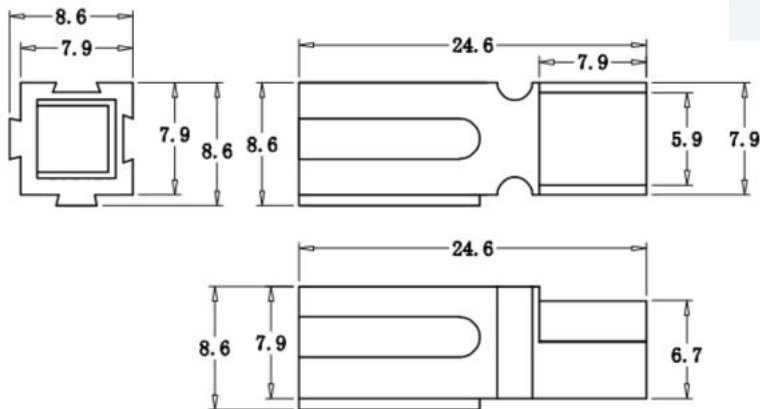

Terminal

Part Number	-A-(mm)	-B-(mm)	-C-(mm)	-D-(mm)	-E-(mm)	Wire	Plating
RND 205SGD261G2	17.3	6.3	5.6	5.0	11.5	10/14AWG	Tin
RND 205SGD261G1	17.3	6.3	5.0	4.6	11.5	12/16AWG	Tin
RND 205SGD262G1	17.3	6.3	3.6	3.9	11.5	16/20AWG	Tin
RND 205SGD1331-T	16.2	7.7	2.8	4.0	-	12/16AWG	Tin

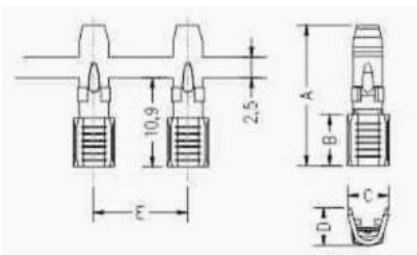

Sheath

Part Number	Housing Colour
RND 205SD101L1	Black

