

- 1
- 2
- 3
- 4
- 5
- 6
- 7
- 8
- 9
- 10
- 11
- 12
- 13
- 14
- 15
- 16
- 17
- 18

STANDARD EXECUTIONS

Zinc-plated steel.

FEATURES AND APPLICATIONS

GN 505.4 dowels for T-slots are suitable for use on aluminium sections for quick insert.

Inserting the dowel upright into the T-slot and rotating it clockwise by 90°, the toothing will insert into the profile to secure fitting. To remove the dowel from the slot, rotate it anticlockwise by 90°.

Application example

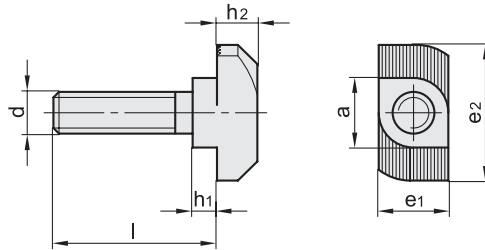
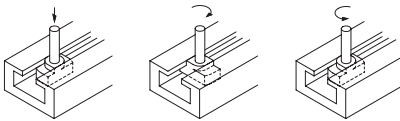

Code	Description	a-0.1-0.6	d	l	e1	e2	h1	h2	
GN.24351	GN 505.4-8-M6-20-1.6	8	M6	20	7.9-0.5	16 +0.5/-1	1.6-0.6	5 ±1	7
GN.24353	GN 505.4-8-M6-25-1.6	8	M6	25	7.9-0.5	16 +0.5/-1	1.6-0.6	5 ±1	10
GN.24355	GN 505.4-8-M6-30-1.6	8	M6	30	7.9-0.5	16 +0.5/-1	1.6-0.6	5 ±1	13
GN.24352	GN 505.4-8-M6-20-3.5	8	M6	20	7.9-0.5	16 +0.5/-1	3.5-1	5 ±1	8
GN.24354	GN 505.4-8-M6-25-3.5	8	M6	25	7.9-0.5	16 +0.5/-1	3.5-1	5 ±1	11
GN.24356	GN 505.4-8-M6-30-3.5	8	M6	30	7.9-0.5	16 +0.5/-1	3.5-1	5 ±1	14
GN.24357	GN 505.4-8-M8-20-1.6	8	M8	20	7.9-0.5	16 +0.5/-1	1.6-0.6	5 ±1	8
GN.24359	GN 505.4-8-M8-25-1.6	8	M8	25	7.9-0.5	16 +0.5/-1	1.6-0.6	5 ±1	11
GN.24361	GN 505.4-8-M8-30-1.6	8	M8	30	7.9-0.5	16 +0.5/-1	1.6-0.6	5 ±1	14
GN.24358	GN 505.4-8-M8-20-3.5	8	M8	20	7.9-0.5	16 +0.5/-1	3.5-1	5 ±1	9
GN.24360	GN 505.4-8-M8-25-3.5	8	M8	25	7.9-0.5	16 +0.5/-1	3.5-1	5 ±1	12
GN.24362	GN 505.4-8-M8-30-3.5	8	M8	30	7.9-0.5	16 +0.5/-1	3.5-1	5 ±1	15
GN.24363	GN 505.4-10-M6-20-1.6	10	M6	20	10 0/-2.5	19 +0.5/-2	1.6-0.6	6.5-1.5	8
GN.24365	GN 505.4-10-M6-25-1.6	10	M6	25	10 0/-2.5	19 +0.5/-2	1.6-0.6	6.5-1.5	11
GN.24367	GN 505.4-10-M6-30-1.6	10	M6	30	10 0/-2.5	19 +0.5/-2	1.6-0.6	6.5-1.5	14
GN.24364	GN 505.4-10-M6-20-3.5	10	M6	20	10 0/-2.5	19 +0.5/-2	3.5-1	6.5-1.5	9
GN.24366	GN 505.4-10-M6-25-3.5	10	M6	25	10 0/-2.5	19 +0.5/-2	3.5-1	6.5-1.5	12
GN.24368	GN 505.4-10-M6-30-3.5	10	M6	30	10 0/-2.5	19 +0.5/-2	3.5-1	6.5-1.5	15
GN.24369	GN 505.4-10-M8-20-1.6	10	M8	20	10 0/-2.5	19 +0.5/-2	1.6-0.6	6.5-1.5	9
GN.24371	GN 505.4-10-M8-25-1.6	10	M8	25	10 0/-2.5	19 +0.5/-2	1.6-0.6	6.5-1.5	12
GN.24373	GN 505.4-10-M8-30-1.6	10	M8	30	10 0/-2.5	19 +0.5/-2	1.6-0.6	6.5-1.5	15
GN.24370	GN 505.4-10-M8-20-3.5	10	M8	20	10 0/-2.5	19 +0.5/-2	3.5-1	6.5-1.5	10
GN.24372	GN 505.4-10-M8-25-3.5	10	M8	25	10 0/-2.5	19 +0.5/-2	3.5-1	6.5-1.5	13
GN.24374	GN 505.4-10-M8-30-3.5	10	M8	30	10 0/-2.5	19 +0.5/-2	3.5-1	6.5-1.5	16

Machine elements