

Nuts Screws Washers and Bolts

Order code	Manufacturer code	Description
33-5018	0010057	M4X25 CHEESE HEAD SCREW PACK 100(RC)

Nuts Screws Washers and Bolts	Page 1 of 3
The enclosed information is believed to be correct, Information may change without notice due to product improvement. Users should ensure that the product is suitable for their use. E. & O. E.	Revision A 20/02/2007

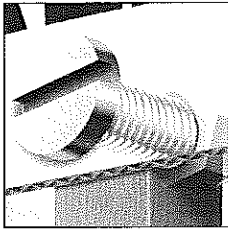

Cheese Head Slotted Metric Machine Screws

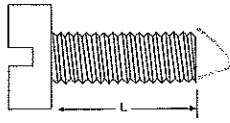

PART NUMBER	Thread Size	L Length	Unit Quantity	PART NUMBER	Thread Size	L Length
001 0001	M2 x .4	4	1,000	001 0064	M5 x .8	6
001 0002	M2 x .4	5	1,000	001 0065	M5 x .8	8
001 0003	M2 x .4	6	1,000	001 0066	M5 x .8	10
001 0004	M2 x .4	8	1,000	001 0067	M5 x .8	12
001 0005	M2 x .4	10	1,000	001 0068	M5 x .8	16
001 0006	M2 x .4	12	1,000	001 0069	M5 x .8	20
001 0007	M2 x .4	16	1,000	001 0070	M5 x .8	25
001 0009	M2 x .4	20	1,000	001 0071	M5 x .8	30
001 0010	M2 x .4	25	1,000	001 0072	M5 x .8	35
001 0014	M2.5 x .45	4	1,000	001 0073	M5 x .8	40
001 0015	M2.5 x .45	5	1,000	001 0075	M5 x .8	50
001 0016	M2.5 x .45	6	1,000	001 0076	M6 x 1.0	5
001 0017	M2.5 x .45	8	1,000	001 0077	M6 x 1.0	6
001 0018	M2.5 x .45	10	1,000	001 0078	M6 x 1.0	8
001 0019	M2.5 x .45	12	1,000	001 0079	M6 x 1.0	10
001 0020	M2.5 x .45	16	1,000	001 0080	M6 x 1.0	12
001 0021	M2.5 x .45	20	1,000	001 0081	M6 x 1.0	16
001 0022	M2.5 x .45	25	1,000	001 0082	M6 x 1.0	20
001 0024	M3 x .5	3	1,000	001 0083	M6 x 1.0	25
001 0025	M3 x .5	4	1,000	001 0084	M6 x 1.0	30
001 0026	M3 x .5	5	1,000	001 0085	M6 x 1.0	35
001 0027	M3 x .5	6	1,000	001 0086	M6 x 1.0	40
001 0028	M3 x .5	8	1,000	001 0087	M6 x 1.0	45
001 0029	M3 x .5	10	1,000	001 0088	M6 x 1.0	50
001 0030	M3 x .5	12	1,000	001 0090	M6 x 1.0	60
001 0031	M3 x .5	16	1,000	001 0092	M6 x 1.0	70
001 0032	M3 x .5	20	1,000	001 0093	M6 x 1.0	75
001 0033	M3 x .5	25	1,000	001 0095	M8 x 1.25	10
001 0034	M3 x .5	30	1,000	001 0096	M8 x 1.25	16
001 0050	M4 x .7	5	1,000	001 0097	M8 x 1.25	20
001 0051	M4 x .7	6	1,000	001 0098	M8 x 1.25	25
001 0052	M4 x .7	8	1,000	001 0099	M8 x 1.25	30
001 0053	M4 x .7	10	1,000	001 0100	M8 x 1.25	35
001 0054	M4 x .7	12	1,000	001 0101	M8 x 1.25	40
001 0055	M4 x .7	16	1,000	001 0103	M8 x 1.25	50
001 0056	M4 x .7	20	1,000	001 0104	M8 x 1.25	60
001 0057	M4 x .7	25	1,000	001 0105	M8 x 1.25	70
001 0058	M4 x .7	30	1,000	001 0106	M8 x 1.25	80
001 0059	M4 x .7	35	1,000	001 0107	M10 x 1.5	16
001 0060	M4 x .7	40	1,000	001 0108	M10 x 1.5	20
				001 0109	M10 x 1.5	25
				001 0110	M10 x 1.5	30
				001 0111	M10 x 1.5	35
				001 0112	M10 x 1.5	40
				001 0114	M10 x 1.5	50
				001 0116	M10 x 1.5	60
				001 0118	M10 x 1.5	70

Material: Nylon 66
Colour: Natural

RoHS Directive 2002/95/EC compliant

Head Type

Dim

Screw Size

CHEESE

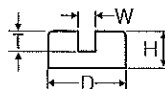

	M2	M2.5	M3	M4	M5	M6	M8
D	3.80	4.50	5.50	7.00	8.50	10.00	13.00
H	1.30	1.60	2.00	2.60	3.30	3.90	5.00
T	0.90	1.00	1.30	1.60	2.00	2.30	2.80
W	0.70	0.80	1.00	1.20	1.50	1.90	2.30

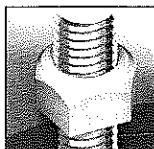

See pages 6-11 & 6-12 for our range of metric nuts

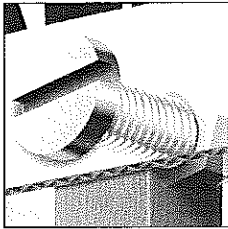

Cheese Head Slotted Metric Machine Screws

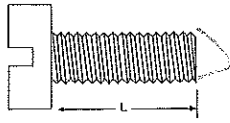

PART NUMBER	Thread Size	L Length	Unit Quantity	PART NUMBER	Thread Size	L Length
001 0001	M2 x .4	4	1,000	001 0064	M5 x .8	6
001 0002	M2 x .4	5	1,000	001 0065	M5 x .8	8
001 0003	M2 x .4	6	1,000	001 0066	M5 x .8	10
001 0004	M2 x .4	8	1,000	001 0067	M5 x .8	12
001 0005	M2 x .4	10	1,000	001 0068	M5 x .8	16
001 0006	M2 x .4	12	1,000	001 0069	M5 x .8	20
001 0007	M2 x .4	16	1,000	001 0070	M5 x .8	25
001 0009	M2 x .4	20	1,000	001 0071	M5 x .8	30
001 0010	M2 x .4	25	1,000	001 0072	M5 x .8	35
001 0014	M2.5 x .45	4	1,000	001 0073	M5 x .8	40
001 0015	M2.5 x .45	5	1,000	001 0075	M5 x .8	50
001 0016	M2.5 x .45	6	1,000	001 0076	M6 x 1.0	5
001 0017	M2.5 x .45	8	1,000	001 0077	M6 x 1.0	6
001 0018	M2.5 x .45	10	1,000	001 0078	M6 x 1.0	8
001 0019	M2.5 x .45	12	1,000	001 0079	M6 x 1.0	10
001 0020	M2.5 x .45	16	1,000	001 0080	M6 x 1.0	12
001 0021	M2.5 x .45	20	1,000	001 0081	M6 x 1.0	16
001 0022	M2.5 x .45	25	1,000	001 0082	M6 x 1.0	20
001 0024	M3 x .5	3	1,000	001 0083	M6 x 1.0	25
001 0025	M3 x .5	4	1,000	001 0084	M6 x 1.0	30
001 0026	M3 x .5	5	1,000	001 0085	M6 x 1.0	35
001 0027	M3 x .5	6	1,000	001 0086	M6 x 1.0	40
001 0028	M3 x .5	8	1,000	001 0087	M6 x 1.0	45
001 0029	M3 x .5	10	1,000	001 0088	M6 x 1.0	50
001 0030	M3 x .5	12	1,000	001 0090	M6 x 1.0	60
001 0031	M3 x .5	16	1,000	001 0092	M6 x 1.0	70
001 0032	M3 x .5	20	1,000	001 0093	M6 x 1.0	75
001 0033	M3 x .5	25	1,000	001 0095	M8 x 1.25	10
001 0034	M3 x .5	30	1,000	001 0096	M8 x 1.25	16
001 0050	M4 x .7	5	1,000	001 0097	M8 x 1.25	20
001 0051	M4 x .7	6	1,000	001 0098	M8 x 1.25	25
001 0052	M4 x .7	8	1,000	001 0099	M8 x 1.25	30
001 0053	M4 x .7	10	1,000	001 0100	M8 x 1.25	35
001 0054	M4 x .7	12	1,000	001 0101	M8 x 1.25	40
001 0055	M4 x .7	16	1,000	001 0103	M8 x 1.25	50
001 0056	M4 x .7	20	1,000	001 0104	M8 x 1.25	60
001 0057	M4 x .7	25	1,000	001 0105	M8 x 1.25	70
001 0058	M4 x .7	30	1,000	001 0106	M8 x 1.25	80
001 0059	M4 x .7	35	1,000	001 0107	M10 x 1.5	16
001 0060	M4 x .7	40	1,000	001 0108	M10 x 1.5	20
				001 0109	M10 x 1.5	25
				001 0110	M10 x 1.5	30
				001 0111	M10 x 1.5	35
				001 0112	M10 x 1.5	40
				001 0114	M10 x 1.5	50
				001 0116	M10 x 1.5	60
				001 0118	M10 x 1.5	70

Material: Nylon 66
Colour: Natural

RoHS Directive 2002/95/EC compliant

Head Type

Dim

Screw Size

CHEESE

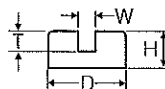

	M2	M2.5	M3	M4	M5	M6	M8
D	3.80	4.50	5.50	7.00	8.50	10.00	13.00
H	1.30	1.60	2.00	2.60	3.30	3.90	5.00
T	0.90	1.00	1.30	1.60	2.00	2.30	2.80
W	0.70	0.80	1.00	1.20	1.50	1.90	2.30

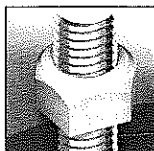

See pages 6-11 & 6-12 for our range of metric nuts