

EAO – Your Expert Partner for Human Machine Interfaces

61-9933.1 - Front bezel set for indicator, pushbutton, illuminated pushbutton, flush design

61-9933.1 - Front bezel set for indicator, pushbutton, illuminated pushbutton, flush design



Attention: The preview is based on a sample product. This can differ from your current configuration.

Mounting

Mounting cut-out Ø 22,3 mm
Design flush

Front

Front bezel material Aluminium
Front bezel colour black
Front dimension Ø 25 mm
Front shape round

Other Attributes

Weight 0,006 kg

Actuator

Housing colour black
Housing material Aluminium

EAO – Your Expert Partner for Human Machine Interfaces

61-9933.1 - Front bezel set for indicator, pushbutton, illuminated pushbutton, flush design

Mounting cut-outs

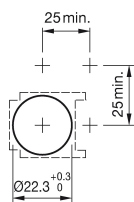

X = Screw terminal

Additional information

The colour of anodized aluminium parts can vary due to technical production reasons