



### Features

- Magnetically operated position sensor
- Matching actuator available
- Compact size requires only 3.2cm<sup>2</sup> board space
- Screw down or adhesive mounting
- Customer defined sensitivity
- Choice of cable length and connector
- Leads can exit from LH or RH side

### Benefits

- No standby power requirement
- Operates through non-ferrous materials such as wood, plastic or aluminium
- Hermetically sealed, magnetically operated contacts continue to operate long after optical and other technologies fail due to contamination

### Applications

- Position and limit sensing
- Security system switch
- Linear actuators
- Door switch

### DIMENSIONS (in) mm

#### Actuator

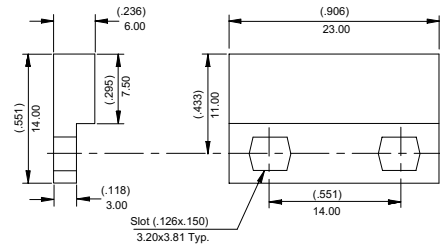

#### Sensor (2 wire versions)

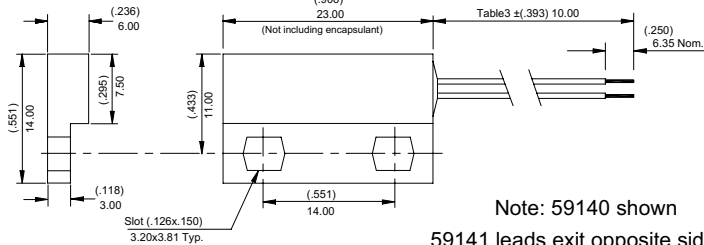

### SCHEMATICS

#### Switch Types 1 & 2

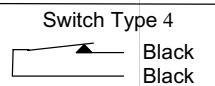
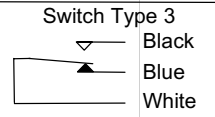
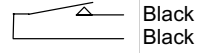

### CUSTOMER OPTIONS - Switching Specifications

TABLE 1	Switch Type	Select Option	1	2	3	4
		Contact Type	Normally Open	Normally Open High V.	Change Over	Normally Closed
Contact Rating	Power	Watts - max	10	10	5	5
Voltage	Switching	Vdc - max.	200	300	175	175
	Breakdown	Vdc - min.	250	450	200	200
Current	Switching	A - max.	0.5	0.5	0.25	0.25
	Carry	A - max.	1.2	1.5	1.5	1.5
Resistance	Contact, Initial	Ohms - max.	0.2	0.2	0.2	0.2
	Insulation	Ohms - min.	10 <sup>10</sup>	10 <sup>10</sup>	10 <sup>9</sup>	10 <sup>9</sup>
Temperature	Operating	°C	-40 to +105	-20 to +105	-40 to +105	-40 to +105
	Storage	°C	-65 to + 105	-65 to +105	-65 to +105	-65 to +105
Time	Operate	ms - max.	1.0	1.0	3.0	3.0
	Release	ms - max.	1.0	1.0	3.0	3.0
Capacitance	Contact	pF - typ.	0.3	0.2	0.3	0.3
Shock	11ms ½ sine	G - max.	100	100	50	50
Vibration	50-2000 Hz.	G - max.	30	30	30	30

### CUSTOMER OPTIONS - Sensitivity, Cable Length and Termination Specifications

TABLE 2	Sensitivity				TABLE 3	Cable Length		TABLE 4	Termination (2 wire versions shown)					
	Select Option	S	T	U		Select Option	Description		Diagram	Select Option	Description	Diagram		
Activate distances (d) are approximate using Hamlin 57140-000 actuator as illustrated.	Switch Type	Pull-In AT Range	Activate Distance (d) (in)mm	Pull-In AT Range	Activate Distance (d) (in)mm	Pull-In AT Range	Activate Distance (d) (in)mm	Select Option	Description	Diagram	Diagram			
												Switch Type	Pull-In AT Range	Activate Distance (d) (in)mm
Switch AT before modification	1	12-18	(.453)	17-23	(.374)	22-28	(.315)	27-33	(.295)	01	(3.94) 100	A	Tinned leads	
	2	11.5	9.5	9.5	8.0	7.5				02	(11.81) 300	C	6.35mm fastons	
	3	(.413)	(.354)	(.295)						03	(19.69) 500	D	AMP MTE 2.54mm	
	4	15-20	10.5	9.0	7.5					04	(29.53) 750	E	JST XHP 2.5mm	
										05	(39.37) 1,000	F	Untinned leads	

### ORDERING INFORMATION

