

Product data					
Product code	<b>VG03-0052</b>	STK-code	<b>1914357</b>	EAN-code	<b>6430051860317</b>
Product name	OJL-connector 135			ETIM class	<b>EC000276</b>
Wires	IN 1x(Al/Cu) 2,5-35 mm <sup>2</sup> / 1x (Al/Cu) 2,5-10 mm <sup>2</sup> OUT: 4x (Cu) 2,5-16mm <sup>2</sup> / 2x (Cu) 2,5-10 mm <sup>2</sup>				

Technical data				
Nominal current (IEC)	Cu	<b>135</b>	A	
	Al	<b>120</b>	A	
Nominal voltage (IEC)		<b>1000</b>	V	
		-		
		-		
Number of poles		<b>1</b>	pcs	
Max. Cross section		<b>35</b>	mm <sup>2</sup>	
Tightening torque		-		
	2,5-16 mm <sup>2</sup> (M6)	<b>3</b>	Nm	
	25-35 mm <sup>2</sup> (M8)	<b>6</b>	Nm	
		-		
		-		
Input	<b>1x Al/Cu 2,5-35 mm<sup>2</sup>, 1x Al/Cu 2,5-10 mm<sup>2</sup></b>			
Output	<b>4x Cu 2,5-16 mm<sup>2</sup>, 2x Cu 2,5-10 mm<sup>2</sup></b>			
		-		
Operating temperature		<b>80</b>	°C	
Weight		<b>75</b>	g	
IP-protection		<b>IP20</b>		
Standards	<b>EN 61238-1; EN 60947-7-1</b>			
Color / Material	<b>Black Cover PC, Grey Housing RAL 7035 PA66/V0, Connector part tin plated aluminium</b>			
Mounting / Connection	<b>Din rail and 2x screw (M5) mounting</b>			



**Description**

The single pole distribution block for branching connection. Distribution block with 2 inputs and it will distribute the current through 6 output cables. Connector is made from tin plated aluminium and housing is PA66 V0.

**Drawing**

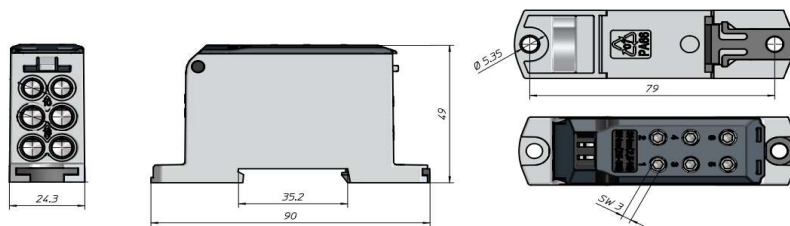

Package					
Package	<b>Box</b>	Pcs / Package	<b>20</b>	Weight [kg]	<b>1,50</b>
Length [mm]	<b>300</b>	Width [mm]	<b>205</b>	Height [mm]	<b>100</b>

**Ouneva Oy**  
Teollisuustie 21  
FI-82730 Tuupovaara  
Finland

Tel. +358 400 179 750  
[info@ouneva.fi](mailto:info@ouneva.fi)

[www.ounevagroup.fi](http://www.ounevagroup.fi)  
[www.ounevaproducs.fi](http://www.ounevaproducs.fi)