

# HF-Matchbox Blue

## HF-M BLUE 114 LH TL/PL-S/PL-C 230-240V

HF-Matchbox Blue is an affordable, reliable, compact, lightweight and high-frequency ballast for use with system wattages below 25 W in combination with TL mini, TL-D, TL5 and TL5c, PL-T/C, and PL-L/S lamps. The HF-M Blue range has a robust design, meets all relevant international safety and performance standards and has an energy efficiency index (CELMA EEI ) of A2.;The ballast is primarily designed for Indoor application. For outdoor application, the luminaire should be minimum Classland need to be sufficiently protected against water & dust. The installation should also be guard against any lightening surge or any other necessary electrical protection as deemed in such typical installation & application.

### Product data

General Information	
Lamp Type	TL/PL-S/PL-C
Number of Lamps	1 piece/unit
Number of Products on MCB (16A Type B) (Nom)	101
Automatic Restart	Yes
Operating and Electrical	
Input Voltage	230 to 240 V
Input Frequency	50 to 60 Hz
Power Factor 100% Load (Nom)	0.64
Ignition Time (Max)	0.5 s
Mains Voltage Performance (AC)	-8%~+6%
Mains Voltage Safety (AC)	-10%~+10%
Power Losses (Nom)	2.9 W
Wiring	
Connector Type Input Terminals	Insert

Color Input Terminals	Gray
Color Output Terminals	Grey
Connector Type Output Terminals	Insert
Cable Length From Device to Lamp	1.50 m
Cable Length Hot Wiring	0.30 m
Wire Striplength	8.0-9.0 mm
Input Terminal Cross Section	0.50-1.50 mm <sup>2</sup>
Output Terminal Cross Section	0.50-1.50 mm <sup>2</sup>
System characteristics	
Rated Ballast-Lamp Power	14 W
System Power on PL-S	14.1 W
Rated Lamp Power on PL-S	14 W
Power Loss on PL-S	2.2 W
Lamp Power on PL-S	11.9 W
System Power on PL-C	14.6 W
Rated Lamp Power on PL-C	14 W
Power Loss on PL-C	2.4 W

## HF-Matchbox Blue

Lamp Power on PL-C	12.2 W
Lamp Power on TL	11.8 W
Rated Lamp Power on TL	14 W
System Power on TL	15.7 W

### Temperature

T-Ambient (Max)	40 °C
T-Ambient (Min)	-10 °C
T-Case Maximum (Max)	75 °C

### Mechanical and Housing

Housing	LH
---------	----

### Emergency Operation

Battery Voltage Lamp Ignition	194-254 V
-------------------------------	-----------

### Approval and Application

IP Classification	IP 20 [ Ingress Protection 20]
-------------------	--------------------------------

Approval Marks	F-Marking CE marking VDE certificate CB Certificate
----------------	--

### Product Data

Full product code	871150053682230
Order product name	HF-M BLUE 114 LH TL/PL-S/PL-C 230-240V
EAN/UPC - Product	8711500536822
Order code	913700421766
Numerator - Quantity Per Pack	1
Numerator - Packs per outer box	50
Material Nr. (12NC)	913700421766
Net Weight (Piece)	0.036 kg

## Dimensional drawing

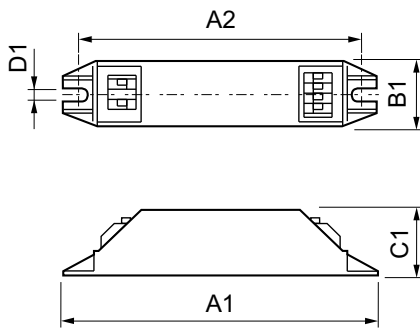

HF-M BLUE 114 LH TL/PL-S/PL-C 230-240V

### Product

HF-M BLUE 114 LH TL/PL-S/PL-C 230-240V

