

## Technical data sheet

EMC Accessories · Snap-on Element

---

**Snap-on element for snapping onto DIN rail  
for attaching a grounding clamp**



---

### Identification

Type	EMVRE H 1
Part-No.	330088.0010

---

### Product version

Datasheet version	00
-------------------	----

---

### Technical data

Length	18 mm
--------	-------

---

### Connecting lead

Description	Snap-on element
-------------	-----------------

---

### General

Material	Sheet steel
Surface	polished
Color	polished
Operation temperature range	-20 °C ... +60 °C
Weight/100 units	0.7 kg
PU (units)	10
Note	Attenuation measurement: shield contact on DIN rail (see diagram)

---

### Notes and Comments

Comments	Suitable for all crosspieces and DIN profile TS35
----------	---

---

#### United Kingdom: LÜTZE Ltd.

Unit 3, Sandy Hill Park  
Sandy Way, Amington • GB-Tamworth, Staffs B77 4DU  
Tel. +44 (0)1827 31333-0 • Fax +44 (0)1827 31333-2  
www.lutze.com • sales.gb@lutze.co.uk

#### Germany: Friedrich Lütze GmbH

Postfach 12 24 (PLZ 71366) • Bruckwiesenstraße 17-19 • D-71384 Weinstadt  
Tel. +49 (0)7151 6053-0 • Fax +49 (0)7151 6053-277(-288)  
www.luetze.de • info@luetze.de

21.04.2021 • Subject to technical modification  
Part-No. 330088.0010 • Datasheet version: 00

Dimensions

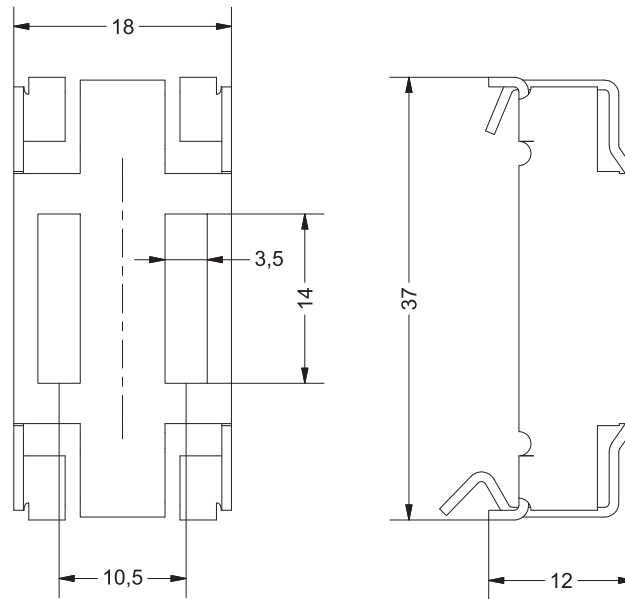

Use

