

GN 598 | Revolving handles

Steel



MATERIAL

Steel, epoxy resin coating, RAL 9005 black colour, matte finish.

STANDARD EXECUTION

Zinc-plated steel pin, hexagon socket at threaded end.

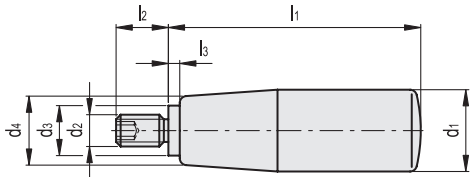

Code	Description	d1	d2	d3	d4	l1	l2	l3	⚖️
GN.28091	GN 598-ST-21-M6	21	M6	10	17	52.5	13	2.5	120
GN.28092	GN 598-ST-21-M8	21	M8	10	17	52.5	13	2.5	122
GN.28101	GN 598-ST-23-M8	23	M8	13	19	67.5	14	2.5	188
GN.28102	GN 598-ST-23-M10	23	M10	13	19	67.5	14	2.5	190
GN.28111	GN 598-ST-26-M8	26	M8	13	21	82.5	16	2.5	295
GN.28112	GN 598-ST-26-M10	26	M10	13	21	82.5	16	2.5	298
GN.28121	GN 598-ST-28-M10	28	M10	13	22	92.5	16	2.5	390
GN.28131	GN 598-ST-31-M12	31	M12	14	25	104.5	20	2.5	563

GN 798 | Revolving handles

Aluminium



MATERIAL

Turned and mirror polished aluminium.

STANDARD EXECUTION

Zinc-plated steel pin, hexagon socket at threaded end.

SPECIAL EXECUTIONS ON REQUEST

Shank with different threadings.

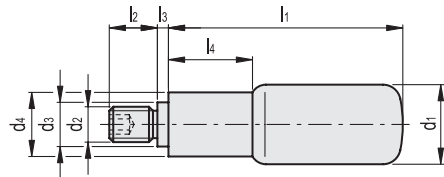

Code	Description	d1	d2	d3	d4	l1	l2	l3	l4	⚖️
GN.11191	GN 798-AL-16-M6	16	M6	10	13	41.5	12	2.5	15	38
GN.11195	GN 798-AL-18-M6	18	M6	10	14.5	56	13	2.5	19	50
GN.11196	GN 798-AL-18-M8	18	M8	10	14.5	56	13	2.5	19	53
GN.11200	GN 798-AL-22-M6	22	M6	14	18.5	59	14	2.5	21	60
GN.11201	GN 798-AL-22-M8	22	M8	14	18.5	59	14	2.5	21	60
GN.11202	GN 798-AL-22-M10	22	M10	14	18.5	59	14	2.5	21	63
GN.11204	GN 798-AL-24-M8	24	M8	14	18.5	74	16	2.5	27	72
GN.11205	GN 798-AL-24-M10	24	M10	14	18.5	74	16	2.5	27	75
GN.11211	GN 798-AL-25-M10	25	M10	16	20	84	16	2.5	30	90

- 1
- 2
- 3
- 4
- 5
- 6
- 7
- 8
- 9
- 10
- 11
- 12
- 13
- 14
- 15
- 16
- 17
- 18

Fixed & Revolving handles