

Product data sheet

Subminiature connectors



Product description	Snap-In Female cable connector, Contacts: 5, unshielded, moulded on the cable, IP40, PVC, black, 5 x 0.25 mm², 2 m
Area	Snap-In IP40 series 709
Part no.	77 7096 0000 10005-0200

Illustration



Scale drawing

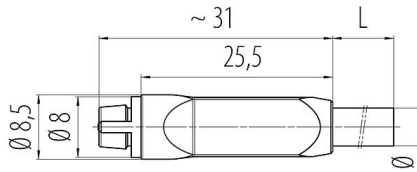

Contact arrangement (Plug-in side)

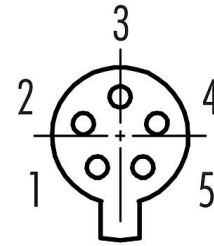

- 1 brown
- 2 white
- 3 blue
- 4 black
- 5 grey

Technical data

General features

Part no.	77 7096 0000 10005-0200
	Alternative part no.: 79 9006 12 05
Connector design	Female cable connector
Cable length	2 m
Version	Connector socket straight
Connector locking system	snap-in
Termination	moulded on the cable
Degree of protection	IP40
Cross-sectional area	0.25 mm ² / AWG 24
Temperature range from/to	-25 °C / 70 °C
Mechanical operation	> 100 Mating cycles
Weight (g)	78.50
Customs tariff number	85444290
Country of Origin	DE

Electrical parameters

Rated voltage	60 V
Rated impulse voltage	800 V
Rated current	3,0 A
Insulation resistance	≥ 10 ¹⁰ Ω
Pollution degree	1
Overvoltage category	II
Insulating material group	III
EMC compliance	unshielded

Material

Housing material	PUR
Contact body material	PA
Contact material	CuSn (bronze)
Contact plating	Au (gold)

Product data sheet

Subminiature connectors



Product description	Snap-In Female cable connector, Contacts: 5, unshielded, moulded on the cable, IP40, PVC, black, 5 x 0.25 mm², 2 m
Area	Snap-In IP40 series 709
Part no.	77 7096 0000 10005-0200

REACH SVHC	CAS 7439-92-1 (Lead)
SCIP number	d7133bf3-c0a0-4e8d-b486-79d446c609b4

Classifications

eCl@ss 11.1	27-06-03-11
ETIM 9.0	EC002638

Declarations of conformity

Low Voltage Directive	2014/35/EU (EN 60204-1:2018;EN 60529:1991)
RoHS Directive	2011/65/EU (EN 50581:2012)

Cable data - Structure of the cable

Cable diameter	5.0 mm
Cross section	5 x 0.25 mm ²
Sheath material	PVC
Single-lead insulation	PVC
Single-lead structure	14 x 0.15 mm
Cable color	black

Cable data - Electrical properties

Conductor resistance	79.9 Ω/Km (20°C)
----------------------	------------------

Cable data - Mechanical properties

Bending radius, fixed cable	5 x Ø
Bending radius, moving cable	10 x Ø

Cable data - Thermal properties

Temperature range cable in move from/to	-5 °C / 70 °C
Temperature range cable fixed from/to	-25 °C / 70 °C

Cable data - Other features

Halogen free	no
--------------	----

Product data sheet

Subminiature connectors



Product description	Snap-In Female cable connector, Contacts: 5, unshielded, moulded on the cable, IP40, PVC, black, 5 x 0.25 mm², 2 m
-	-
Area	Snap-In IP40 series 709
Part no.	77 7096 0000 10005-0200

Security notices

The connector must not be plugged or unplugged under load. Non-observance and improper use can result in personal injury.

The connectors have been developed for applications in plant engineering, control and electrical equipment construction. The user is responsible for checking whether the connectors can also be used in other areas of application.