

STANDARD EXECUTIONS

Zinc-plated steel.

- **GN 505-MB**: with slightly out of shape through threading.
- **GN 505-OB**: with through threading.

FEATURES AND APPLICATIONS

GN 505 dowels for T-slots are suitable for use on aluminium sections for quick insert. Inserting the dowel upright into the T-slot and rotating it clockwise by 90°, the tothing will insert into the profile to secure fitting. GN 505-MB, thanks to the slight deformation of the thread for higher torque, offers a more secure fitting of the dowel. To remove the dowel from the slot, rotate it anticlockwise by 90°.

Application example

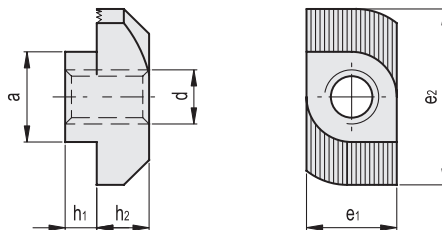
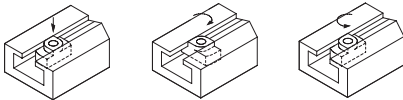

Code	Description	a-0.1-0.5	d	e1-0.1-0.5	e2±0.5	h1	h2	△
GN.24301	GN 505-8-M4-MB	8	M4	8	16	1.6-0.4	5-0.4	7
GN.24306	GN 505-8-M5-MB	8	M5	8	16	1.6-0.4	5-0.4	7
GN.24311	GN 505-8-M6-MB	8	M6	8	16	1.6-0.4	5-0.4	6
GN.24321	GN 505-10-M4-MB	10	M4	10	19	3.5-1	5.8-0.4	8
GN.24326	GN 505-10-M5-MB	10	M5	10	19	3.5-1	5.8-0.4	7
GN.24331	GN 505-10-M6-MB	10	M6	10	19	3.5-1	5.8-0.4	7
GN.24336	GN 505-10-M8-MB	10	M8	10	19	3.5-1	5.8-0.4	6
GN.24302	GN 505-8-M4-OB	8	M4	8	16	1.6-0.4	5-0.4	7
GN.24307	GN 505-8-M5-OB	8	M5	8	16	1.6-0.4	5-0.4	7
GN.24312	GN 505-8-M6-OB	8	M6	8	16	1.6-0.4	5-0.4	6
GN.24322	GN 505-10-M4-OB	10	M4	10	19	3.5-1	5.8-0.4	8
GN.24327	GN 505-10-M5-OB	10	M5	10	19	3.5-1	5.8-0.4	7
GN.24332	GN 505-10-M6-OB	10	M6	10	19	3.5-1	5.8-0.4	7
GN.24337	GN 505-10-M8-OB	10	M8	10	19	3.5-1	5.8-0.4	6

