



Product Change Notification / RMES-17GUBB791

Date:

17-Jan-2022

Product Category:

Memory

PCN Type:

Manufacturing Change

Notification Subject:

CCB 4991 Final Notice: Qualification of MTAI as an additional Scan/Pack process site and implement packing changes for selected products available in 32L PLCC (11.5x14x3.37mm) package.

Affected CPNs:

[RMES-17GUBB791_Affected_CPN_01172022.pdf](#)
[RMES-17GUBB791_Affected_CPN_01172022.csv](#)

Notification Text:

PCN Status: Final notification

PCN Type: Manufacturing Change

Microchip Parts Affected: Please open one of the files found in the Affected CPNs section.

NOTE: For your convenience Microchip includes identical files in two formats (.pdf and .xls).

Description of Change: Qualification of MTAI as an additional Scan/Pack process site and implement packing changes for selected products available in 32L PLCC (11.5x14x3.37mm) package.

Pre and Post Change Summary:

	PRE CHANGE	POST CHANGE

Scan/Pack Site		King Yuan Electronics Company, Limited (KYE)	King Yuan Electronics Company, Limited (KYE)	Microchip Technology Thailand (HQ) (MTAI)
Base Quantity Multiple (BQM)	Tape and Reel	750	750	750
	Tube	30	30	30
Pin 1 Orientation	Tape and Reel	Quadrant 1 - 2	Quadrant 1 - 2	Quadrant 1 - 2
	Tube(<i>Note: Pre-change - Pin 1 orientation is depending on Assy location</i>)	Gray stopper - MMT Tube Colored stopper - LPI Tube Blue stopper – GTK Tube	Gray stopper - MMT Tube Colored stopper - LPI Tube Blue stopper – GTK Tube	Gray stopper – MMT Tube
Carrier tape		Minor dimensional changes. See pre and post change comparison.		
Cover Tape	Sealing Method	Heat Activated Seal	Heat Activated Seal	Heat Activated Seal
	Color	Transparent	Transparent	Clear
	Dimensions	Minor dimensional changes. See pre and post change comparison.		
Reel	Color	Regrind Blue	Regrind Blue	Dark Blue
	Dimensions	With dimensional changes. See pre and post change comparison.		
Tape and Reel Packing Method		See pre and post change comparison.		
Tube	Dimensions	With dimensional changes. See pre and post change comparison.		
	Color	Clear	Clear	Clear
Tube Packing Method		See pre and post change comparison		

Impacts to Data Sheet: None

Change Impact: None

Reason for Change: To improve on-time delivery performance by qualifying MTAI as an additional Scan/Pack process site.

Change Implementation Status: In Progress

Estimated First Ship Date: February 03, 2022 (date code: 2206)

NOTE: Please be advised that after the estimated first ship date customers may receive pre and post change parts.

Time Table Summary:

	January 2022	February 2022
--	--------------	---------------

Workweek	01	02	03	04	05	06	07	08	09	10
Final PCN Issue Date				X						
Estimated first ship date						X				

Method to Identify Change: Traceability code

Qualification Report: Not applicable

Revision History: January 17, 2022: Issued final notification. Attached the qualification report and added estimated first ship date by February 03, 2022.

The change described in this PCN does not alter Microchip's current regulatory compliance regarding the material content of the applicable products.

Attachments:

[PCN_RMES-17GUBB791_Pre and Post_Change Summary.pdf](#)

Please contact your local [Microchip sales office](#) with questions or concerns regarding this notification.

Terms and Conditions:

If you wish to receive Microchip PCNs via email please register for our PCN email service at our [PCN home page](#) select register then fill in the required fields. You will find instructions about registering for Microchips PCN email service in the [PCN FAQ](#) section.

If you wish to change your PCN profile, including opt out, please go to the [PCN home page](#) select login and sign into your myMicrochip account. Select a profile option from the left navigation bar and make the applicable selections.

Affected Catalog Part Numbers (CPN)

SST39LF040-55-4C-NHE
SST39LF020-55-4C-NHE
SST39LF010-55-4C-NHE
SST39LF040-55-4C-NHE-RVL
SST39VF040-70-4C-NHE
SST39VF020-70-4C-NHE
SST39VF010-70-4C-NHE
SST39VF040-70-4C-NHE-PP013
SST39VF040-70-4C-NHE-RVL
SST39VF040-70-4I-NHE
SST39VF020-70-4I-NHE
SST39VF010-70-4I-NHE
SST49LF008A-33-4C-NHE
SST49LF080A-33-4C-NHE
SST39SF040-55-4C-NHE
SST39SF020A-55-4C-NHE
SST39SF010A-55-4C-NHE
SST39SF040-70-4C-NHE
SST39SF020A-70-4C-NHE
SST39SF010A-70-4C-NHE
SST39SF040-55-4I-NHE
SST39SF020A-55-4I-NHE
SST39SF010A-55-4I-NHE
SST39SF040-70-4I-NHE
SST39SF020A-70-4I-NHE
SST39SF010A-70-4I-NHE
SST39SF010A-45-4I-NHE
SST39LF040-55-4C-NHE-RVL-T
SST39VF040-70-4C-NHE-T
SST39VF020-70-4C-NHE-T
SST39VF010-70-4C-NHE-T
SST39VF040-70-4I-NHE-T
SST39VF010-70-4I-NHE-T
SST49LF008A-33-4C-NHE-T
SST49LF080A-33-4C-NHE-T
SST39LF020-55-4C-NHE-T
SST39LF010-55-4C-NHE-T
SST39LF040-55-4C-NHE-T
SST39VF020-70-4I-NHE-T
SST39SF040-55-4C-NHE-T
SST39SF020A-55-4C-NHE-T
SST39SF010A-55-4C-NHE-T
SST39SF040-70-4C-NHE-T
SST39SF020A-70-4C-NHE-T
SST39SF010A-70-4C-NHE-T
SST39SF040-55-4I-NHE-T

SST39SF020A-55-4I-NHE-T
SST39SF010A-55-4I-NHE-T
SST39SF040-70-4I-NHE-T
SST39SF020A-70-4I-NHE-T
SST39SF010A-70-4I-NHE-T
SST39SF010A-45-4I-NHE-T

CCB 4991
Pre and Post Change Summary
PCN #: RMES-17GUBB791



A Leading Provider of Smart, Connected and Secure Embedded Control Solutions

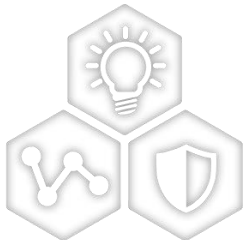

SMART | CONNECTED | SECURE

Pre and Post Change Summary

		KYE	MTAI
Scan/Pack Site		King Yuan Electronics Company, Limited (KYE)	Microchip Technology Thailand (HQ) (MTAI)
Base Quantity Multiple (BQM)	Tape and Reel	No changes	
	Tube		

Pre and Post Change Summary – Pin 1 Orientation

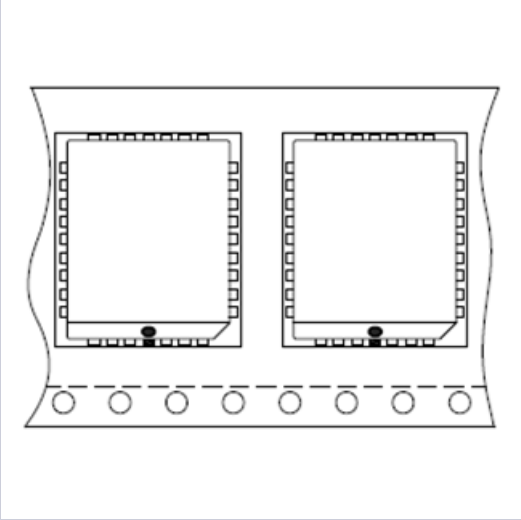
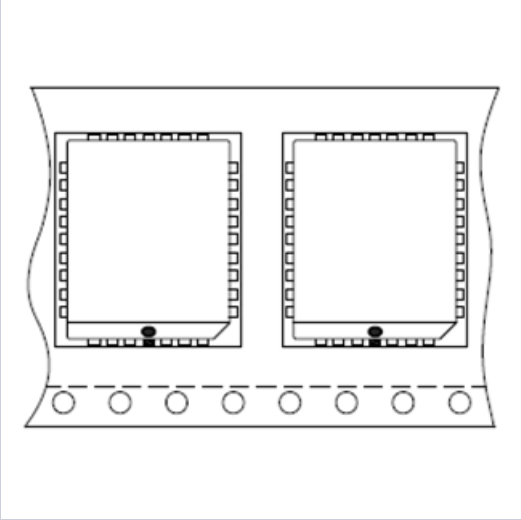
		KYE	MTAI
Pin 1 Orientation	Tape and Reel	 <p>Quadrant 1- 2</p>	 <p>Quadrant 1- 2</p>

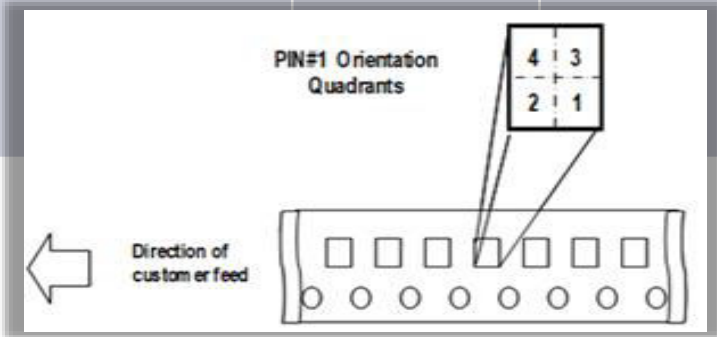

Pre and Post Change Summary – Carrier Tape

KYE

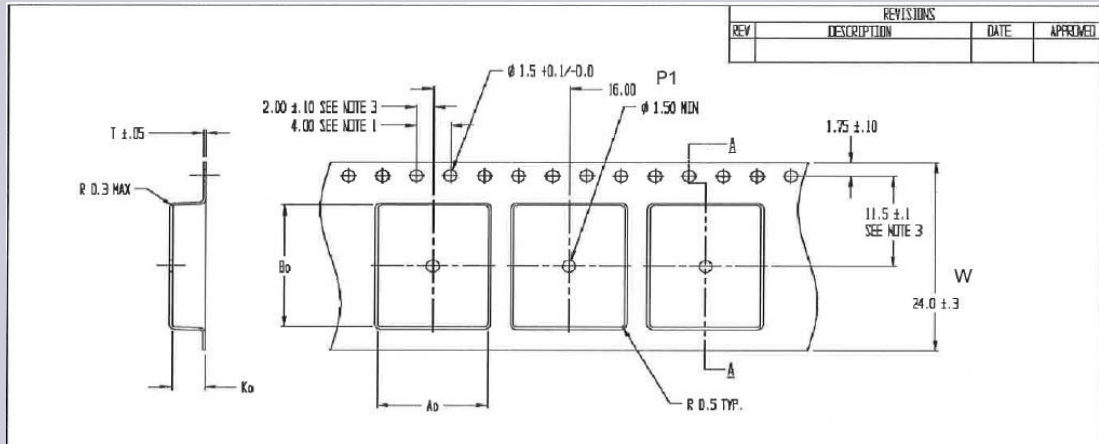

MTAI

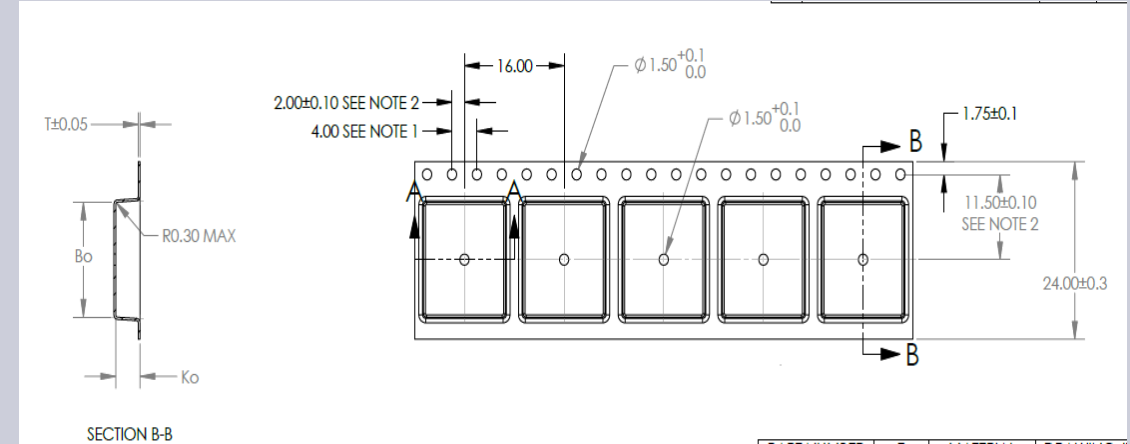

Scan / Pack Site	W (mm.)	P (mm.)	A0 (mm.)	B0 (mm.)	K0 (mm.)	K1 (mm.)	Thickness	BQM
MTAI	24.00 ±0.30	16.00 ±0.10	13.10 ±0.10	15.50 ±0.10	3.90 ±0.10	-	0.30 ±0.50	750
KYE	24.00 ±0.30	16.00 ±0.10	13.10 ±0.10	15.50 ±0.10	3.90 ±0.10	-	0.30 ±0.05	750

Pre and Post Change Summary – Cover Tape

KYE

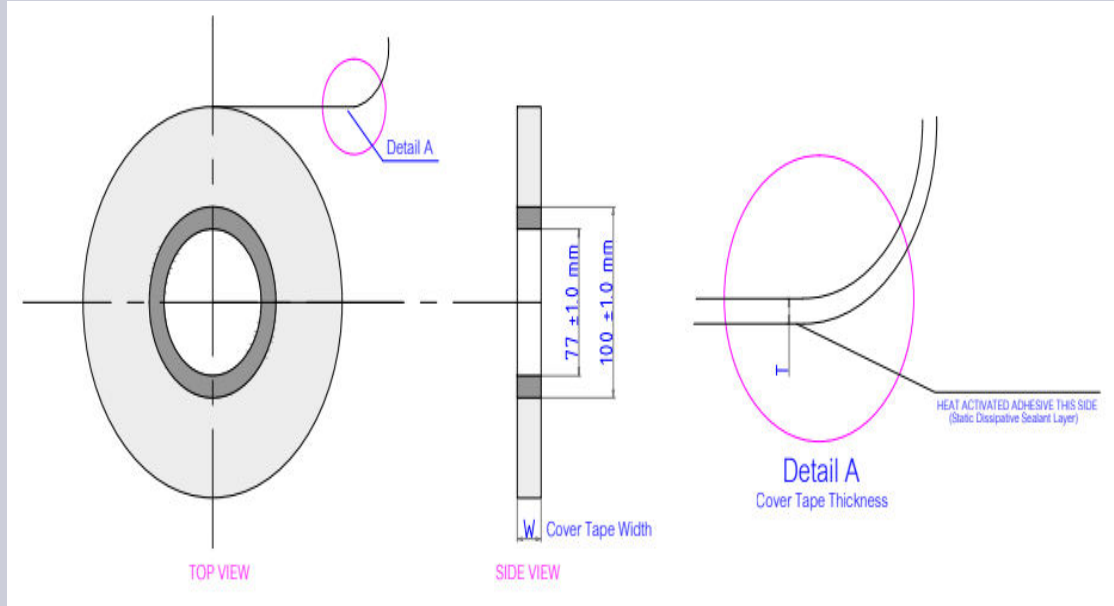

Cover tape color	Width ± 0.1 (mm)	Thickness ± 0.005 (mm)	Sealing Methodology
Transparent	21.3 ± 0.1	0.048 ± 0.005	Heat Seal

MTAI

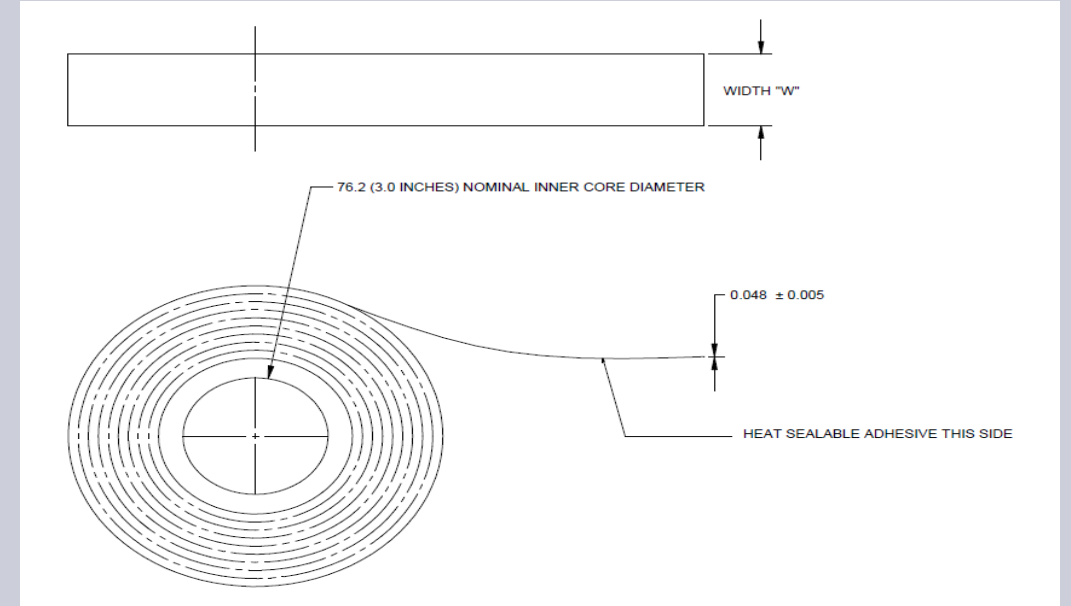

Cover tape color	Width ± 0.1 (mm)	Thickness ± 0.005 (mm)	Sealing Methodology
Clear	21.0 ± 0.1	0.050 ± 0.010	Heat Seal

Pre and Post Change Summary – Plastic Reel

KYE

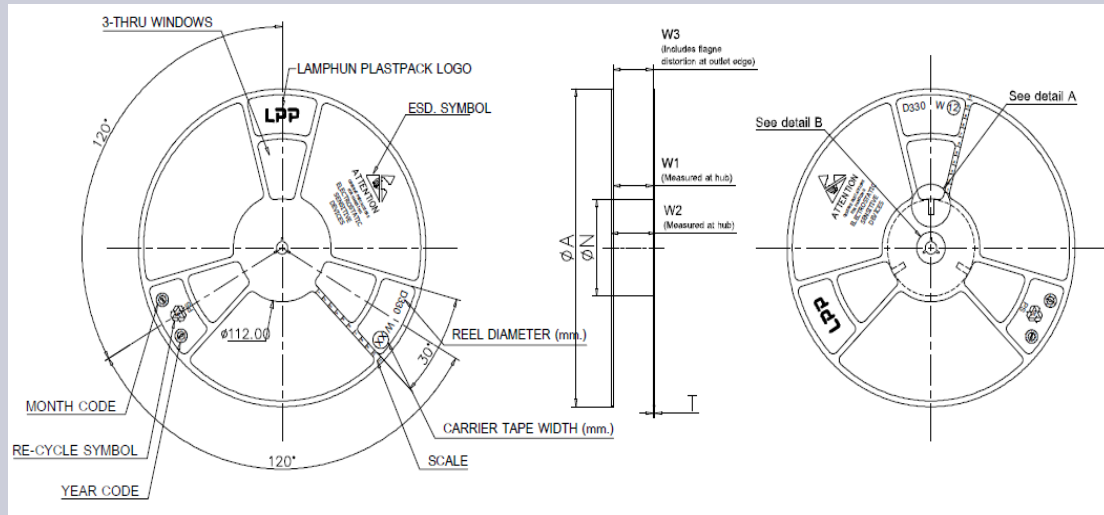

Reel Color	Reel diameter (mm)	Hub (mm)	Reel Width Max (mm.)
Regrind Blue	330 ±2.0	102±2.0	8.4 + 16.4

MTAI

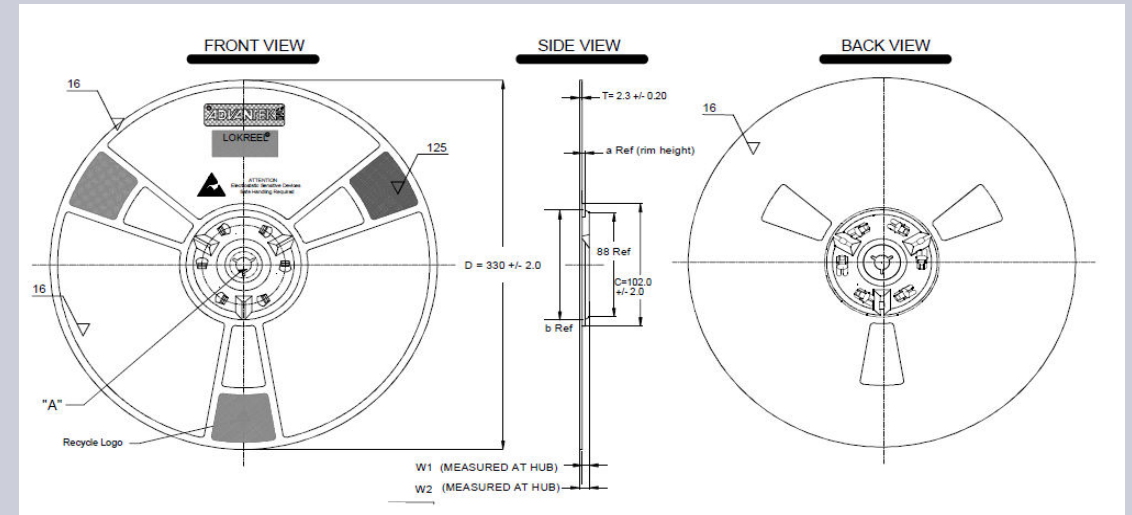

Reel Color	Reel diameter (mm)	Hub (mm)	Reel Width Max (mm.)
Dark Blue	330 ±2.0	100 ±2.0	30.40

Packing Method – Tape and Reel

KYE

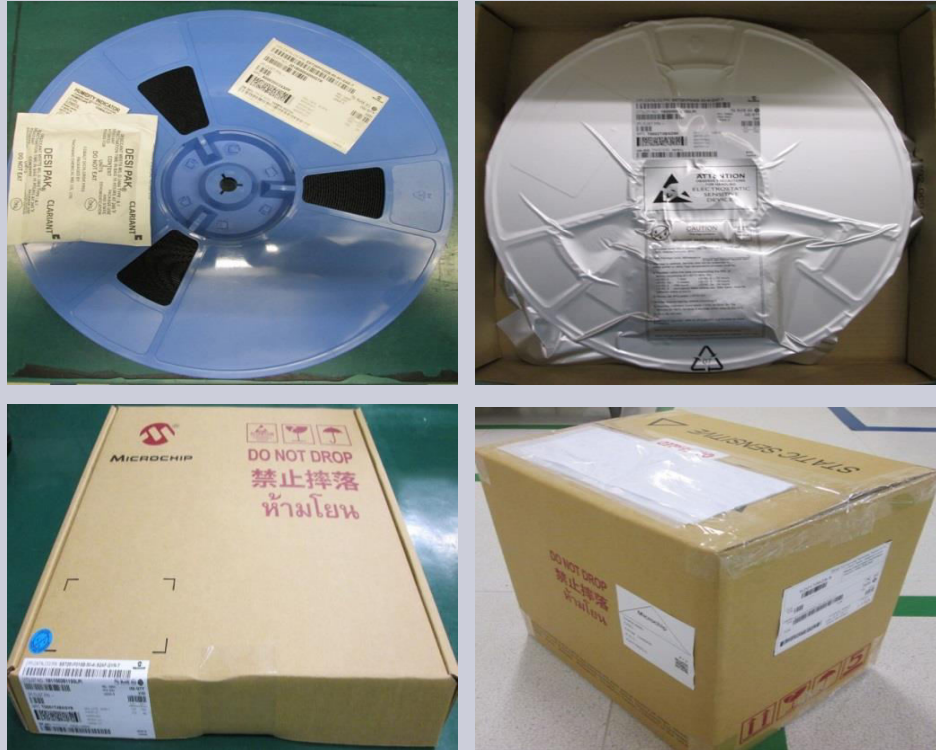

MTAI

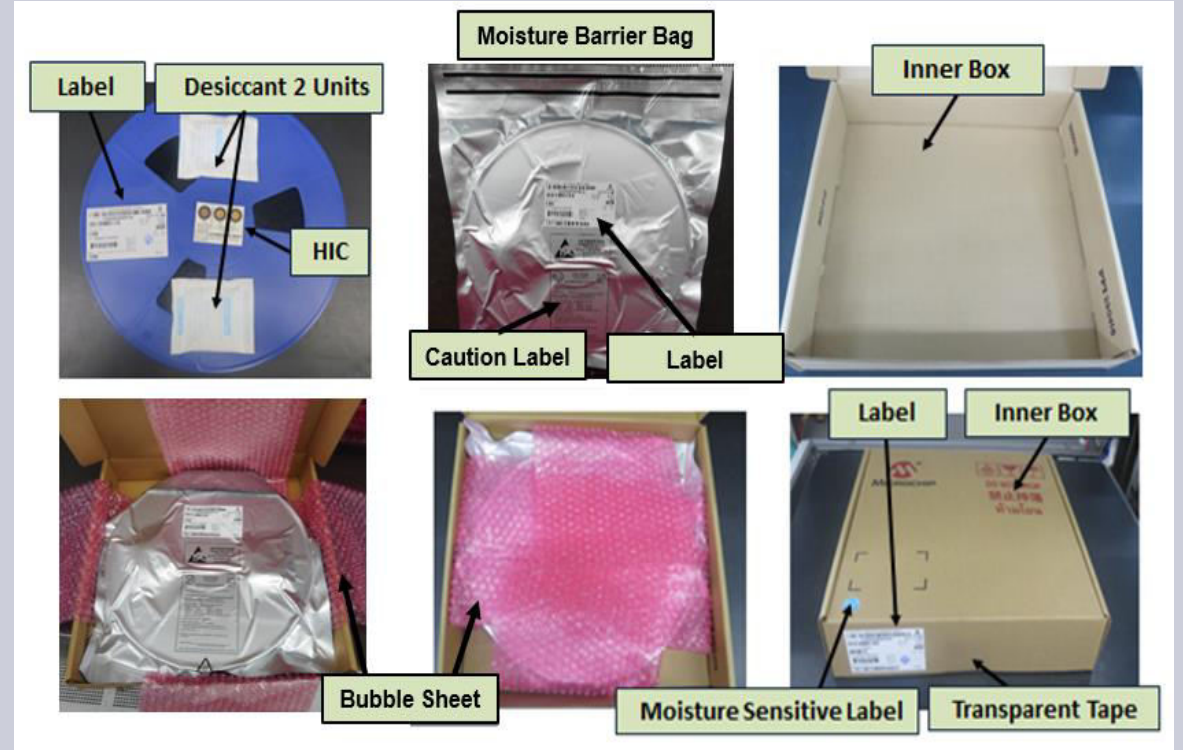

Pre and Post Change Summary – Pin 1 Orientation

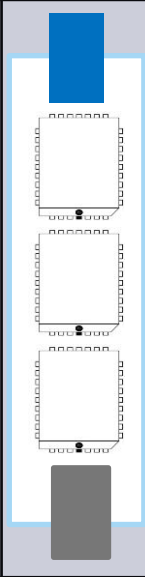
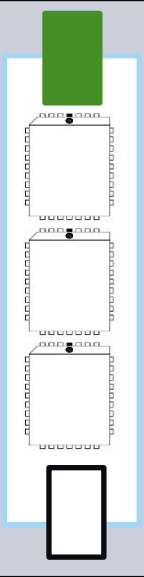
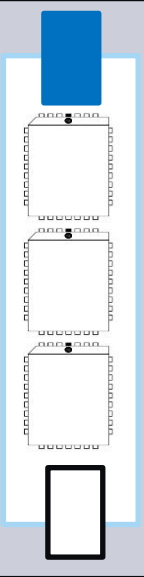
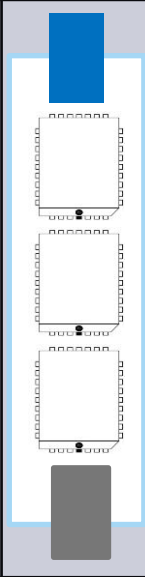
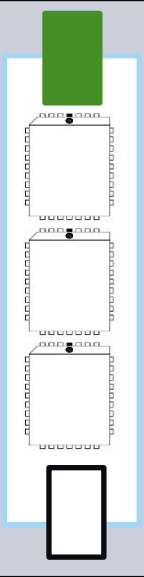
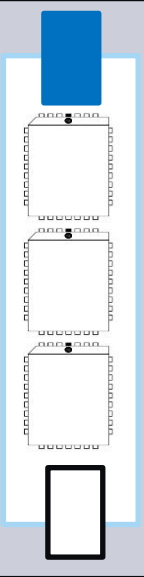
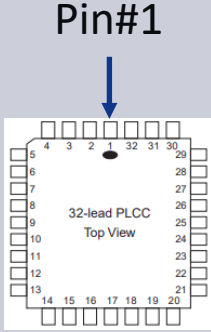
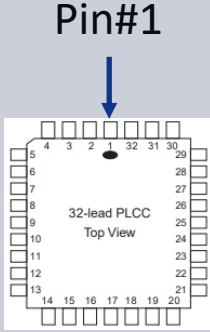
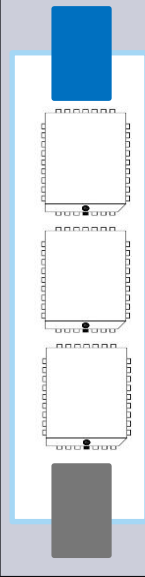
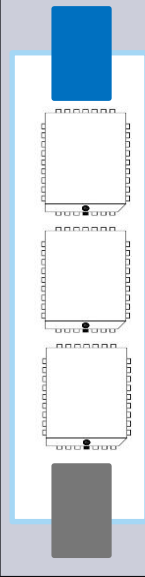
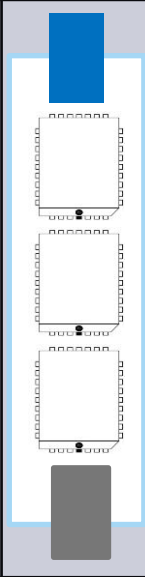
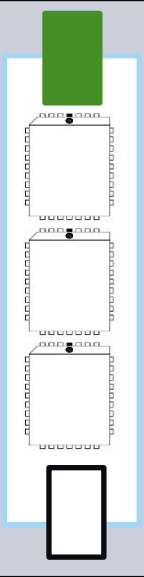
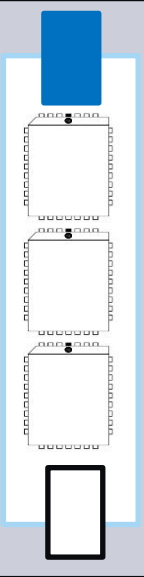
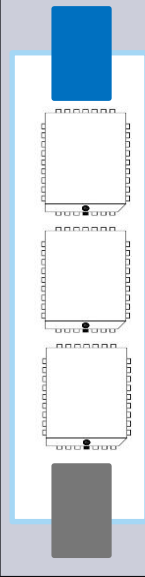
		KYE			MTAI																				
Pin 1 Orientation	Tube	<table border="1"> <thead> <tr> <th>MMT</th> <th>LPI</th> <th>GTK</th> </tr> </thead> <tbody> <tr> <td></td> <td></td> <td></td> </tr> </tbody> </table>	MMT	LPI	GTK						<table border="1"> <thead> <tr> <th>MMT</th> <th>LPI</th> <th>GTK</th> </tr> </thead> <tbody> <tr> <td></td> <td>N/A</td> <td>N/A</td> </tr> </tbody> </table>	MMT	LPI	GTK		N/A	N/A								
		MMT	LPI	GTK																					
																									
MMT	LPI	GTK																							
	N/A	N/A																							
<table border="1"> <thead> <tr> <th>Media</th> <th>Pin1 Side</th> <th>Opposite Side</th> </tr> </thead> <tbody> <tr> <td>MMT-TUBE</td> <td>GRAY stopper</td> <td>BLUE stopper</td> </tr> <tr> <td>LPI-TUBE</td> <td>Colored stopper</td> <td>WHITE stopper</td> </tr> <tr> <td>GTK-TUBE</td> <td>BLUE stopper</td> <td>WHITE stopper</td> </tr> </tbody> </table>	Media	Pin1 Side	Opposite Side	MMT-TUBE	GRAY stopper	BLUE stopper	LPI-TUBE	Colored stopper	WHITE stopper	GTK-TUBE	BLUE stopper	WHITE stopper	<table border="1"> <thead> <tr> <th>Media</th> <th>Pin1 Side</th> <th>Opposite Side</th> </tr> </thead> <tbody> <tr> <td>MMT-TUBE</td> <td>GRAY stopper</td> <td>BLUE stopper</td> </tr> <tr> <td>LPI-TUBE</td> <td colspan="2">N/A</td> </tr> <tr> <td>GTK-TUBE</td> <td colspan="2">N/A</td> </tr> </tbody> </table>	Media	Pin1 Side	Opposite Side	MMT-TUBE	GRAY stopper	BLUE stopper	LPI-TUBE	N/A		GTK-TUBE	N/A	
Media	Pin1 Side	Opposite Side																							
MMT-TUBE	GRAY stopper	BLUE stopper																							
LPI-TUBE	Colored stopper	WHITE stopper																							
GTK-TUBE	BLUE stopper	WHITE stopper																							
Media	Pin1 Side	Opposite Side																							
MMT-TUBE	GRAY stopper	BLUE stopper																							
LPI-TUBE	N/A																								
GTK-TUBE	N/A																								

Pre and Post Change Summary – Tube Dimension

LPI

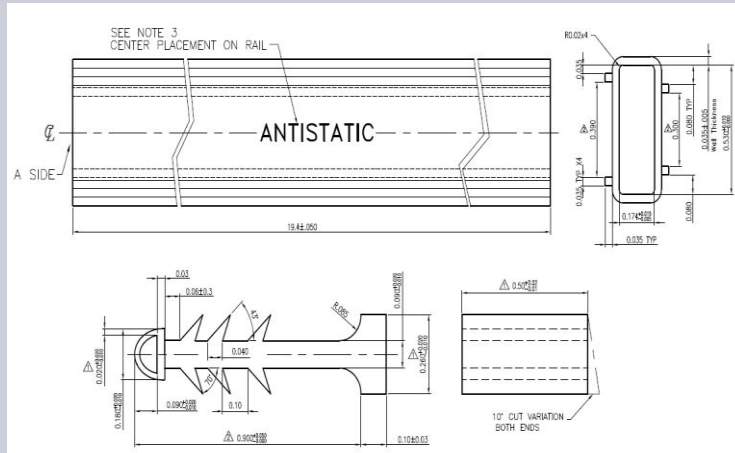

GTK

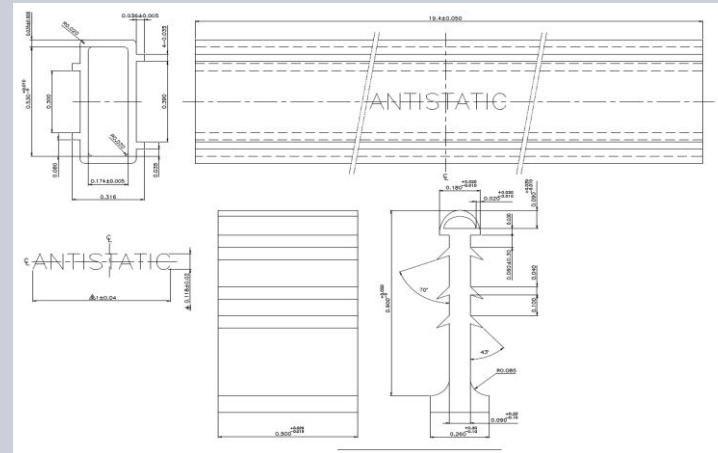

MMT

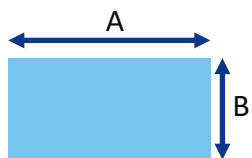
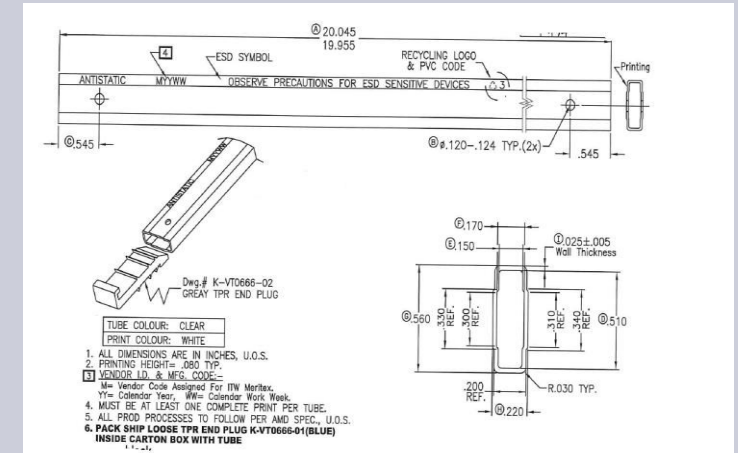

Tube	Scan / Pack Site	Tube Length (in)	Dimension A (in)	Dimension B (in)	Tube Color
MMT	KYE, MTAI	20.045	0.510	0.150	Clear
LPI	KYE	19.4	0.53	0.174	Clear
GTK	KYE	19.4	0.53	0.174	Clear

Packing Method – Tube

KYE



MTAI



Scan/Pack Site	MSL Level	Desiccant	Humidity Indicator Card	Baking Condition
MTAI	MSL-3	2 units	1 pcs	6 hours @125°C
KYE	MSL-3	2 units	1 pcs	6 hours @125°C