

THIS DRAWING IS UNPUBLISHED. RELEASED FOR PUBLICATION
 © COPYRIGHT 19 BY AMP INCORPORATED. ALL RIGHTS RESERVED.

LOC		DIST		REVISIONS			
P	LTR	DESCRIPTION		DATE	DWN	APVD	
FT	4	G		ADDED -2 PER EC 0G1C-32-98	24 MAR 98	PB	RW

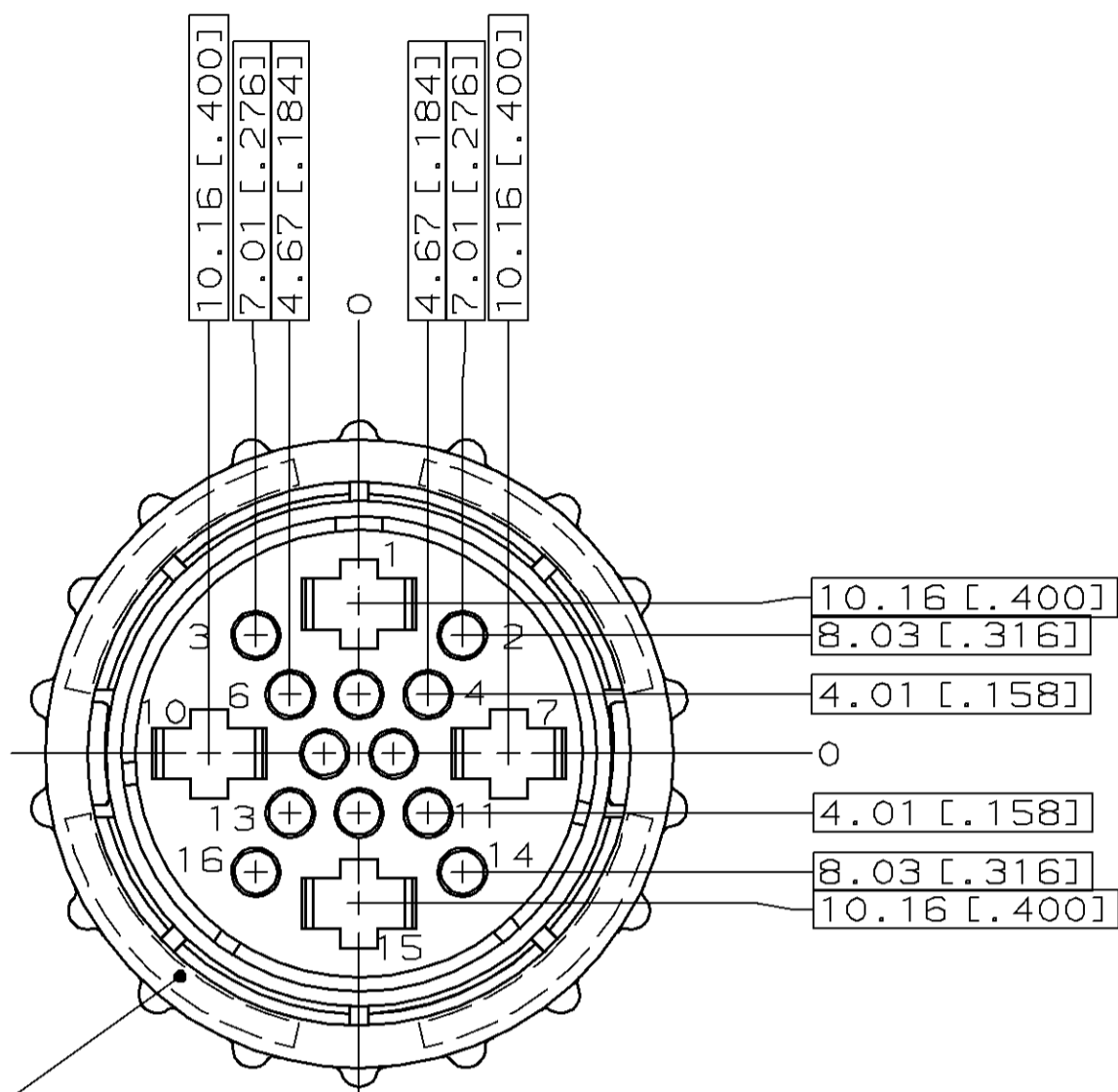

AMP PART NO
THIS SURFACE

(-1 ONLY)

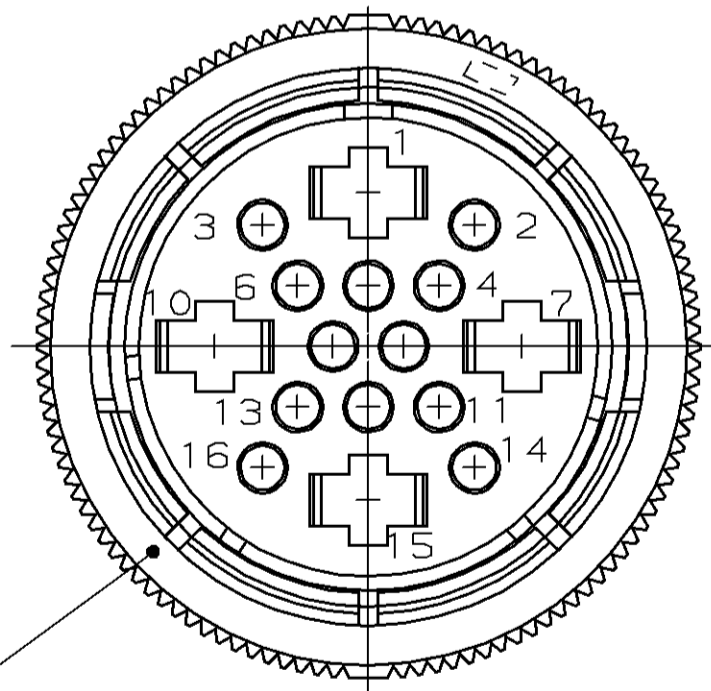

AMP PART NO
THIS SURFACE

(-2 ONLY)

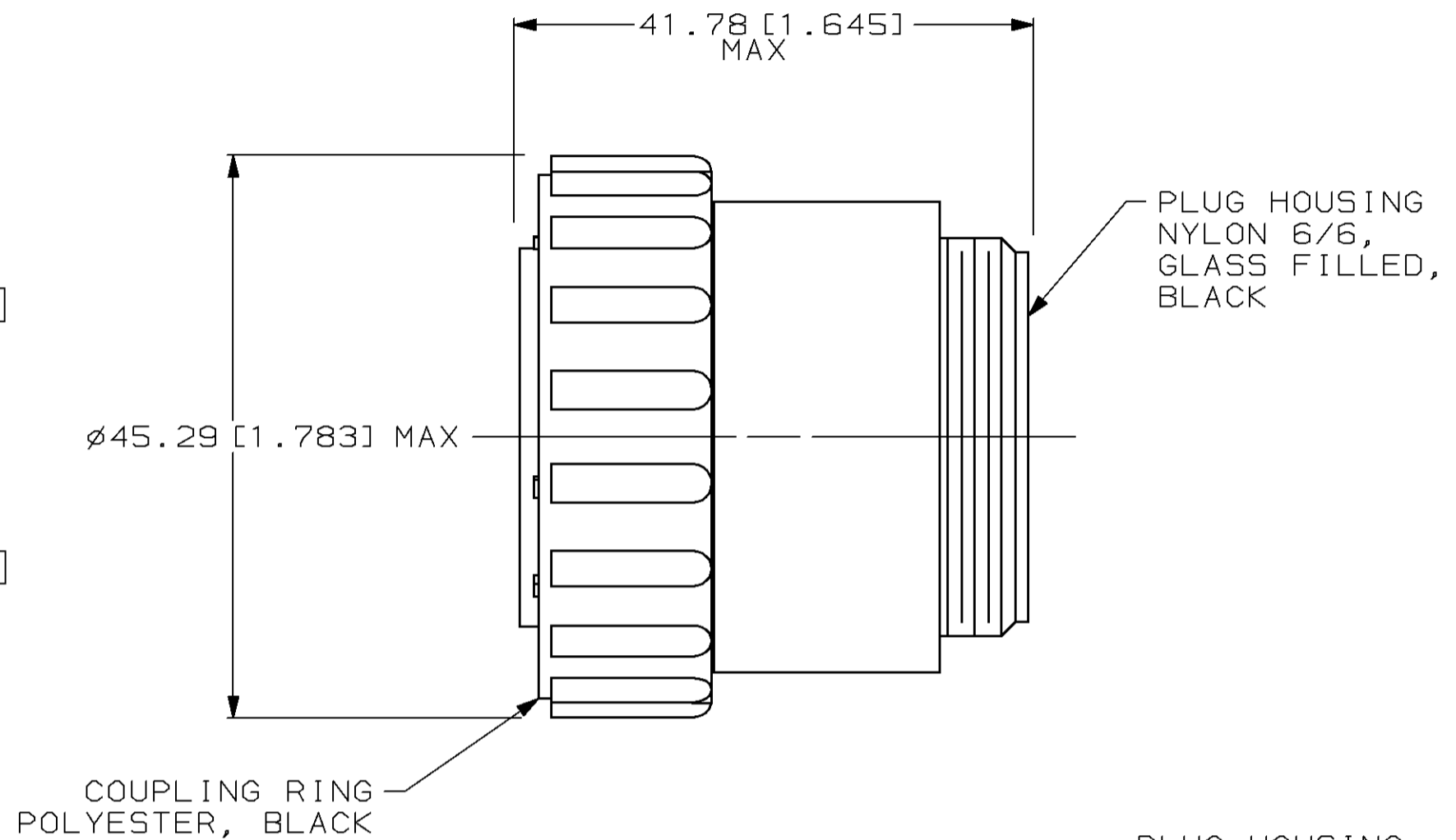

COUPLING RING
POLYESTER, BLACK

PLUG HOUSING
NYLON 6/6,
GLASS FILLED,
BLACK

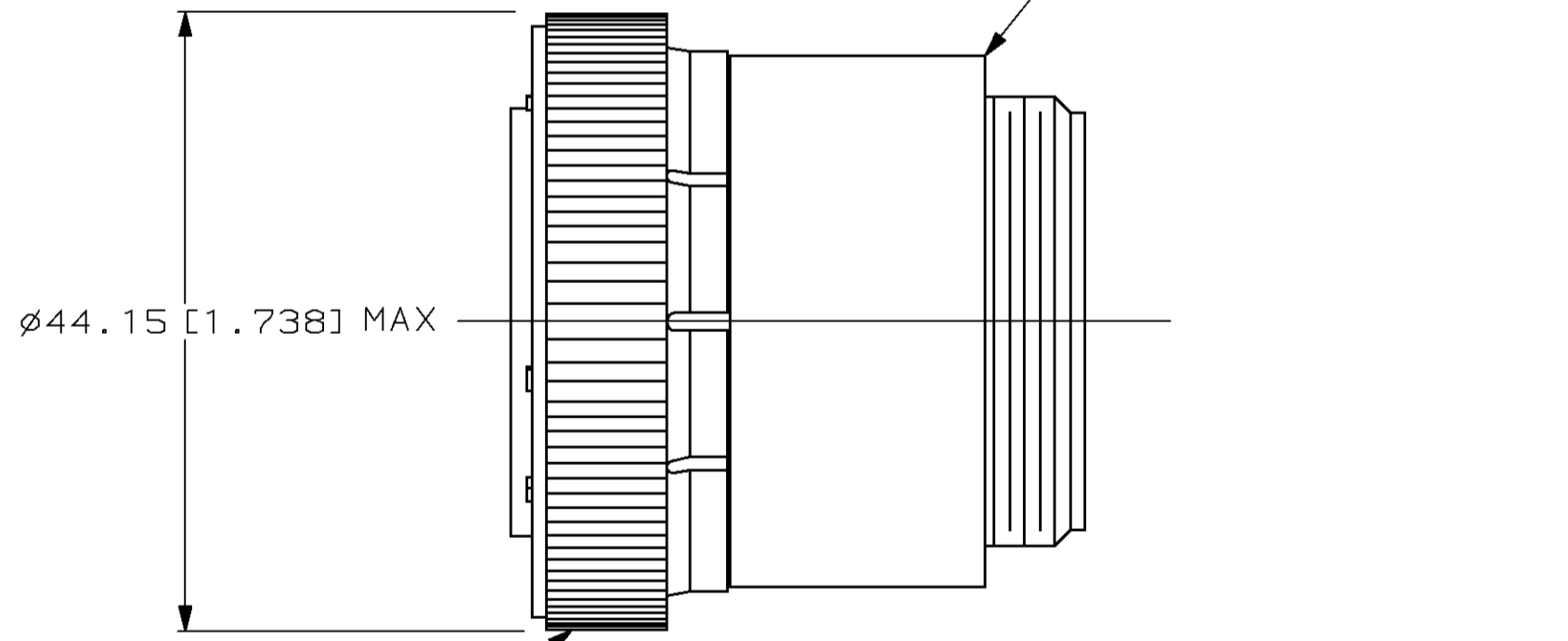

COUPLING RING
POLYPHENYLENE,
BLACK

PLUG HOUSING
NYLON 6/6,
GLASS FILLED,
BLACK

- 1.WILL ACCEPT (12) MULTIMATE & (4) TYPE XII SOCKET CONTACTS.
- 2.THIS CONNECTOR WILL ACCEPT INSULATION DIAMETERS UP TO .150.
- 3.CONTACT CAVITIES IDENTIFIED BY CHARACTERS ON FRONT AND REAR FACES OF CONNECTOR.

207485-2
207485-1
PART NUMBER

THIS DRAWING IS A CONTROLLED DOCUMENT.		DWN S. RIDGLEY BG 31 JUL 90	AMP Incorporated Harrisburg, PA 17105-3608	
DIMENSIONS: mm (INCHES)		CHK R. STONE 26 APR 91	NAME K. BEAVER 03 APR 91	
TOLERANCES UNLESS OTHERWISE SPECIFIED:		APVD K. BEAVER 03 APR 91	PRODUCT SPEC 108-10024	
0 PLC ±-		APPLICATION SPEC		
1 PLC ±-		SIZE A2		
2 PLC ±-		CAGE CODE 00779		
3 PLC ±-		DRAWING NO 207485		
4 PLC ±-		RESTRICTED TO		
ANGLES ±-		SCALE 2:1		
FINISH -		SHEET 1 OF 1		
MATERIAL SEE CALLOUT		REV G		
CUSTOMER DRAWING		SCALE 2:1		