

- 1
- 2
- 3
- 4
- 5
- 6
- 7
- 8
- 9
- 10
- 11
- 12
- 13
- 14
- 15
- 16
- 17
- 18

**STANDARD EXECUTIONS**

- GN 506.1: zinc-plated steel
- GN 506.1-NI: AISI 303 stainless steel.

**BALL AND SPRING**

Stainless steel (zinc-plated for GN 506.1-8).

**FEATURES AND APPLICATIONS**

GN 506.1 dowels for T-slots are suitable for use on sliding guides. The device provided with a ball and spring and located inside the dowel allows it to slide avoiding accidental vertical slipping. These dowels are highly recommended for use with fixing hinges for aluminium sections type CFG. (see page 1002).



**Application example**

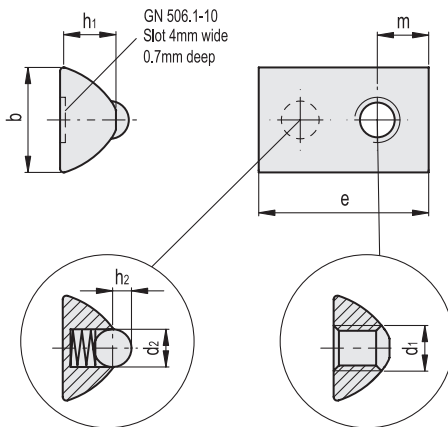
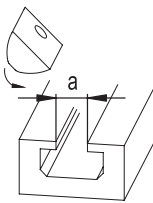

**GN 506.1**

Code	Description	b	d1	d2	e+0.5	h1	h2	m	Width a	⚖️
GN.24501	GN 506.1-8-M3	8 -0.1	M3	3	12	4.25	0.7	4	5	2
GN.24502	GN 506.1-8-M4	8 -0.1	M4	3	12	4.25	0.7	4	5	2
GN.24503	GN 506.1-8-M5	8 -0.1	M5	3	12	4.25	0.7	4	5	2
GN.24511	GN 506.1-10-M3	10 +0.3	M3	4	17.5	6.25	1.15	5	6	5
GN.24512	GN 506.1-10-M4	10 +0.3	M4	4	17.5	6.25	1.15	5	6	5
GN.24513	GN 506.1-10-M5	10 +0.3	M5	4	17.5	6.25	1.15	5	6	5
GN.24514	GN 506.1-10-M6	10 +0.3	M6	4	17.5	6.25	1.15	5	6	4
GN.24521	GN 506.1-14-M4	14 -0.2	M4	5	22.5	7.4	1.7	6.8	8	11
GN.24522	GN 506.1-14-M5	14 -0.2	M5	5	22.5	7.4	1.7	6.8	8	11
GN.24523	GN 506.1-14-M6	14 -0.2	M6	5	22.5	7.4	1.7	6.8	8	10
GN.24524	GN 506.1-14-M8	14 -0.2	M8	5	22.5	7.4	1.7	6.8	8	9

**GN 506.1-NI**



Code	Description	b	d1	d2	e+0.5	h1	h2	m	Width a	⚖️
GN.24526	GN 506.1-14-M4-NI	14-0.2	M4	5	22.5	7.4	1.7	6.8	8	11
GN.24527	GN 506.1-14-M5-NI	14-0.2	M5	5	22.5	7.4	1.7	6.8	8	11
GN.24528	GN 506.1-14-M6-NI	14-0.2	M6	5	22.5	7.4	1.7	6.8	8	10
GN.24529	GN 506.1-14-M8-NI	14-0.2	M8	5	22.5	7.4	1.7	6.8	8	9