

**2755 / 2755B / GH275  
GH435 / GH755  
GH810 (-6 to -10)**

**Nipples without  
wire trap**

**Nippel ohne  
Ausreiß-  
sicherung**

**Nipples sans  
gorge pour  
nappes**

**Nipples senza  
protezione da  
strappo**

**Manguitos  
roscados sin  
seguro de  
arranque**

2755(B) / GH275 / GH435 / GH810 (-6 to -10)

GH755

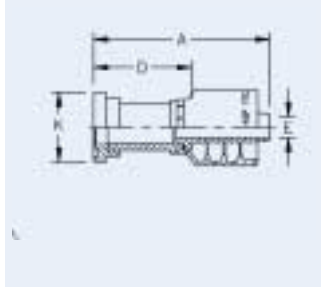

**FL (3000 psi)**

**SAE Flange Code 61  
Flansch-Code 61  
Bride code 61  
Flangia codice 61  
Brida-código 61**

Part Number Skive Steel	Part Number Skive Stainless Steel	Part Number TTC Steel	Part Number TTC Stainless Steel	Thread T	Flange	Tube O.D. mm	Hose ND	Hose Size	A mm	D mm	H mm	E mm	K Ø mm	HEX [1]	HEX [2]
GC8725-8*		1T8FL8**			1/2"		12	-8	83,0	50,0		9,0	30,2		
GC8725-12-10*		1T12FL10**			3/4"		16	-10	94,0	57,4		12,0	38,1		
GC8725-12*		1T12FL12**			3/4"		19	-12	88,0	51,0		15,0	38,1		
GC8725-16-12*		1T16FL12**			1"		19	-12	88,5	51,5		15,0	44,4		
GC8725-16*		1T16FL16**			1"		25	-16	111,5	71,0		20,0	44,4		
GC8725-20-16*		1T20FL16**			1 1/4"		25	-16	111,5	71,0		20,0	50,8		

2755(B) / GH275 / GH435 / GH810 (-6 to -10)

GH755

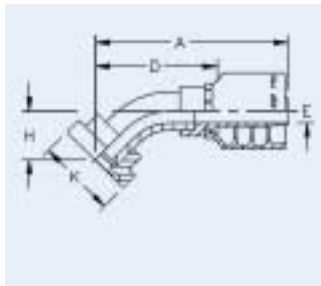
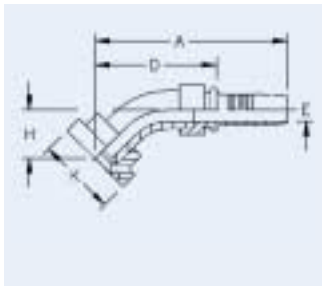

**FLA (3000 psi)**

**Split Flange Code 61, 45° Elbow  
Flansch-Code 61, 45° Krümmer  
Bride code 61, coude 45°  
Flangia codice 61 a 45°  
Brida-código 61 acodado a 45°**

Part Number Skive Steel	Part Number Skive Stainless Steel	Part Number TTC Steel	Part Number TTC Stainless Steel	Thread T	Flange	Tube O.D. mm	Hose ND	Hose Size	A mm	D mm	H mm	E mm	K Ø mm	HEX [1]	HEX [2]
GC8724-8*		1T8FLA8**			1/2"		12	-8	91,7	58,7	23,0	9,0	30,2		
GC8724-12-10*		1T12FLA10**			3/4"		16	-10	100,7	64,1	25,3	12,0	38,1		
GC8724-12*		1T12FLA12**			3/4"		19	-12	118,1	81,1	31,5	15,0	38,1		
GC8724-16-12*		1T16FLA12**			1"		19	-12	121,1	84,1	33,0	15,0	44,4		
GC8724-12-16*		1T12FLA16**			3/4"		25	-16	125,1	84,0	31,5	20,0	38,1		
GC8724-16*		1T16FLA16**			1"		25	-16	125,1	84,6	33,0	20,0	44,4		
GC8724-20-16*		1T20FLA16**			1 1/4"		25	-16	125,5	85,0	33,3	20,0	50,8		

\* Sockets must be ordered separately.

\* Fassungen müssen separat bestellt werden.

\* Les jupes doivent être commandées sép.

\* Le boccole devono essere ordinate sep.

\* Los manguitos tienen que pedirse por separado.

\*\* Part numbers include sockets.

\*\* Teil-Nr. beinhaltet Fassung.

\*\* L'embout-Nr. avec la jupe.

\*\* Part Number include la boccola.

\*\* Los números de parte incluyen los manguitos.