

250 X 100 X 40 CM

98.4" X 39.3" X 15.8"

MADERCLICK PLUS 6/400

5 Años Garantía
Years Guarantee
Jahre Garantie
Ans Garantie
Anos de Garantia
SIMONRACK

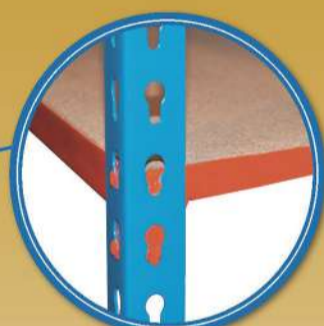
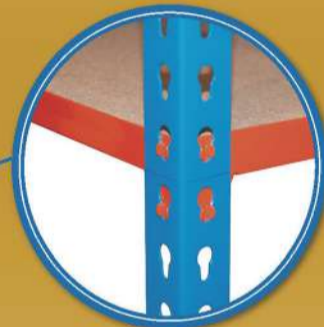

*MEDIDAS EN USO USED MEASUREMENTS
MASSNAHMEN IM EINSATZ MESURES EN EMPLOI MEDIDAS EM USO:
2435 x 1010 x 410 mm (95.8" x 39.7" x 16.1")



ESTANTERIAS SIMON S.L. B.50.556.463
PG. ALFAMEN C/ POLIGONO C, N°3
ALFAMEN (ZARAGOZA)



Simon Rack
SINCE 1964 - MANUFACTURER



www.simonrack.com



INSTRUCTIONS

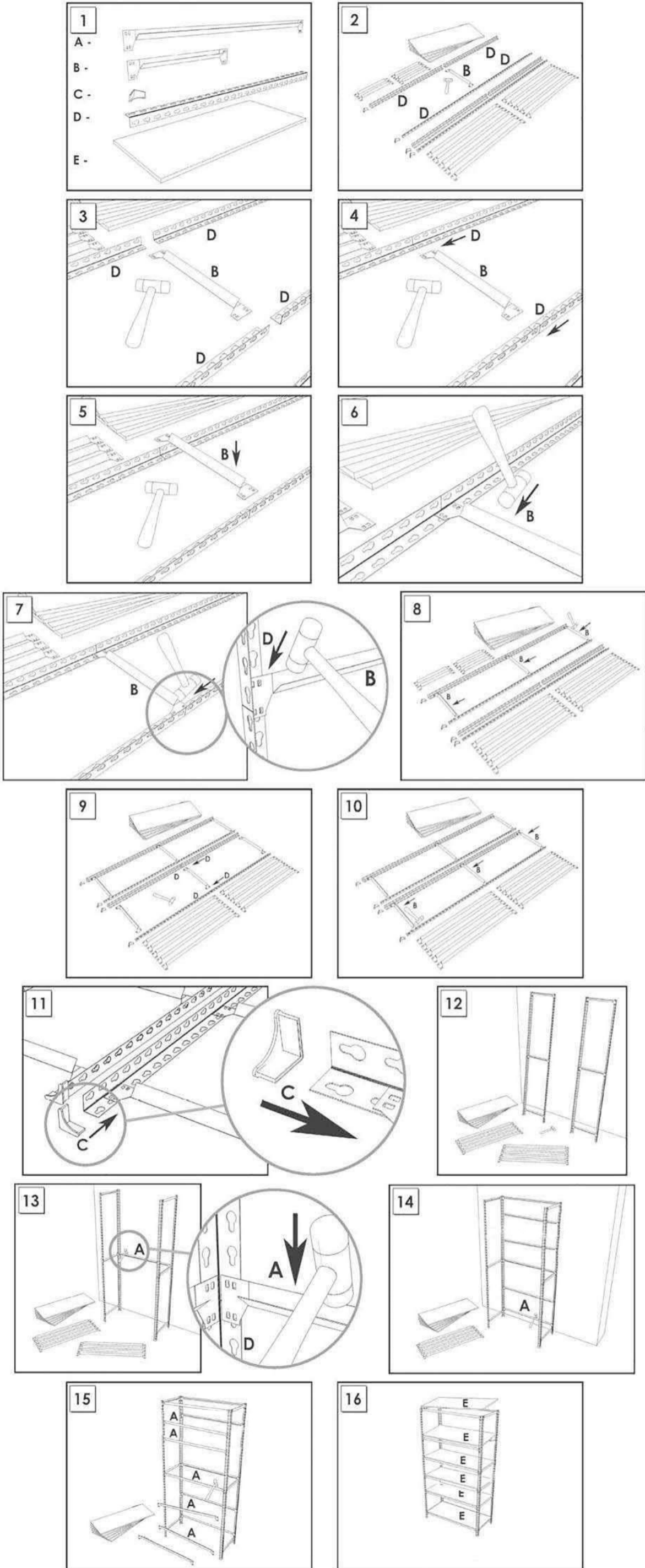

On-line instructions: www.instructionsrack.com/maderclick

www.simonrack.com • www.simonrack.com • www.simonrack.com • www.simonrack.com • www.simonrack.com • www.simonrack.com • www.simonrack.com • www.simonrack.com • www.simonrack.com • www.simonrack.com

SIMONCLASSIC

BOLTS SYSTEM

Up to: **150 Kg (331 lb)**
Kg/Shelf (Safety/Maximum Use)

SIMONCLICK

NO BOLTS SYSTEM

Up to: **400 Kg (882 lb)**
Kg/Shelf (Safety/Maximum Use)

SIMONOFFICE

NO BOLTS SYSTEM

Up to: **275 Kg (606 lb)**
Kg/Shelf (Safety/Maximum Use)

SIMONTALLER

NO BOLTS SYSTEM

Up to: **700 Kg (1543 lb)**
Kg/Shelf (Safety/Maximum Use)

BANCOS DE TRABAJO WORK BENCHES

Up to: **800 Kg (1764 lb)**
Kg/Shelf (Safety/Maximum Use)

SIMONHOME

Up to: **150 Kg (331 lb)**
Kg/Shelf (Safety/Maximum Use)

TAGUILLAS LOCKER



SIMONTITÁN

NO BOLTS SYSTEM

Up to: **900 Kg (1984 lb)**
Kg/Shelf (Safety/Maximum Use)

SIMONINOX

NO BOLTS SYSTEM

SIMONPALET

Up to: **4500 Kg (9921 lb)**
Kg/Shelf (Safety/Maximum Use)

SIMONLEVER

Up to: **900 Kg (1984 lb)**
Kg/Shelf (Safety/Maximum Use)

ALTILLOS Y PASILLOS ELEVADOS PLATFORMS AND MEZZANINES

