

## SPECIFICATIONS:

CONTACT RATING: Refer to "Contact Material Options" for more info.  
 ELECTRICAL LIFE: 50,000 make and break cycles at full load.  
 CONTACT RESISTANCE: 10mΩ max. initial @ 2-4 VDC.  
 INSULATION RESISTANCE: 1,000 MΩ min.  
 DIELECTRIC STRENGTH: 1,500V RMS @ sea level.  
 OPERATION TEMPERATURE: -30°C TO +85°C.

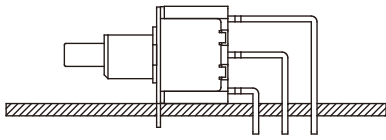

## MATERIALS:

CASE: Diallyl phthalate(DAP)(UL 94V-0).  
 PLUNGER: PBT or FR52 (UL 94V-0).  
 BUSHING: Brass, nickel plated.  
 HOUSING: Stainless steel.  
 TERMINAL SEAL: Epoxy.

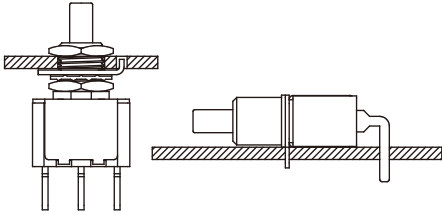

Specifications and Dimensions subject to change

If your preferred product configuration is not shown, please contact our sales representative for custom design.

## HOW TO ORDER SYSTEM

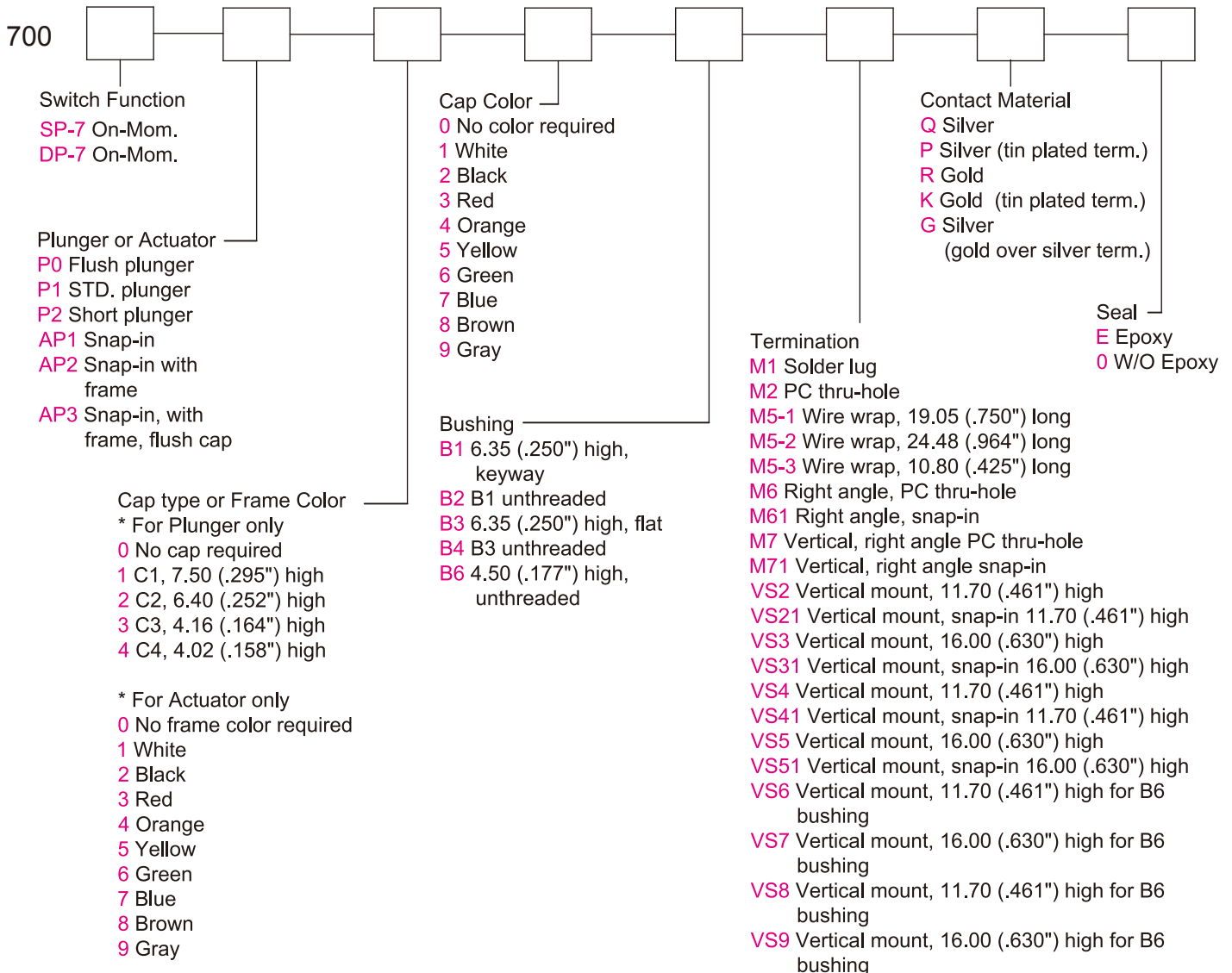

# Series 700

# Snap-Acting Pushbutton Switches

## SPDT



Model No.	Type	
SP-7	ON	MOM
Term. Comm.	1-3	1-2

Schematic

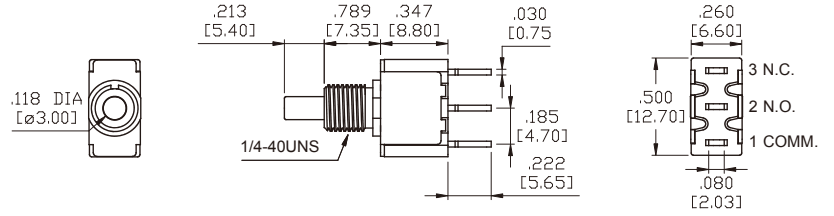

## DPDT



Model No.	Type	
DP-7	ON	MOM
Term. Comm.	1-3,4-6	1-2,4-5

Schematic

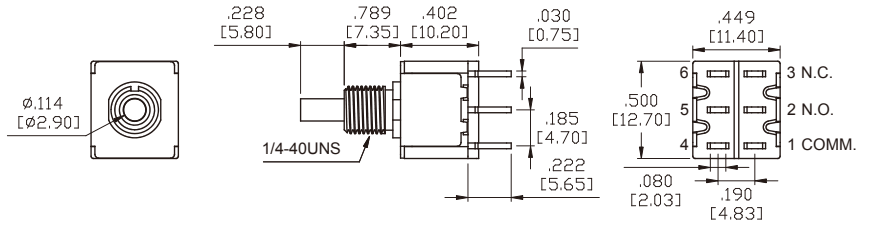
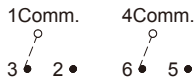

## PLUNGER OPTIONS

FOR B1,B2,B3,B4 ONLY

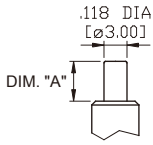

OPTION CODE	DIM. "A"
P0	.000 [0.00]
P1	.213 [5.40]
P2	.091 [2.30]

\* Plunger length shown with SPDT model.

FOR B6 ONLY

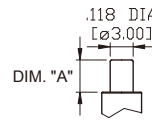

OPTION CODE	DIM. "A"
P1	.157 [4.00]
P2	.106 [2.70]

\* Plunger length shown with SPDT model.

## ACTUATOR OPTIONS FOR SNAP-IN FRONT MOUNT

### AP1

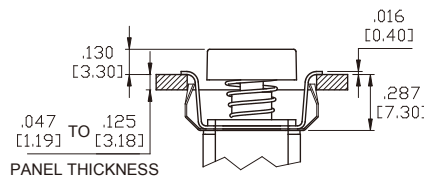
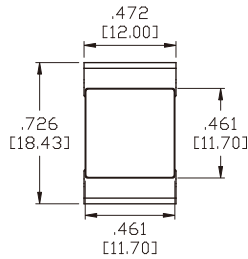
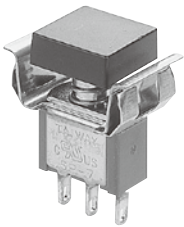

### PANEL MOUNTING

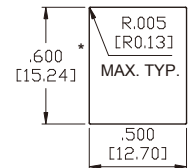

\* Increase this dimension to .620/.625 [15.75/15.88] for .091/.125 [2.31/3.18] thk. panels.

### AP2 WITH FRAME

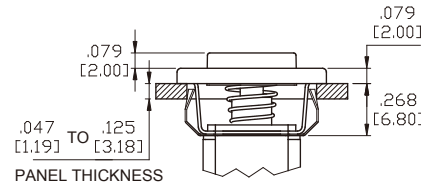
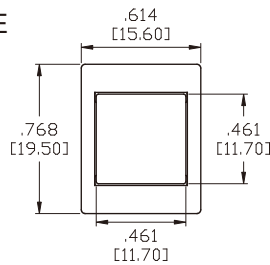
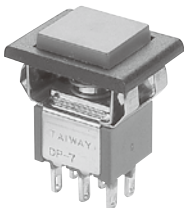

### PANEL MOUNTING

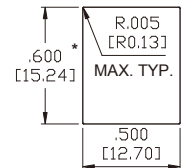

\* Increase this dimension to .620/.625 [15.75/15.88] for .091/.125 [2.31/3.18] thk. panels.

### AP3 FLUSH CAP

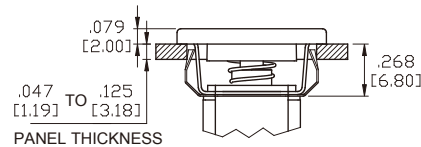
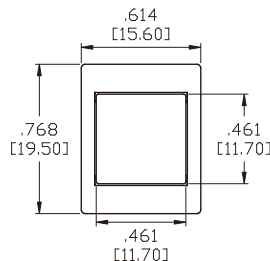

## BUSHING OPTIONS

**B1 THD STD**  
**B2 NON-THD**

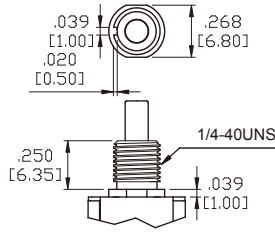

**B3 THD STD**  
**B4 NON-THD**

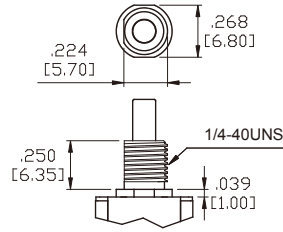

**B6 NON-THD**  
(FOR TERMINATION OPTIONS VS6-VS9 ONLY)

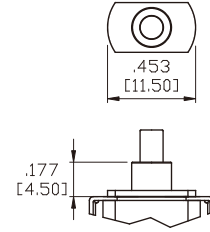

## TERMINATION OPTIONS

**M1 STD. SOLDER LUG**

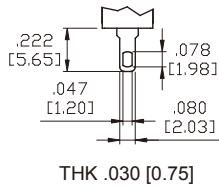

**M2 PC THRU-HOLE**

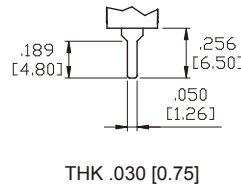

**M5 WIRE WRAP**

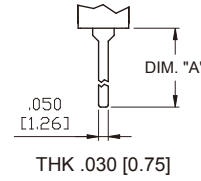

OPTION CODE	DIM. "A"
M5-1	.750 [19.05]
M5-2	.964 [24.48]
M5-3	.425 [10.80]

**M6**

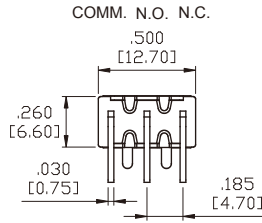
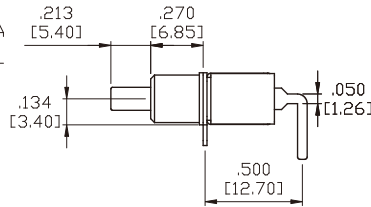
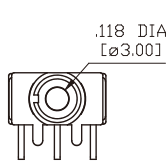

**P.C.MOUNTING**

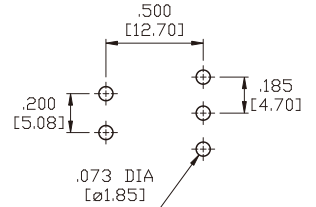

**SPDT**

**M6**

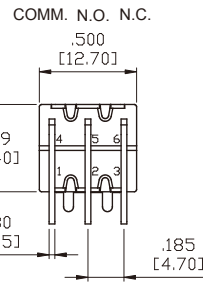
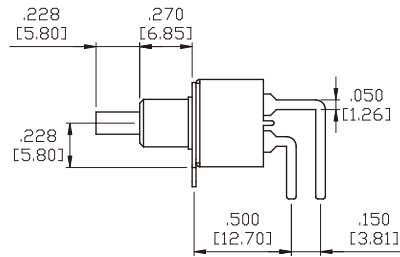
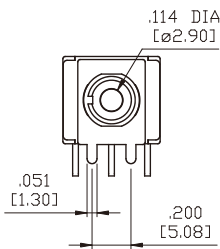

**P.C.MOUNTING**

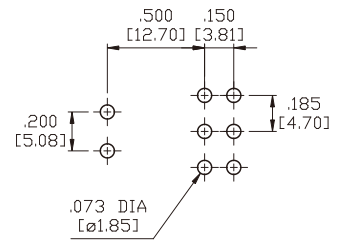

**DPDT**

**M7**

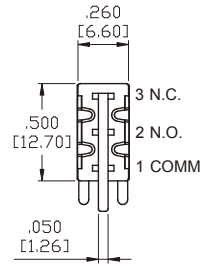
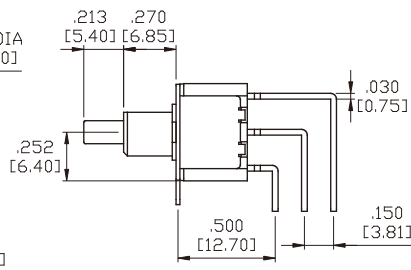
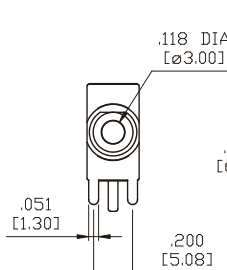
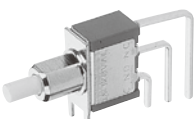

**P.C.MOUNTING**

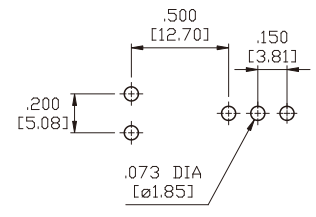

**SPDT**

## TERMINATION OPTIONS

M7

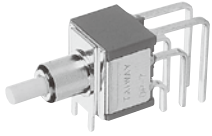

DPDT

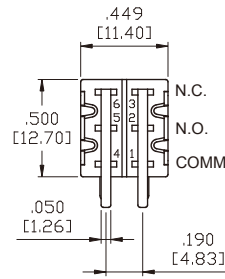
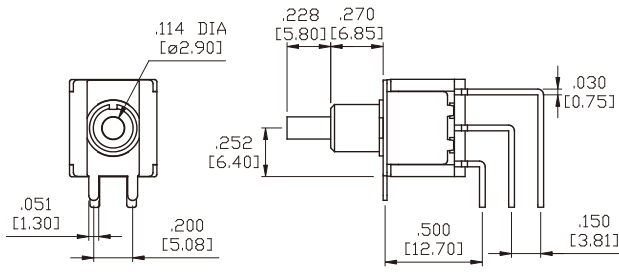

P.C.MOUNTING

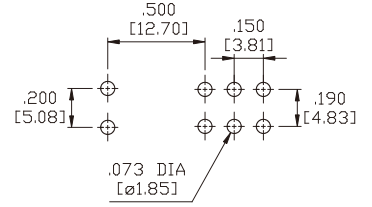

VS2-VS3

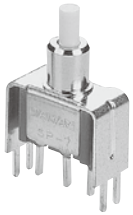

SPDT

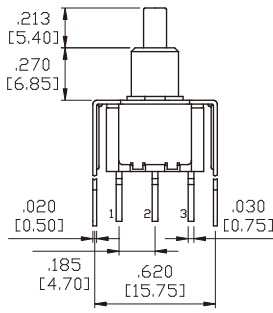
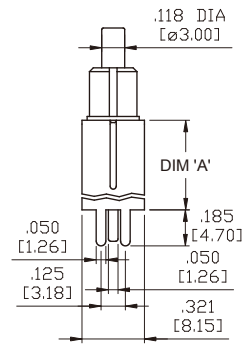

OPTION CODE	DIM.'A'
VS2	.461 [11.70]
VS3	.630 [16.00]

P.C.MOUNTING

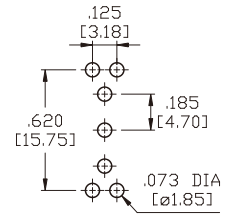

VS2-VS3

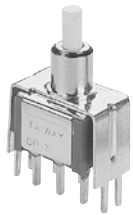

DPDT

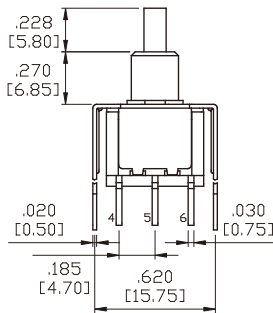
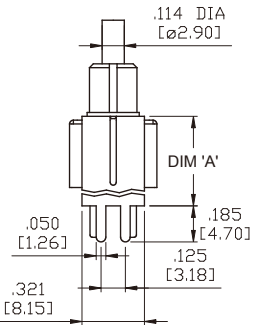

OPTION CODE	DIM.'A'
VS2	.461 [11.70]
VS3	.630 [16.00]

P.C.MOUNTING

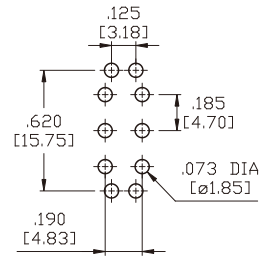

VS4-VS5

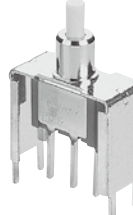

SPDT

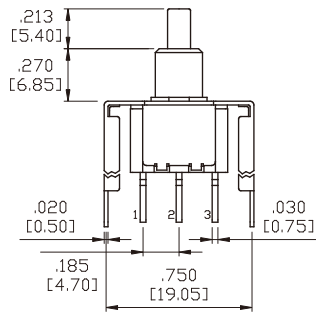
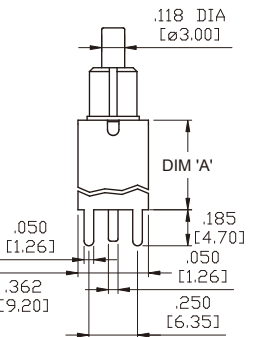

OPTION CODE	DIM.'A'
VS4	.461 [11.70]
VS5	.630 [16.00]

P.C.MOUNTING

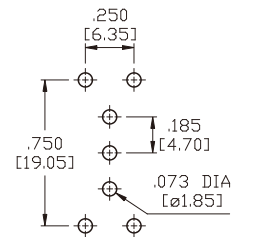

VS4-VS5

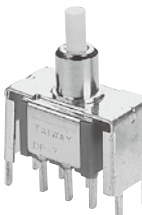

DPDT

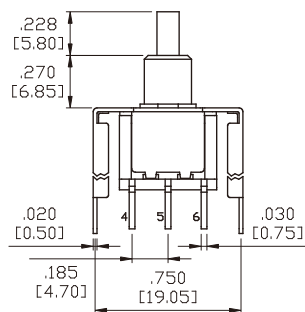
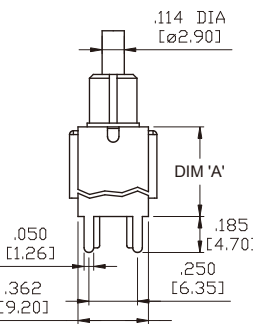

OPTION CODE	DIM.'A'
VS4	.461 [11.70]
VS5	.630 [16.00]

P.C.MOUNTING

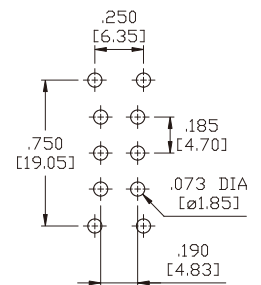

Toggle

Rocker

Slide

Pushbutton

AV

Rotary

Tact

Touch Key

Miscellaneous

## TERMINATION OPTIONS

### P.C.MOUNTING

#### VS6-VS7

(FOR B6 BUSHING ONLY)

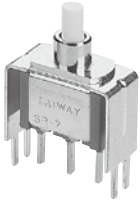

SPDT

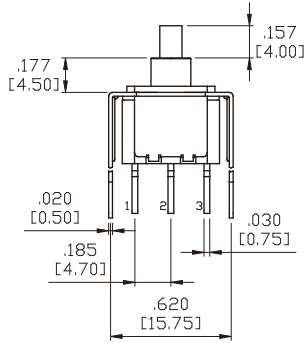
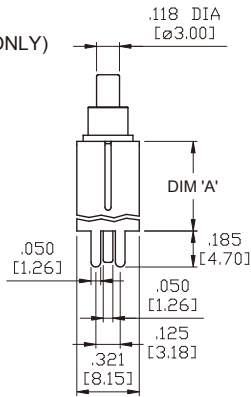

OPTION CODE	DIM.'A'
VS6	.461 [11.70]
VS7	.630 [16.00]

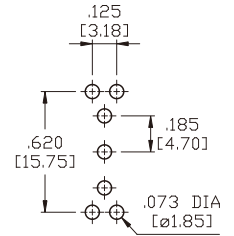

### P.C.MOUNTING

#### VS6-VS7

(FOR B6 BUSHING ONLY)



DPDT

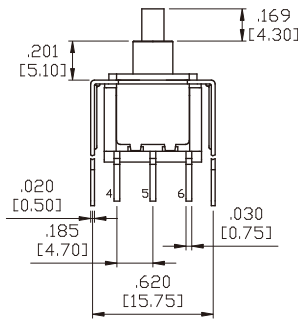
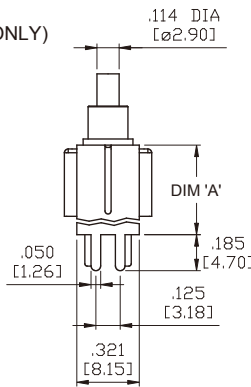

OPTION CODE	DIM.'A'
VS6	.461 [11.70]
VS7	.630 [16.00]

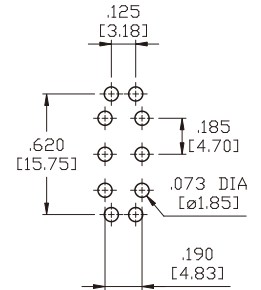

### P.C.MOUNTING

#### VS8-VS9

(FOR B6 BUSHING ONLY)

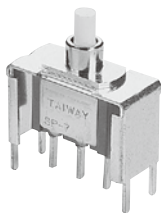

SPDT

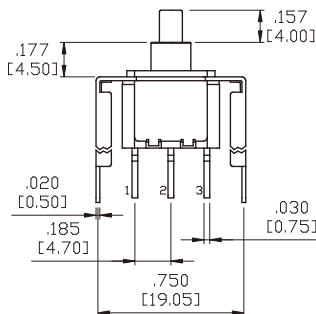
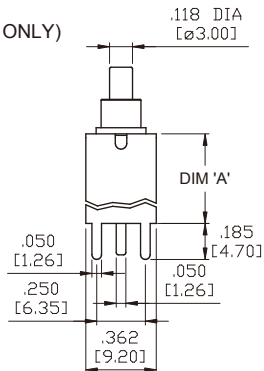

OPTION CODE	DIM.'A'
VS8	.461 [11.70]
VS9	.630 [16.00]

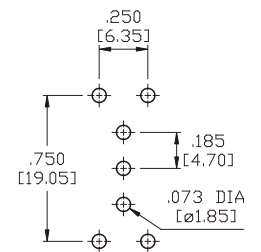

### P.C.MOUNTING

#### VS8-VS9

(FOR B6 BUSHING ONLY)

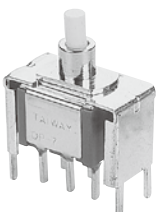

DPDT

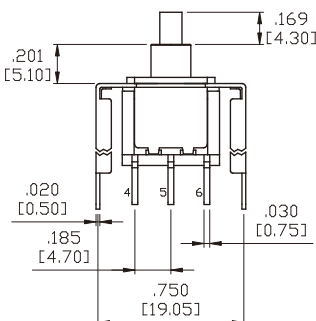
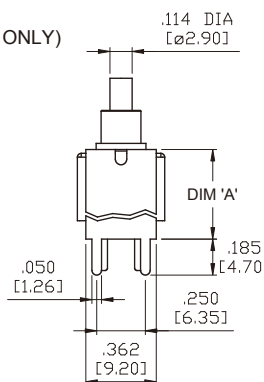

OPTION CODE	DIM.'A'
VS8	.461 [11.70]
VS9	.630 [16.00]

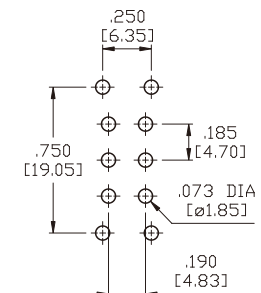

SNAP-IN TERMINATION OPTIONS

VS21,VS31

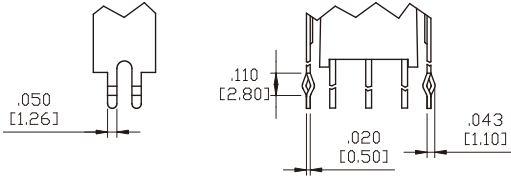

VS41,VS51

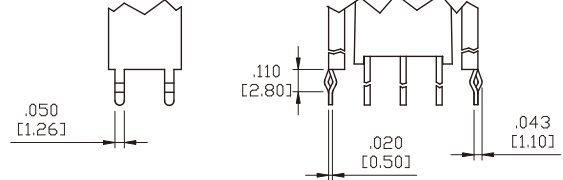

\* PC Mounting for VS21,VS31,VS41,VS51 refer to VS2,VS3,VS4,VS5 respectively.

PLUNGER CAPS

C1

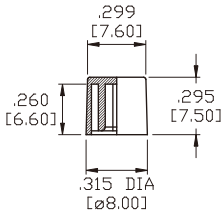

\* MATERIAL: ABS.

C2

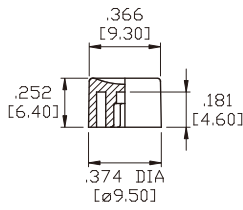

\* MATERIAL: ABS.

C3

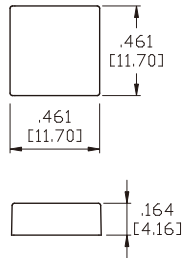

\* MATERIAL: ABS.

C4

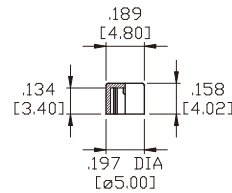

\* MATERIAL: ABS.

CAP AND FRAME COLORS	
1	White
2	Black
3	Red
4	Orange
5	Yellow
6	Green
7	Blue
8	Brown
9	Gray

E3 RUBBER HOOD

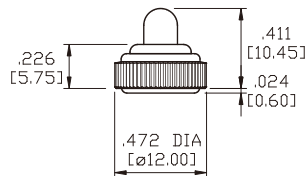

E3=INCH (STD.)  
E3A=INCH WITH INTERNAL-ORING SEALED

\* FOR P1 PLUNGER ONLY.

CONTACT MATERIAL OPTIONS

Coding	Contact Material	Terminal Plating	Rating	Agency Approvals
Q	Silver <sup>1</sup>	Silver plated <sup>1</sup>	1Amps @ 120VAC or 38VDC	
R	Gold <sup>2</sup>	Gold plated <sup>3</sup>	0.4VA max @ 20V max (AC or DC)	
G	Silver <sup>1</sup>	Gold over silver <sup>4</sup>	1Amps @ 120VAC or 38VDC	

1. Movable Contact / Terminals: Copper alloy, silver plated.
2. Movable Contact: Copper alloy with gold plated over nickel plated.
3. Terminals: Copper alloy, with gold plated over nickel plated.
4. Terminals: Silver plated with outer layer in gold plating.