

GN 75 | Knobs

Steel



- 1
- 2
- 3
- 4
- 5
- 6
- 7
- 8
- 9
- 10
- 11
- 12
- 13
- 14
- 15
- RH
-

MATERIAL

Turned and black-oxide steel.

STANDARD EXECUTIONS

- **GN 75-D**: threaded blind hole.
- **GN 75-E**: threaded stud.

SPECIAL EXECUTIONS ON REQUEST

- Zinc-plated steel executions.
- AISI 316 stainless steel executions.

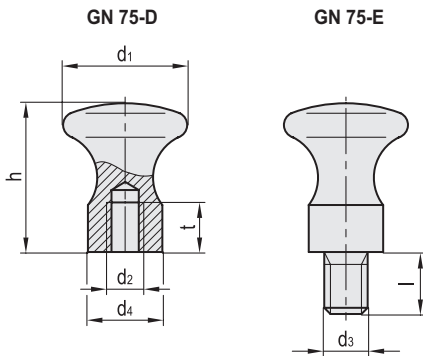

GN 75-D

Code	Description	d1	d2	d4	h	tmin	⚖️
GN.38551	GN 75-16-M5-D	16	M5	10	18	7	12
GN.38555	GN 75-20-M6-D	20	M6	12	24	9	23
GN.38559	GN 75-25-M6-D	25	M6	14	29	9	43
GN.38563	GN 75-32-M8-D	32	M8	18	37	12	82
GN.38567	GN 75-36-M10-D	36	M10	20	42	15	119

GN 75-E

Code	Description	d1	d3	d4	h	l	⚖️
GN.38553	GN 75-16-M6-E	16	M6	10	18	10	15
GN.38557	GN 75-20-M8-E	20	M8	12	24	12	30
GN.38561	GN 75-25-M8-E	25	M8	14	29	14	51
GN.38565	GN 75-32-M10-E	32	M10	18	37	16	98
GN.38569	GN 75-36-M12-E	36	M12	20	42	18	144

Fixed & revolving handles