

# ROLINE Cat.6/Class E Keystone Jack, RJ-45, STP, SLIM, tool-free, silver

<b>Product No.</b>	26.11.0377
<b>Manufacturer</b>	ROLINE
<b>Manufacturer No.</b>	26.11.0377
<b>EAN (single piece)</b>	7611990111008

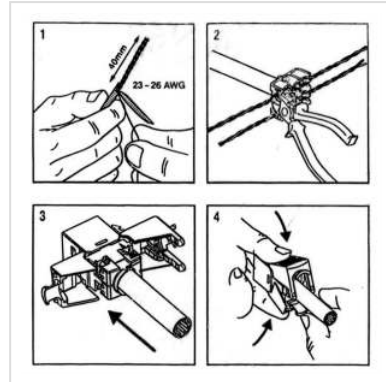

- The ROLINE Cat. 6/Class E 19" keystone patch panel system is composed of a 19" STP patch panel frame (please order separately!) and these shielded Cat.6 RJ-45 keystone jacks
- Assembling takes place toolless
- Colour code on the keystone jacks based on the standard EIA/TIA 568
- Colour: silver
- For a structured shielded Cat.6 cabling system we recommend to use the following components:

ROLINE Cat.6 S/FTP Cable, Solid Wire, AWG23: 21.15.0890 (100 m), 21.15.0891 (300 m)

ROLINE Flush Mount Wall Jack for Keystones, unloaded: 25.16.8579

ROLINE Cat.6 Keystone, RJ-45, shielded: 26.11.0358

ROLINE Cat.6 19" Keystone Patch Panel, 24 ports, shielded: 26.11.0359 (light grey), 26.11.0360 (black)

ROLINE Cat.6 S/FTP Patch Cord, grey, 5 m: 21.15.0835

Our in-house laboratory has tested this cable-plug combination, in a Channel of 100 meters, in compliance with Class E specification.

## Technical specifications

Manufacturer	ROLINE
Product group	Connection technology TP
Product type	RJ45 Keystone Jack
Colour	silver

Shield type	Screened
Transfer quality	Cat6 / Class E
Quantity of ports	24
Assembly cable connection	Krone LSAplus
Assignment	EIA/TIA 568A & 568B
Modular assembly	Yes
Connection direction	Straight