

# Ferrite core

$\varnothing \leq 8$  mm

## FEATURES:

### SPECIFICATION:

For cable size	$\varnothing \leq 8$ mm
A	16 mm
C	8 mm
D	28.5 mm
Impedance @ 25 MHz	195 $\Omega$
Impedance @ 100 MHz	258 $\Omega$

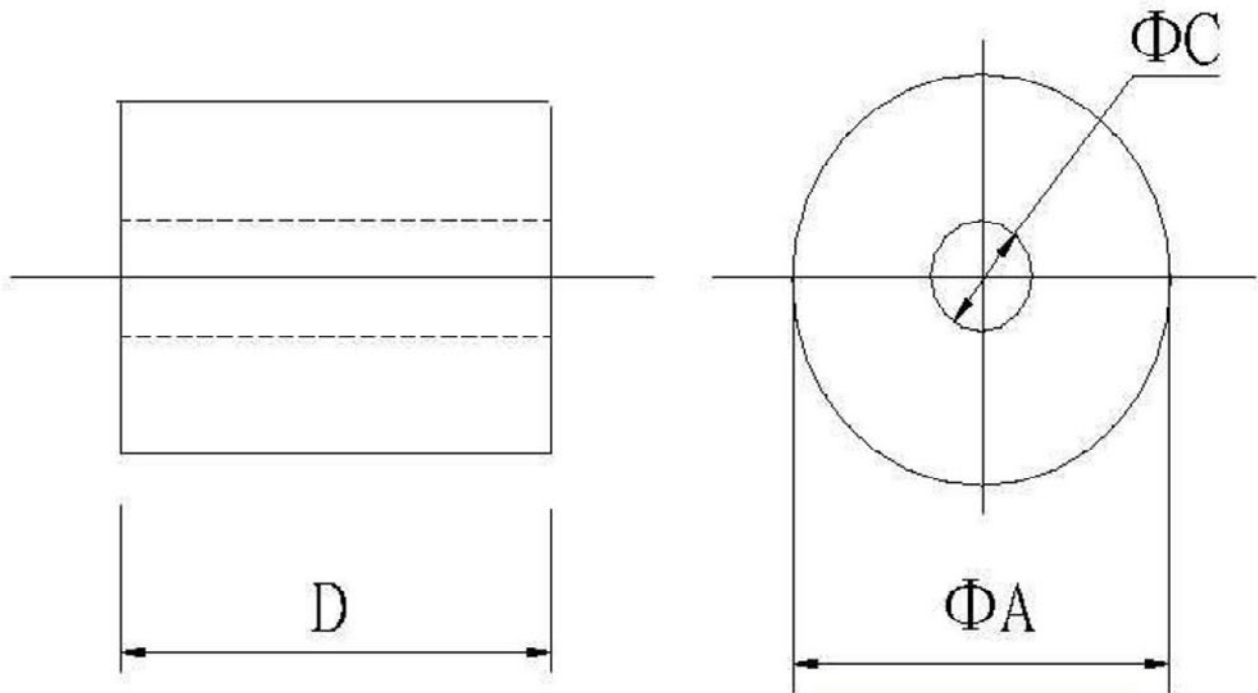

# Ferrite core

$\varnothing \leq 8 \text{ mm}$

## Frequency Graph

1. TEST INSTRUMENT:HP4286A
2. WINDING:0.4 $\Phi$ X165 mm 2 U. E. W 1 TS

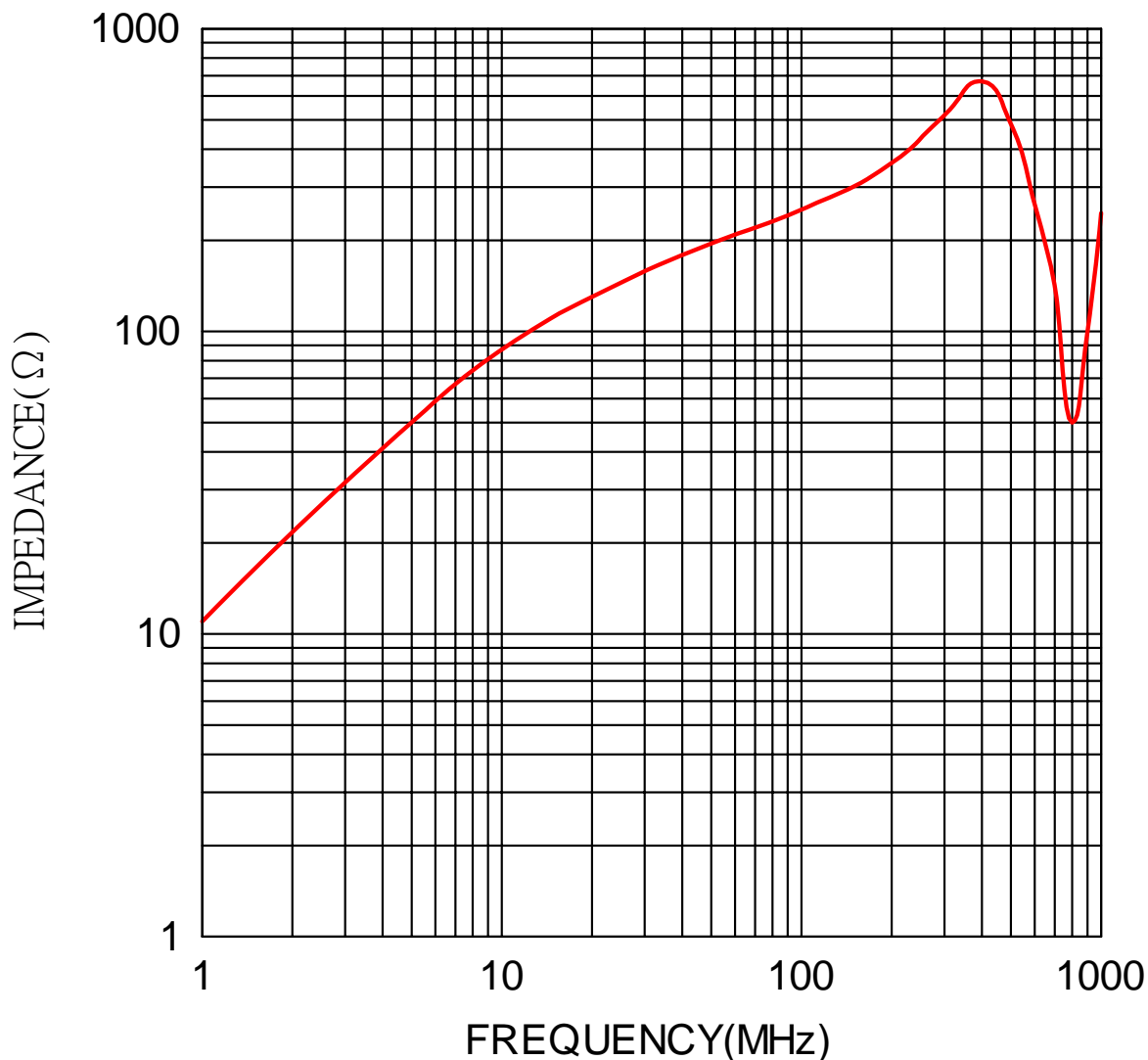

	1	5	10	25	50	100	200	300	400	500	600	700	800	900	1000
Z —	11	50	87	145	195	253	360	518	670	484	263	141	50	100	246

(DATA BETWEEN 500MHz AND 1000MHz ARE FOR REFERENCE ONLY)

Art. Nr.  
RND 165-00027