

GN 709.1 | Locking elements with threaded pin

Steel



- 1
- 2
- 3
- 4
- 5
- 6
- 7
- 8
- 9
- 10
- 11
- 12
- 13
- 14
- 15
- 16
- 17
- 18
- RH

MATERIAL

Hardened phosphated steel.

ELASTIC ELEMENT

Polyurethane (PUR).

STANDARD EXECUTIONS

Hardened steel ball:

- **GN 709.1-B**: ball with smooth and flat face, not reversible.
- **GN 709.1-BR**: ball with smooth and flat face, not reversible, with automatic return.
- **GN 709.1-R**: ball with knurled and flat face, not reversible.
- **GN 709.1-RR**: ball with knurled and flat face, not reversible, with automatic return.

Nickel-plated steel ball:

- **GN 709.1-RH**: ball with knurled and flat face, not reversible.
- **GN 709.1-RRH**: ball with knurled and flat face, not reversible, with automatic return.

FEATURES AND APPLICATIONS

GN 709.1 clamping elements are used as mobile supports or for clamping workpieces.

Maximum inclination of the ball plane = 9°.

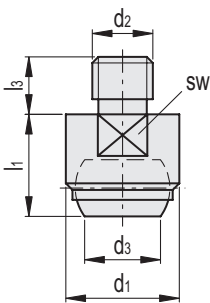

GN 709.1-B

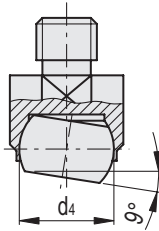

GN 709.1-BR

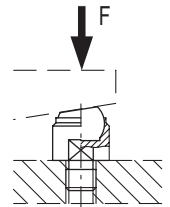
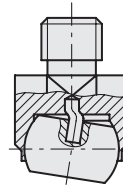

GN 709.1-B

Code	Description	d1	d2	d3	d4	l1 ±0.02	l3	sw	Max. static load F [kN]	⚖
GN.76001	GN 709.1-13-M6-B	13	M6	7.2	10	13	8	11	10	12
GN.76006	GN 709.1-13-M8-B	13	M8	7.2	10	13	8	11	10	12
GN.76011	GN 709.1-20-M8-B	20	M8	10.5	16	18	10	17	25	38
GN.76016	GN 709.1-20-M10-B	20	M10	10.5	16	18	10	17	25	40
GN.76021	GN 709.1-20-M12-B	20	M12	10.5	16	18	12	17	25	50
GN.76026	GN 709.1-30-M16-B	30	M16	20	25	27	16	27	90	150
GN.76031	GN 709.1-50-M20-B	50	M20	34.5	40	35	20	41	165	520
GN.76036	GN 709.1-50-M24-B	50	M24	34.5	40	35	24	41	165	516

GN 709.1-BR

Code	Description	d1	d2	d3	d4	l1 ±0.02	l3	sw	Max. static load F [kN]	⚖
GN.76003	GN 709.1-13-M6-BR	13	M6	7.2	10	13	8	11	10	12
GN.76008	GN 709.1-13-M8-BR	13	M8	7.2	10	13	8	11	10	13
GN.76013	GN 709.1-20-M8-BR	20	M8	10.5	16	18	10	17	25	37
GN.76018	GN 709.1-20-M10-BR	20	M10	10.5	16	18	10	17	25	39
GN.76023	GN 709.1-20-M12-BR	20	M12	10.5	16	18	12	17	25	42
GN.76028	GN 709.1-30-M16-BR	30	M16	20	25	27	16	27	90	150
GN.76033	GN 709.1-50-M20-BR	50	M20	34.5	40	35	20	41	165	486
GN.76038	GN 709.1-50-M24-BR	50	M24	34.5	40	35	24	41	165	517

Standard machine parts

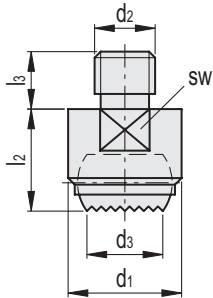
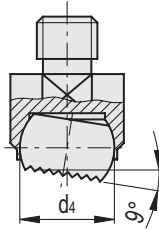
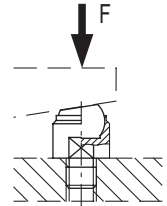
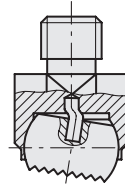
GN 709.1-R
GN 709.1-RHGN 709.1-RR
GN 709.1-RRH

GN 709.1-R

Code	Description	d1	d2	d3	d4	l2 ±0.1	l3	sw	Max. static load F [kN]	⚖️
GN.76002	GN 709.1-13-M6-R	13	M6	7.2	10	13	8	11	10	12
GN.76007	GN 709.1-13-M8-R	13	M8	7.2	10	13	8	11	10	13
GN.76012	GN 709.1-20-M8-R	20	M8	10.5	16	18	10	17	25	38
GN.76017	GN 709.1-20-M10-R	20	M10	10.5	16	18	10	17	25	20
GN.76022	GN 709.1-20-M12-R	20	M12	10.5	16	18	12	17	25	40
GN.76027	GN 709.1-30-M16-R	30	M16	20	25	27	16	27	90	150
GN.76032	GN 709.1-50-M20-R	50	M20	34.5	40	35	20	41	165	520
GN.76037	GN 709.1-50-M24-R	50	M24	34.5	40	35	24	41	165	512

GN 709.1-RR

Code	Description	d1	d2	d3	d4	l2 ±0.1	l3	sw	Max. static load F [kN]	⚖️
GN.75901	GN 709.1-13-M6-RR	13	M6	7.2	10	13	8	11	10	12
GN.75911	GN 709.1-13-M8-RR	13	M8	7.2	10	13	8	11	10	13
GN.75921	GN 709.1-20-M8-RR	20	M8	10.5	16	18	10	17	25	37
GN.75931	GN 709.1-20-M10-RR	20	M10	10.5	16	18	10	17	25	39
GN.75941	GN 709.1-20-M12-RR	20	M12	10.5	16	18	12	17	25	42
GN.75951	GN 709.1-30-M16-RR	30	M16	20	25	27	16	27	90	148
GN.75961	GN 709.1-50-M20-RR	50	M20	34.5	40	35	20	41	165	482
GN.75971	GN 709.1-50-M24-RR	50	M24	34.5	40	35	24	41	165	511

GN 709.1-RH

Code	Description	d1	d2	d3	d4	l2 ±0.1	l3	sw	Max. static load F [kN]	⚖️
GN.76004	GN 709.1-13-M6-RH	13	M6	8.3	10	13	8	11	10	14
GN.76009	GN 709.1-13-M8-RH	13	M8	8.3	10	13	8	11	10	16
GN.76014	GN 709.1-20-M8-RH	20	M8	12.8	16	18	10	17	25	49
GN.76019	GN 709.1-20-M10-RH	20	M10	12.8	16	18	10	17	25	51
GN.76024	GN 709.1-20-M12-RH	20	M12	12.8	16	18	12	17	25	54
GN.76029	GN 709.1-30-M16-RH	30	M16	20	25	27	16	27	90	188
GN.76034	GN 709.1-50-M20-RH	50	M20	34.5	40	35	20	41	165	633
GN.76039	GN 709.1-50-M24-RH	50	M24	34.5	40	35	24	41	165	662

GN 709.1-RRH

Code	Description	d1	d2	d3	d4	l2 ±0.1	l3	sw	Max. static load F [kN]	⚖️
GN.75906	GN 709.1-13-M6-RRH	13	M6	8.3	10	13	8	11	10	14
GN.75916	GN 709.1-13-M8-RRH	13	M8	8.3	10	13	8	11	10	16
GN.75926	GN 709.1-20-M8-RRH	20	M8	10.5	16	18	10	17	25	48
GN.75936	GN 709.1-20-M10-RRH	20	M10	10.5	16	18	10	17	25	50
GN.75946	GN 709.1-20-M12-RRH	20	M12	10.5	16	18	12	17	25	53
GN.75956	GN 709.1-30-M16-RRH	30	M16	20	25	27	16	27	90	190
GN.75966	GN 709.1-50-M20-RRH	50	M20	34.5	40	35	20	41	165	639
GN.75976	GN 709.1-50-M24-RRH	50	M24	34.5	40	35	24	41	165	637