

EGE-M-ED Swivel connector

Male metric thread – ED-seal (ISO 9974) / EO 24° DKO swivel

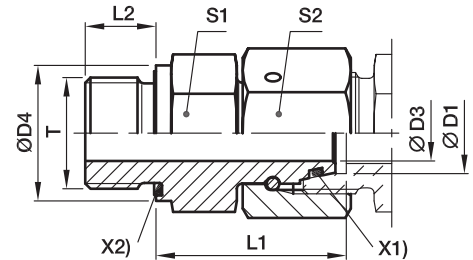

X2) Eolastic-sealing ED X1) O-ring OR

Series	D1 	T	D3	D4	L1	L2	S1	S2	Weight g/1 piece	Order code*	PN (bar) ¹⁾	
											CF	71
L ³⁾	06	M 10x1.0	2.5	14	24.5	8	14	14	27	EGE06LMED	500	315
	08	M 12x1.5	4.0	17	26.5	12	17	17	45	EGE08LMED	500	315
	10	M 14x1.5	6.0	19	27.5	12	19	19	57	EGE10LMED	500	315
	12	M 16x1.5	8.0	22	30.5	12	22	22	82	EGE12LMED	400	315
	12	M 22x1.5	8.0	27	27.0	14	27	22	92	EGE12LM22X1.5ED	400	315
	15	M 18x1.5	10.0	24	31.5	12	24	27	113	EGE15LMED	400	315
	15	M 22x1.5	10.0	27	32.0	14	27	27	142	EGE15LM22X1.5ED	400	315
	18	M 22x1.5	13.0	27	31.5	14	27	32	148	EGE18LMED	400	315
	22	M 26x1.5	17.0	32	32.5	16	32	36	203	EGE22LMED	250	160
	28	M 33x2.0	22.0	40	35.0	18	41	41	289	EGE28LMED	250	160
S ⁴⁾	35	M 42x2.0	28.0	50	42.5	20	50	50	511	EGE35LMED	250	160
	42	M 48x2.0	34.0	55	46.5	22	55	60	711	EGE42LMED	250	160
	06	M 12x1.5	2.5	17	27.0	12	17	17	47	EGE06SMED	800	630
	08	M 14x1.5	4.0	19	29.5	12	19	19	65	EGE08SMED	800	630
	10	M 16x1.5	6.0	22	32.0	12	22	22	91	EGE10SMED	800	630
	12	M 18x1.5	8.0	24	34.0	12	24	24	112	EGE12SMED	630	630
	14	M 20x1.5	9.0	26	36.5	14	27	27	153	EGE14SMED	630	630
	16	M 22x1.5	11.0	27	37.0	14	27	30	174	EGE16SMED	630	400
	20	M 27x2.0	14.0	32	43.0	16	32	36	274	EGE20SMED	420	400
	25	M 33x2.0	18.0	40	48.0	18	41	46	497	EGE25SMED	420	400
30	M 42x2.0	23.0	50	51.0	20	50	50	691	EGE30SMED	420	400	
38	M 48x2.0	30.0	55	60.0	22	55	60	957	EGE38SMED	420	315	

¹⁾ Pressure shown = item deliverable

³⁾ L = light series; ⁴⁾ S = heavy series

$$\frac{\text{PN (bar)}}{10} = \text{PN (MPa)}$$

Information on ordering alternative sealing materials see page 17.

*Please add the **suffixes** below according to the material/surface required

Order code suffixes			
Material	Suffix surface and material	Example	Standard sealing material (no additional suffix needed)
Steel, zinc plated, Cr(VI)-free	CF	EGE16SMEDCF	NBR
Stainless Steel	71	EGE16SMED71	VIT