

panel cutting

panel thickness = max. 3.5mm
no limit with pre-assembled
RJ45 Adapter

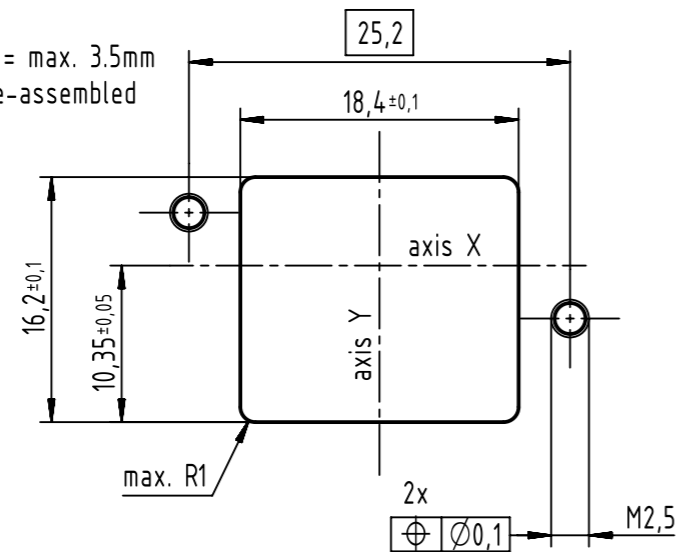

connector pitch on panel:
axis X = 27mm and axis Y = 21mm

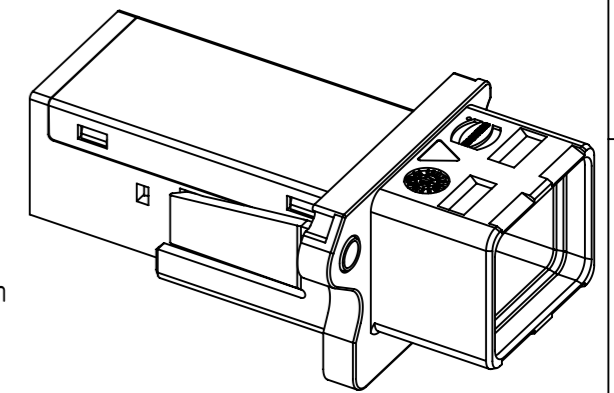
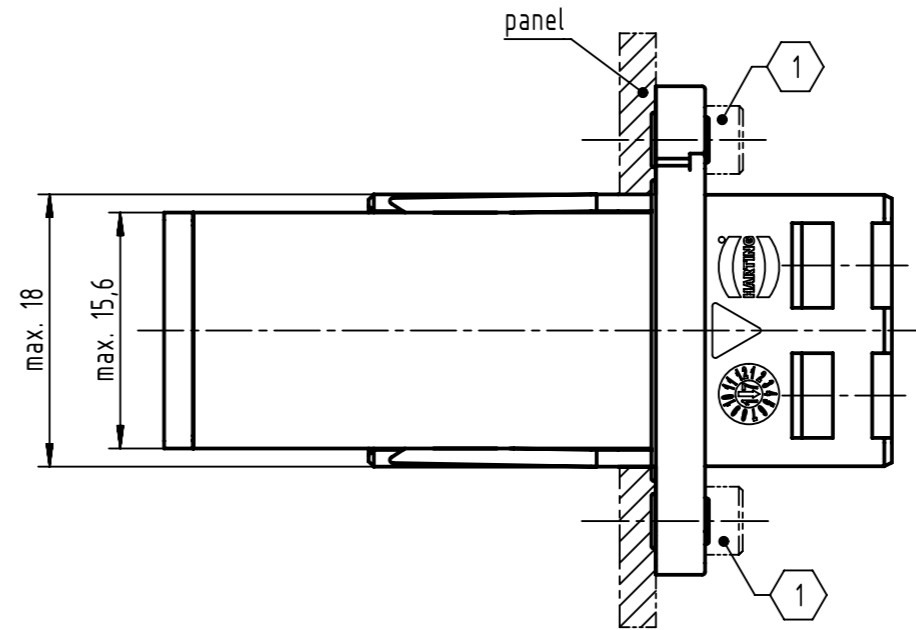
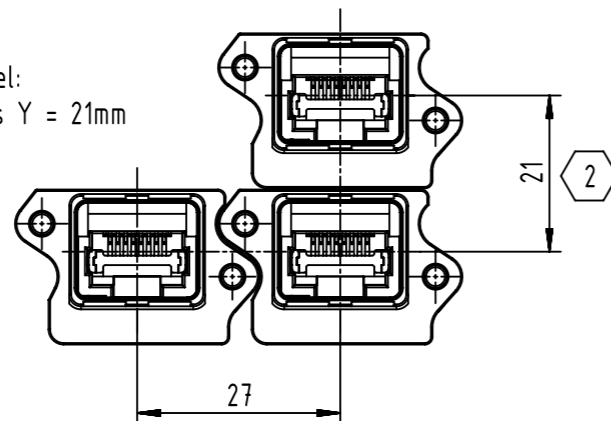

2 connector pitch with coding clip 0945840002X Y = 23mm

1 2x M2.5; screws acc. to ISO 4762;
please order separately; bolting torque 0.3Nm - 0.5Nm

further information see product data sheet

	All Dimensions in mm Original Size DIN A3	Scale 2:1	Free size tol.	Ref.	
				Sub.	
	All rights reserved Department EL PD	Created by STORCK	Inspected by ZWÄHR	Standardisation HOFFMANN	Date 2019-12-17
					State Final Release
HARTING Electronics GmbH D-32339 Espelkamp		Title HARTING PushPull V4 Compact Housing with RJ45		Doc-Key / ECM-Nr. 100671787/UGD/000/D 500000161747	
		Type TB	Number 09452451561	Rev. D	Page 1/1